

2010 NINJA® ZX™-10R PARTS DIAGRAM

Air Cleaner

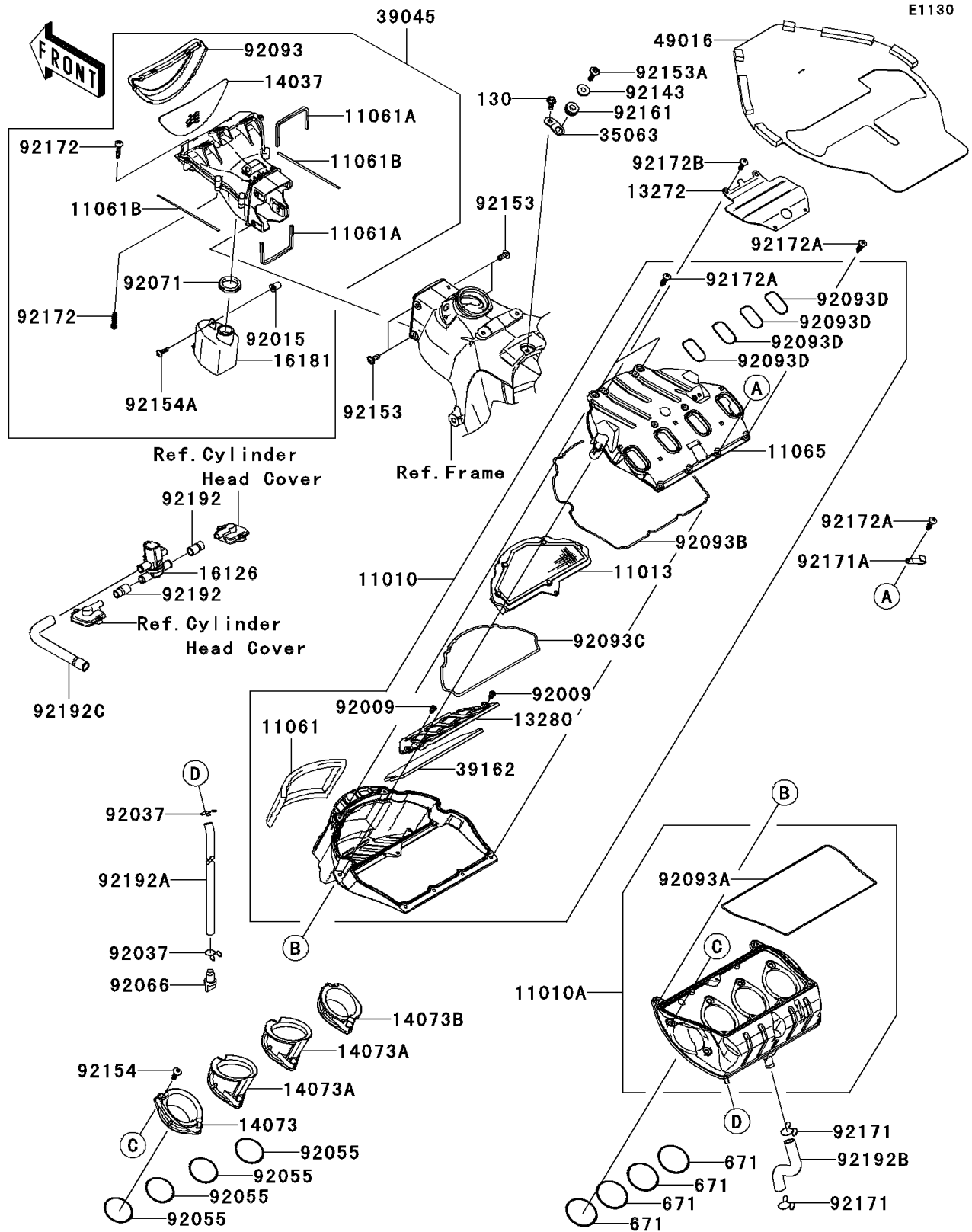

2010 NINJA® ZX™-10R PARTS LIST

Air Cleaner

ITEM NAME	PART NUMBER	QUANTITY
FILTER-ASSY-AIR,UPP (Ref # 11010)	11010-0138	1
FILTER-ASSY-AIR,LWR (Ref # 11010A)	11010-0170	1
ELEMENT-AIR FILTER (Ref # 11013)	11013-0026	1
GASKET (Ref # 11061)	11061-0309	1
GASKET (Ref # 11061A)	11061-0315	1
GASKET (Ref # 11061B)	11061-0316	1
CAP (Ref # 11065)	11065-0225	1
PLATE (Ref # 13272)	13272-0521	1
HOLDER,SILENCER (Ref # 13280)	13280-0272	1
SCREEN (Ref # 14037)	14037-0077	1
DUCT,FUNNEL,#1 (Ref # 14073)	14073-0231	1
DUCT,FUNNEL,#2 (Ref # 14073A)	14073-0232	1
DUCT,FUNNEL,#4 (Ref # 14073B)	14073-0233	1
VALVE,AIR SWITCHING (Ref # 16126)	16126-0038	1
TANK-RESONATOR (Ref # 16181)	16181-0013	1
STAY (Ref # 35063)	35063-0447	1
DUCT-ASSY,RAM (Ref # 39045)	39045-0036	1
SILENCER-INTAKE (Ref # 39162)	39162-0006	1
COVER-SEAL (Ref # 49016)	49016-0059	1
SCREW,TAPPING,5X10 (Ref # 92009)	92009-1499	1
NUT,WELL,5MM (Ref # 92015)	92015-1757	1
CLAMP,TUBE (Ref # 92037)	92037-147	1
RING-O (Ref # 92055)	92055-0156	1
PLUG,DRAIN (Ref # 92066)	92066-1211	1
GROMMET (Ref # 92071)	92071-1137	1
SEAL (Ref # 92093)	92093-0098	1
SEAL,3X805 (Ref # 92093A)	92093-0108	1
SEAL,3X925 (Ref # 92093B)	92093-0109	1
SEAL,3X570 (Ref # 92093C)	92093-0110	1

2010 NINJA® ZX™-10R PARTS LIST

Air Cleaner

ITEM NAME	PART NUMBER	QUANTITY
SEAL,3X152 (Ref # 92093D)	92093-0111	1
COLLAR (Ref # 92143)	92143-1962	1
BOLT,6X18 (Ref # 92153)	92153-0875	1
BOLT,SOCKET,6X22 (Ref # 92153A)	92153-1356	1
BOLT,SOCKET,5X17.7 (Ref # 92154)	92154-0105	1
BOLT,SOCKET,5X16 (Ref # 92154A)	92154-0209	1
DAMPER (Ref # 92161)	92161-0154	1
CLAMP (Ref # 92171)	92171-0391	1
CLAMP (Ref # 92171A)	92171-1539	1
SCREW-PAN-CROS,5X25 (Ref # 92172)	92172-0056	1
SCREW,TAPPING,5X25 (Ref # 92172A)	92172-0337	1
BOLT-FLANGED,6X14 (Ref # 130)	130AA0614	1
O RING (Ref # 671)	671E2565	1
SCREW,TAPPING,5X20 (Ref # 92172B)	92172-0382	1
TUBE,HEAD-ASV (Ref # 92192)	92192-0033	1
TUBE,7X10X500 (Ref # 92192A)	92192-0156	1
TUBE,BREATHING (Ref # 92192B)	92192-0237	1
TUBE,ASV-A/C (Ref # 92192C)	92192-0527	1