

## 2012 Brute Force® 750 4x4i EPS PARTS DIAGRAM

Drive Shaft-Rear

E3137

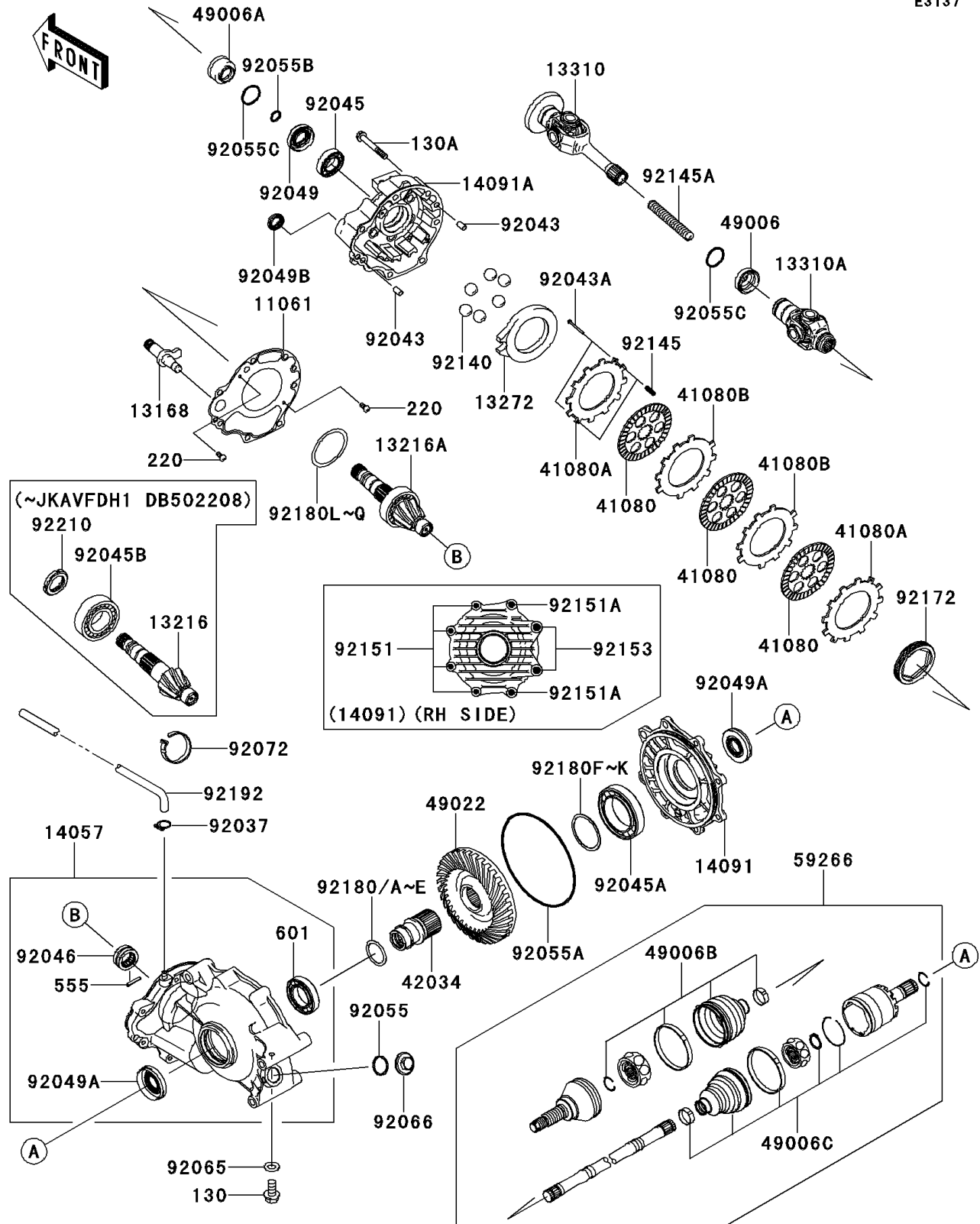

## 2012 Brute Force® 750 4x4i EPS PARTS LIST

Drive Shaft-Rear

ITEM NAME	PART NUMBER	QUANTITY
GASKET,SOFT METAL (Ref # 11061)	11061-0059	1
LEVER,BRAKE (Ref # 13168)	13168-0042	1
GEAR-COMP (Ref # 13216)	13216-0047	1
PLATE (Ref # 13272)	13272-1083	1
SHAFT-ASSY,ENGINE SIDE (Ref # 13310)	13310-0028	1
SHAFT-ASSY,GEAR-ASSY SIDE (Ref # 13310A)	13310-0558	1
CASE-COMP-GEAR (Ref # 14057)	14057-0010	1
COVER,RH (Ref # 14091)	14091-0142	1
COVER,FR (Ref # 14091A)	14091-0143	1
DISC,FRICTION (Ref # 41080)	41080-1482	1
DISC,PRESSURE (Ref # 41080A)	41080-1483	1
DISC,SEPARATER (Ref # 41080B)	41080-1484	1
COUPLING (Ref # 42034)	42034-0006	1
BOOT (Ref # 49006)	49006-0007	1
BOOT (Ref # 49006A)	49006-0008	1
BOOT,UJ (Ref # 49006B)	49006-0064	1
BOOT,DOJ (Ref # 49006C)	49006-0065	1
GEAR-BEVEL,35T (Ref # 49022)	49022-0563	1
JOINT-BALL (Ref # 59266)	59266-0023	1
CLAMP,HOSE (Ref # 92037)	92037-1104	1
PIN,8X14 (Ref # 92043)	92043-1567	1
PIN,3X35 (Ref # 92043A)	92043-1617	1
BEARING-BALL,#6005 (Ref # 92045)	92045-0077	1
BEARING-BALL,55X90X18 (Ref # 92045A)	92045-0078	1
BEARING-BALL,BX30-1C3 UR3 (Ref # 92045B)	92045-0099	1
BEARING-NEEDLE,AH502504A (Ref # 92046)	92046-1280	1
SEAL-OIL,HTGY 24X45X9.5 (Ref # 92049)	92049-0028	1
SEAL-OIL,SDD7 25X57X7 HS (Ref # 92049A)	92049-0029	1
SEAL-OIL,TC17X28X6 (Ref # 92049B)	92049-1537	1

## 2012 Brute Force® 750 4x4i EPS PARTS LIST

Drive Shaft-Rear

ITEM NAME	PART NUMBER	QUANTITY
RING-0 (Ref # 92055)	92055-0122	1
RING-0,158.5X3.70 (Ref # 92055A)	92055-1631	1
RING-0,18X24X3 (Ref # 92055B)	92055-1633	1
RING-0,30X35X2.5 (Ref # 92055C)	92055-1693	1
BOLT-FLANGED,8X16 (Ref # 130)	130BA0816	1
BOLT-FLANGED,8X60 (Ref # 130A)	130CA0860	1
SCREW-PAN-CROS,4X8 (Ref # 220)	220AA0408	1
PIN-SPRING (Ref # 555)	555A0428	1
BEARING-BALL,#6007 (Ref # 601)	601A6007	1
GASKET (Ref # 92065)	92065-023	1
PLUG (Ref # 92066)	92066-1303	1
BAND,L=186 (Ref # 92072)	92072-056	1
BALL,D/O#12 (Ref # 92140)	92140-1064	1
SPRING,RR BRAKE (Ref # 92145)	92145-1301	1
SPRING,PROPELLER SHAFT (Ref # 92145A)	92145-1304	1
BOLT,8X30 (Ref # 92151)	92151-1908	1
BOLT,10X35 (Ref # 92151A)	92151-1909	1
BOLT,12X35 (Ref # 92153)	92153-0311	1
SCREW,SET,76X12 (Ref # 92172)	92172-0718	1
SHIM,35.2X44.0X1.2 (Ref # 92180)	92180-0161	1
SHIM,35.2X44.0X1.0 (Ref # 92180A)	92180-0162	1
SHIM,35.2X44.0X0.8 (Ref # 92180B)	92180-0163	1
SHIM,35.2X44.0X0.5 (Ref # 92180C)	92180-0164	1
SHIM,35.2X44.0X0.2 (Ref # 92180D)	92180-0165	1
SHIM,35.2X44.0X0.15 (Ref # 92180E)	92180-0166	1
SHIM,55X64X0.15 (Ref # 92180F)	92180-1417	1
SHIM,55X64X0.20 (Ref # 92180G)	92180-1418	1
SHIM,55X64X0.50 (Ref # 92180H)	92180-1419	1
SHIM,55X64X0.80 (Ref # 92180I)	92180-1420	1

## 2012 Brute Force® 750 4x4i EPS PARTS LIST

Drive Shaft-Rear

ITEM NAME	PART NUMBER	QUANTITY
SHIM,55X64X1.00 (Ref # 92180J)	92180-1421	1
SHIM,55X64X1.20 (Ref # 92180K)	92180-1422	1
SHIM,60X72X0.15 (Ref # 92180L)	92180-1423	1
SHIM,60X72X0.20 (Ref # 92180M)	92180-1424	1
SHIM,60X72X0.50 (Ref # 92180N)	92180-1425	1
SHIM,60X72X0.80 (Ref # 92180O)	92180-1426	1
SHIM,60X72X1.00 (Ref # 92180P)	92180-1427	1
SHIM,60X72X1.20 (Ref # 92180Q)	92180-1428	1
TUBE,BREATHER,L=1680MM (Ref # 92192)	92192-0210	1
NUT,30MM (Ref # 92210)	92210-1294	1