

2009 MULE™ 4010 4x4 Hardwoods Green HD® PARTS DIAGRAM

Chassis Electrical Equipment

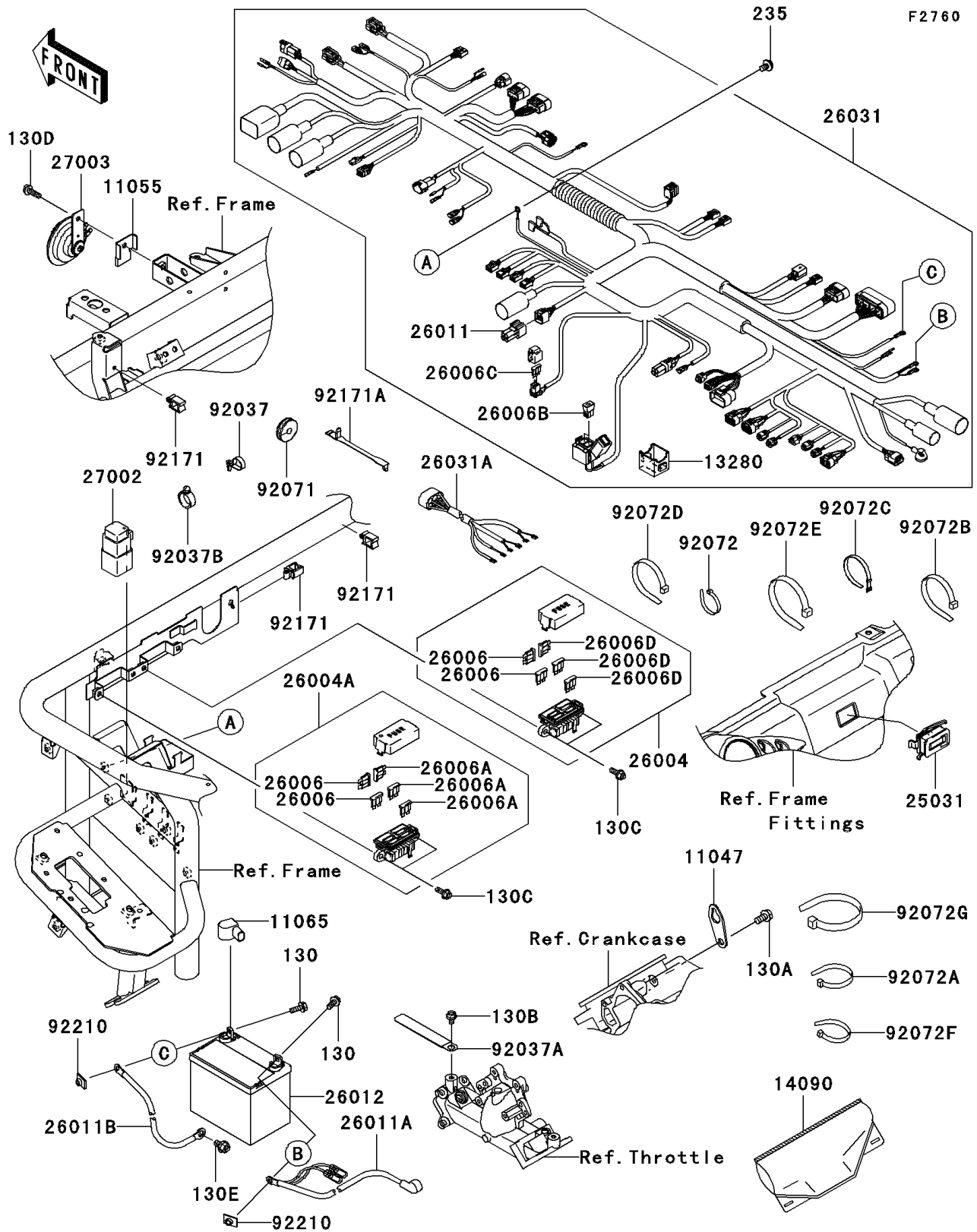

2009 MULE™ 4010 4x4 Hardwoods Green HD® PARTS LIST

Chassis Electrical Equipment

| ITEM NAME | PART NUMBER | QUANTITY |
|-------------------------------------|---------------|----------|
| BRACKET,F.BLACK (Ref # 11047) | 11047-2056-9H | 1 |
| BRACKET,HORN (Ref # 11055) | 11055-0167 | 1 |
| CAP,BATTERY TERMINAL (Ref # 11065) | 11065-0285 | 1 |
| HOLDER (Ref # 13280) | 13280-7508 | 1 |
| COVER,COUPLER (Ref # 14090) | 14090-1611 | 1 |
| METER-ASSY,HOUR (Ref # 25031) | 25031-7506 | 1 |
| FUSE-ASSY (Ref # 26004) | 26004-0018 | 1 |
| FUSE-ASSY (Ref # 26004A) | 26004-0019 | 1 |
| FUSE,30A (Ref # 26006) | 26006-0004 | 1 |
| FUSE,10A (Ref # 26006A) | 26006-0005 | 1 |
| FUSE,40A (Ref # 26006B) | 26006-0014 | 1 |
| FUSE,7.5A (Ref # 26006C) | 26006-0015 | 1 |
| FUSE,20A-Y (Ref # 26006D) | 26006-1051 | 1 |
| WIRE-LEAD (Ref # 26011) | 26011-0037 | 1 |
| WIRE-LEAD,BATTERY(+) (Ref # 26011A) | 26011-0224 | 1 |
| WIRE-LEAD,BATTERY(-) (Ref # 26011B) | 26011-1787 | 1 |
| BATTERY,12V 14AH (Ref # 26012) | 26012-0107 | 1 |
| HARNESS,MAIN (Ref # 26031) | 26031-0642 | 1 |
| HARNESS (Ref # 26031A) | 26031-2080 | 1 |
| RELAY-ASSY (Ref # 27002) | 27002-1068 | 1 |
| HORN (Ref # 27003) | 27003-1330 | 1 |
| CLAMP,SPEED,L=58 (Ref # 92037) | 92037-1163 | 1 |
| CLAMP,HARNESS,L=100 (Ref # 92037A) | 92037-1636 | 1 |
| CLAMP,HOSE (Ref # 92037B) | 92037-1827 | 1 |
| GROMMET (Ref # 92071) | 92071-1136 | 1 |
| BAND,L=123 (Ref # 92072) | 92072-030 | 1 |
| BAND,L=149 (Ref # 92072A) | 92072-031 | 1 |
| BAND,L=218 (Ref # 92072B) | 92072-032 | 1 |
| BAND,L=186 (Ref # 92072C) | 92072-056 | 1 |

2009 MULE™ 4010 4x4 Hardwoods Green HD® PARTS LIST

Chassis Electrical Equipment

| ITEM NAME | PART NUMBER | QUANTITY |
|------------------------------------|-------------|----------|
| BAND,L=202 (Ref # 92072D) | 92072-1195 | 1 |
| BAND,L=250 (Ref # 92072E) | 92072-1237 | 1 |
| BAND,L=188 (Ref # 92072F) | 92072-1239 | 1 |
| BAND,L=368.3 (Ref # 92072G) | 92072-3872 | 1 |
| CLAMP (Ref # 92171) | 92171-0290 | 1 |
| CLAMP (Ref # 92171A) | 92171-1365 | 1 |
| NUT,PLATE,6MM (Ref # 92210) | 92210-1352 | 1 |
| BOLT-FLANGED,6X16 (Ref # 130) | 130BA0616 | 1 |
| BOLT-FLANGED,8X16 (Ref # 130A) | 130BA0816 | 1 |
| BOLT-FLANGED,6X10 (Ref # 130B) | 130BB0610 | 1 |
| BOLT-FLANGED,6X16 (Ref # 130C) | 130BB0616 | 1 |
| BOLT-FLANGED,6X20 (Ref # 130D) | 130BB0620 | 1 |
| BOLT-FLANGED,8X12 (Ref # 130E) | 130BB0812 | 1 |
| SCREW-PAN-WP-CROS,6X10 (Ref # 235) | 235AA0610 | 1 |