

2009 Vulcan® 1700 Nomad™ PARTS DIAGRAM

Gear Change Mechanism

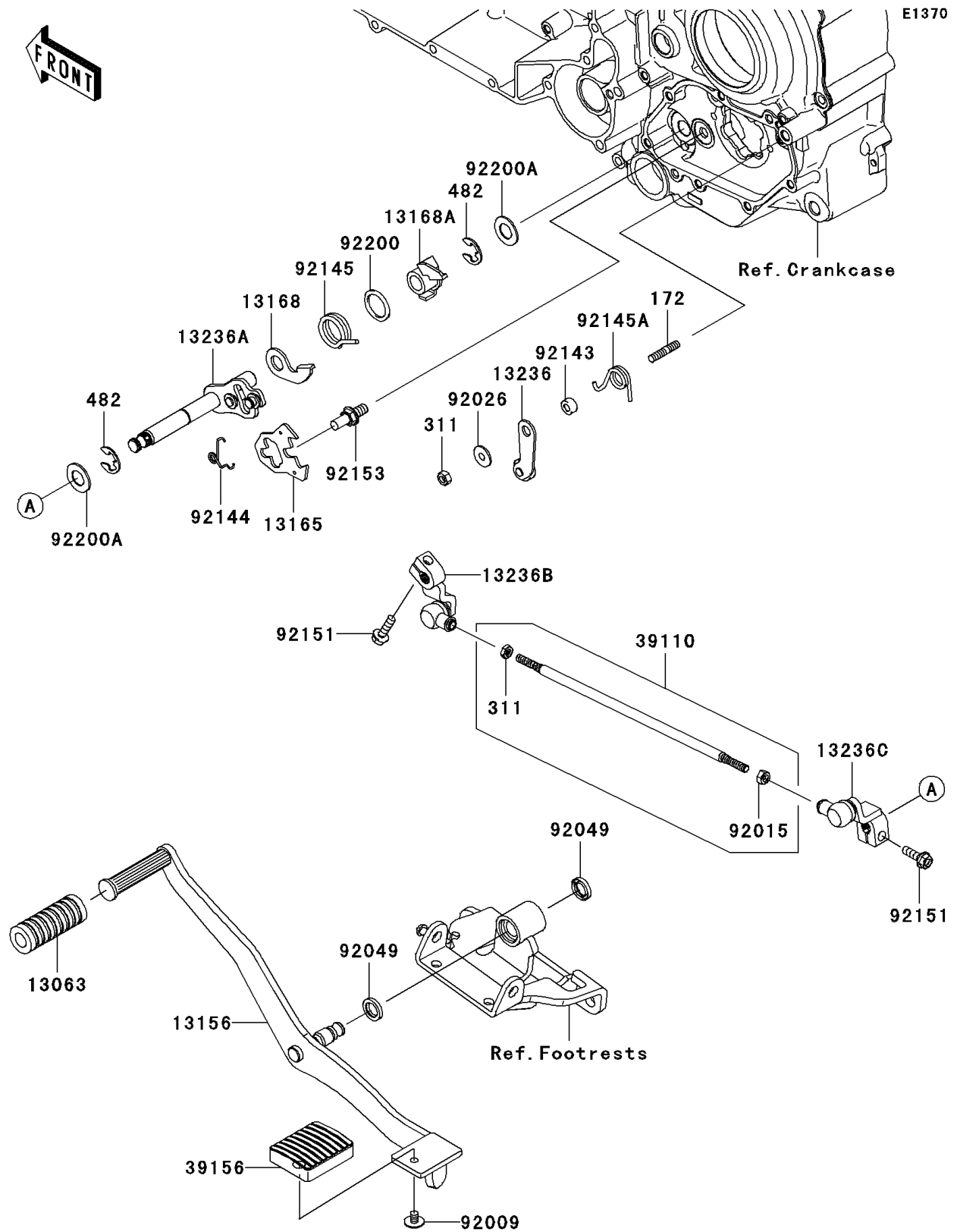

2009 Vulcan® 1700 Nomad™ PARTS LIST

Gear Change Mechanism

| ITEM NAME | PART NUMBER | QUANTITY |
|--------------------------------------|-------------|----------|
| BOLT-STUD,6X18 (Ref # 172) | 172BA0618 | 1 |
| NUT-HEX (Ref # 311) | 311BA0600 | 1 |
| CIRCLIP-TYPE-E,12MM (Ref # 482) | 482J0200 | 1 |
| DAMPER,PEDAL (Ref # 13063) | 13063-002 | 1 |
| LEVER-CHANGE (Ref # 13156) | 13156-0138 | 1 |
| PAWL (Ref # 13165) | 13165-0001 | 1 |
| LEVER (Ref # 13168) | 13168-0009 | 1 |
| LEVER (Ref # 13168A) | 13168-0010 | 1 |
| LEVER-COMP,POSITION (Ref # 13236) | 13236-0059 | 1 |
| LEVER-COMP,CHANGE (Ref # 13236A) | 13236-0153 | 1 |
| LEVER-COMP,FR LINKAGE (Ref # 13236B) | 13236-0154 | 1 |
| LEVER-COMP,RR LINKAGE (Ref # 13236C) | 13236-0155 | 1 |
| ROD-ASSY-TIE (Ref # 39110) | 39110-0029 | 1 |
| PAD (Ref # 39156) | 39156-1641 | 1 |
| SCREW,6X8 (Ref # 92009) | 92009-1677 | 1 |
| NUT,LEFT HANDED,6MM (Ref # 92015) | 92015-1125 | 1 |
| SPACER (Ref # 92026) | 92026-1217 | 1 |
| SEAL-OIL,VB13193 (Ref # 92049) | 92049-1398 | 1 |
| COLLAR (Ref # 92143) | 92143-1595 | 1 |
| SPRING (Ref # 92144) | 92144-1029 | 1 |
| SPRING,24X3.2 (Ref # 92145) | 92145-0661 | 1 |
| SPRING,16X3 (Ref # 92145A) | 92145-0718 | 1 |
| BOLT,FLANGED,6X20 (Ref # 92151) | 92151-1226 | 1 |
| BOLT,RETURN SPRING (Ref # 92153) | 92153-0421 | 1 |
| WASHER,20.5X27X1.6 (Ref # 92200) | 92200-0018 | 1 |
| WASHER,13.4X25X1.6 (Ref # 92200A) | 92200-0477 | 1 |