

2009 Vulcan® 1700 Nomad™ PARTS DIAGRAM

Transmission

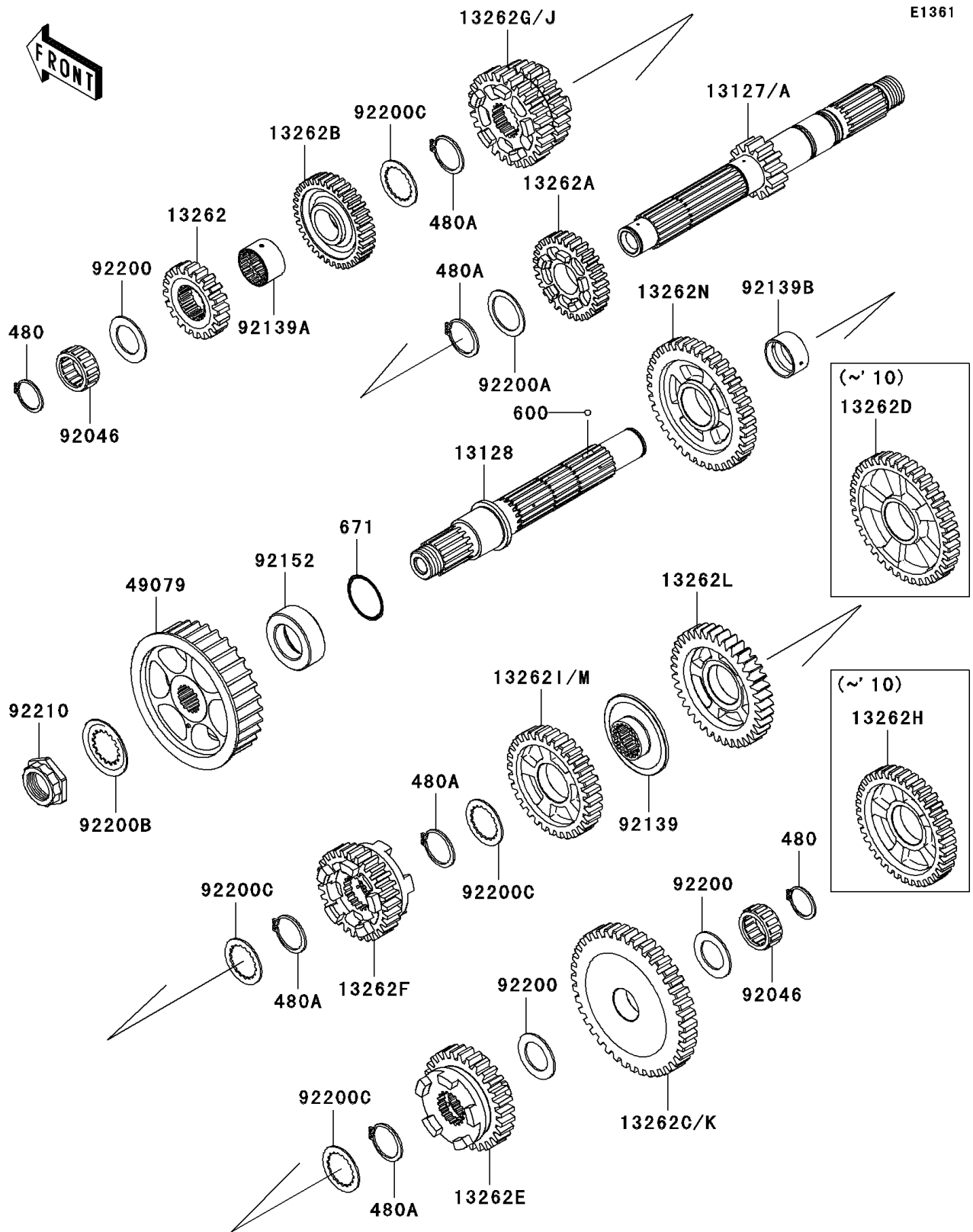

2009 Vulcan® 1700 Nomad™ PARTS LIST

Transmission

ITEM NAME	PART NUMBER	QUANTITY
CIRCLIP-TYPE-C,25MM (Ref # 480)	480J2500	1
CIRCLIP (Ref # 480A)	480J2900	1
BALL-STEEL,5/32" (Ref # 600)	600A0500	1
O RING (Ref # 671)	671D2535	1
SHAFT-TRANSMISSION INPUT (Ref # 13127)	13127-0059	1
SHAFT-TRANSMISSION OUTPUT (Ref # 13128)	13128-0057	1
GEAR,INPUT 2ND,20T (Ref # 13262)	13262-0603	1
GEAR,INPUT 5TH,30T (Ref # 13262A)	13262-0605	1
GEAR,INPUT 6TH,36T (Ref # 13262B)	13262-0606	1
GEAR,OUTPUT LOW,40T (Ref # 13262C)	13262-0607	1
GEAR,OUTPUT 2ND,38T (Ref # 13262D)	13262-0608	1
GEAR,OUTPUT 5TH,29T (Ref # 13262E)	13262-0611	1
GEAR,OUTPUT 6TH,29T (Ref # 13262F)	13262-0612	1
GEAR,INPUT 3RD&4TH,27T&28T (Ref # 13262G)	13262-0739	1
GEAR,OUTPUT 3RD,38T (Ref # 13262H)	13262-0740	1
GEAR,OUTPUT 4TH,32T (Ref # 13262I)	13262-0741	1
PULLEY-BELT (Ref # 49079)	49079-0020	1
BEARING-NEEDLE,KT 253515E02 C3 (Ref # 92046)	92046-0007	1
BUSHING,OUTPUT 3RD-4TH GEAR (Ref # 92139)	92139-0007	1
BUSHING,INPUT TOP GEAR (Ref # 92139A)	92139-0236	1
BUSHING,OUTPUT 2ND GEAR (Ref # 92139B)	92139-0237	1
COLLAR,30X50X17.5 (Ref # 92152)	92152-0657	1
WASHER,25.3X40X1.6 (Ref # 92200)	92200-0427	1
WASHER,30.3X40X1.5 (Ref # 92200A)	92200-0428	1
WASHER,31X50X1 (Ref # 92200B)	92200-0505	1
WASHER,30.3X40X1.5 (Ref # 92200C)	92200-1381	1
NUT,25MM (Ref # 92210)	92210-0554	1