

1987 PARTS DIAGRAM

Carrier

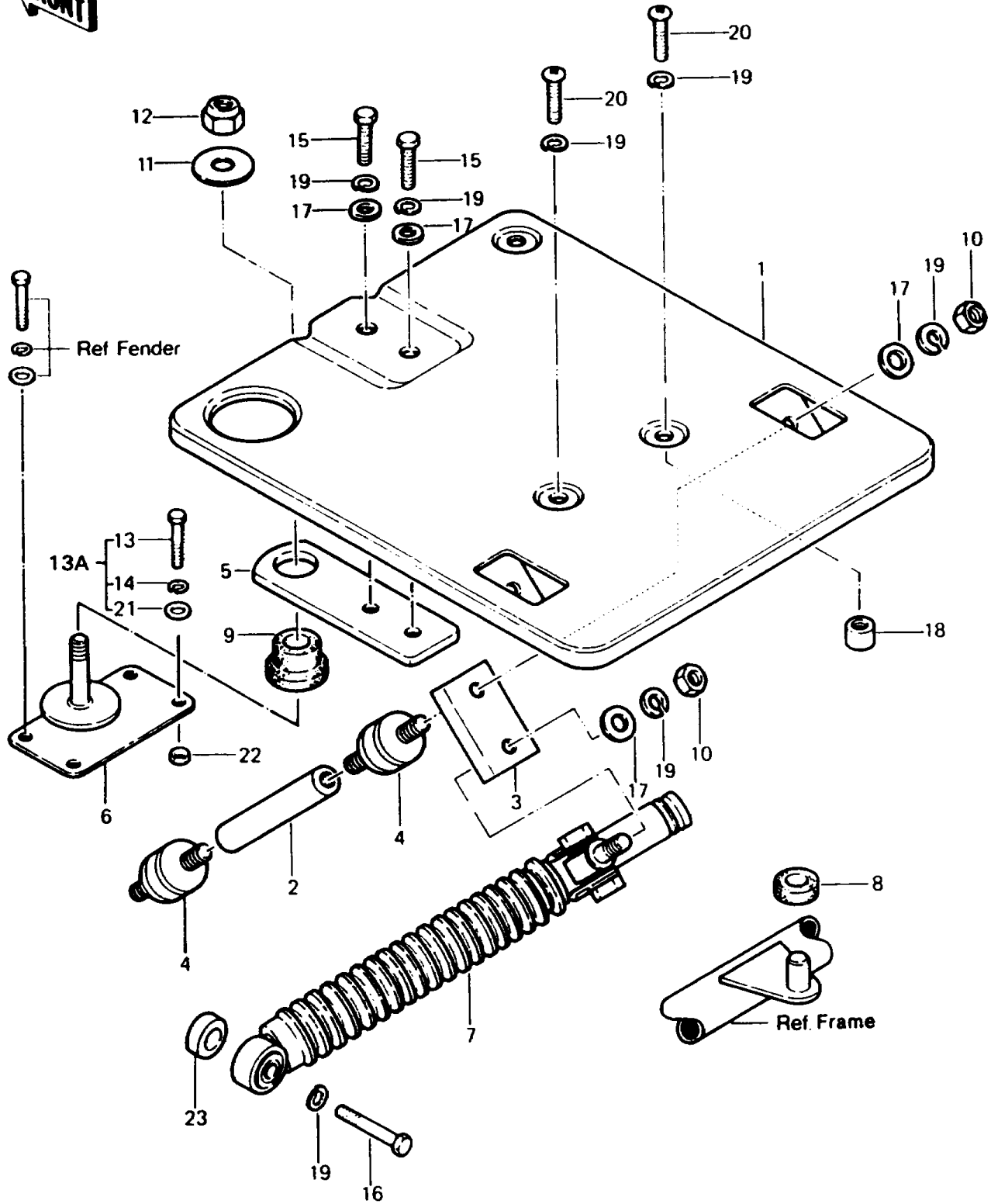

1987 PARTS LIST

Carrier

| ITEM NAME | PART NUMBER | QUANTITY |
|---------------------------------------|-------------|----------|
| NUT-HEX-SMALL,8MM (Ref # 10) | 317B0800 | 1 |
| WASHER (Ref # 11) | 92022-4002 | 1 |
| NUT,LOCK,12MM (Ref # 12) | 92019-009 | 1 |
| BOLT-UPSET-WSP (Ref # 13A) | 187B0622 | 1 |
| BOLT,6X22 (Ref # 13) | 110B0622 | 1 |
| WASHER-SPRING,6MM (Ref # 14) | 461F0600 | 1 |
| BOLT-SMALL-UPSET (Ref # 15) | 115B0816 | 1 |
| BOLT-SMALL-UPSET (Ref # 16) | 115B0835 | 1 |
| WASHER-PLAIN,8MM (Ref # 17) | 411B0800 | 1 |
| BOSS,CARRIER SPACER (Ref # 18) | 13061-4005 | 1 |
| WASHER-SPRING,8MM (Ref # 19) | 461F0800 | 1 |
| SCREW-PAN-CROS,8X14 (Ref # 20) | 220B0814 | 1 |
| WASHER-PLAIN,6MM (Ref # 21) | 411B0600 | 1 |
| NUT,FLANGED,6MM (Ref # 22) | 92015-1078 | 1 |
| SPACER (Ref # 23) | 92026-4003 | 1 |
| CARRIER (Ref # 1) | 53029-4002 | 1 |
| ARM,CARRIER DAMPER (Ref # 2) | 21083-4006 | 1 |
| BRACKET,CARRIER SIDE DAMPER (Ref # 3) | 11034-4103 | 1 |
| DAMPER,CARRIER (Ref # 4) | 92075-4040 | 1 |
| BRACKET,CARRIER,FR (Ref # 5) | 11034-4034 | 1 |
| BRACKET,FR CARRIER DAMPER (Ref # 6) | 11034-4159 | 1 |
| SHOCKABSORBER,RR (Ref # 7) | 45014-4005 | 1 |
| DAMPER (Ref # 8) | 92075-203 | 1 |
| DAMPER,CARRIER (Ref # 9) | 92075-4006 | 1 |