

## 2005 Prairie® 700 4x4 Team Green™ Special Edition PARTS DIAGRAM

Cylinder Head

E1111

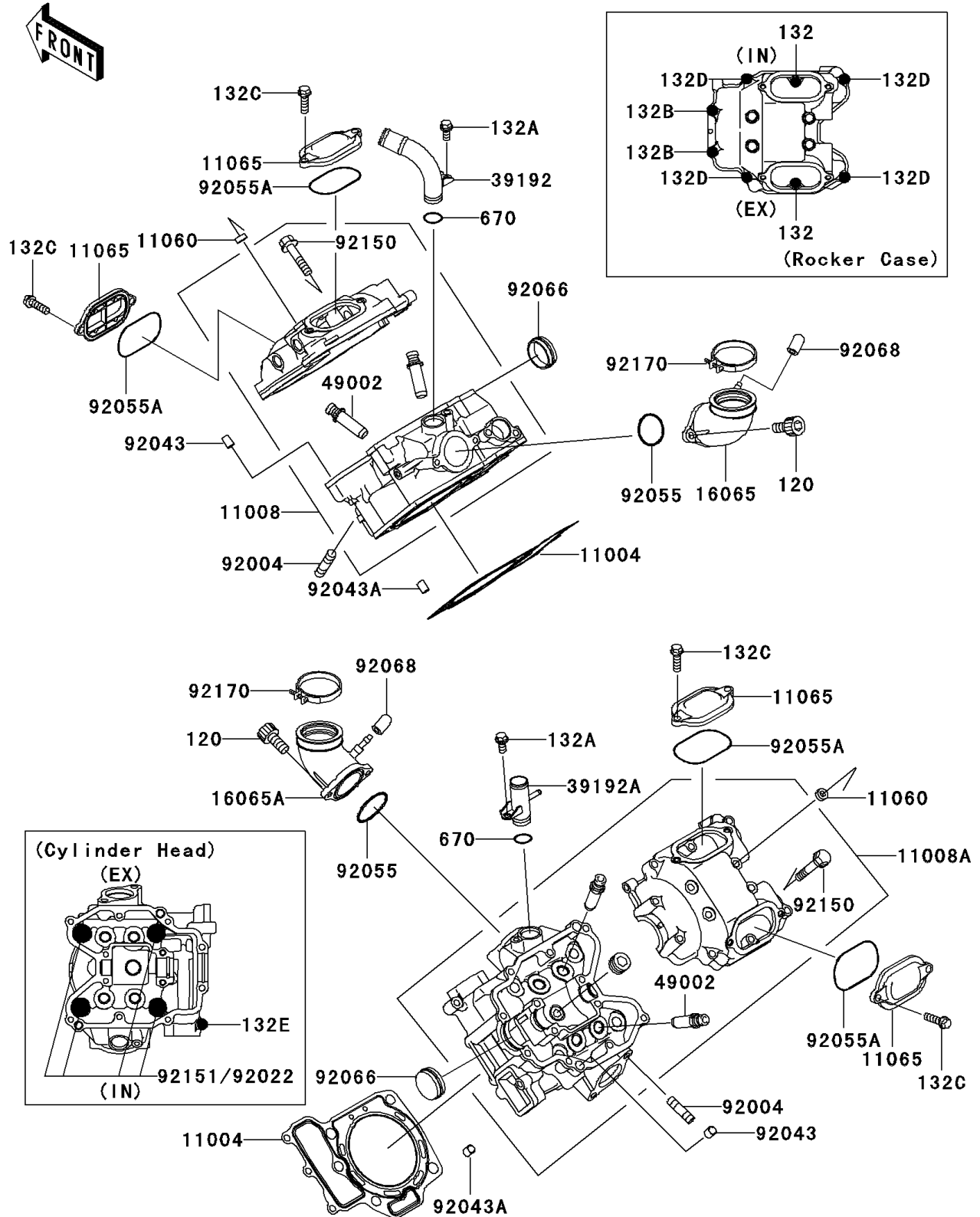

## 2005 Prairie® 700 4x4 Team Green™ Special Edition PARTS LIST

Cylinder Head

| ITEM NAME                             | PART NUMBER | QUANTITY |
|---------------------------------------|-------------|----------|
| BOLT-SOCKET,6X20 (Ref # 120)          | 120Z0620    | 1        |
| BOLT-FLANGED-SMALL,6X25 (Ref # 132)   | 132H0625    | 1        |
| BOLT-FLANGED-SMALL,6X12 (Ref # 132A)  | 132Y0612    | 1        |
| BOLT-FLANGED-SMALL,6X130 (Ref # 132B) | 132Y06130   | 1        |
| BOLT-FLANGED-SMALL,6X20 (Ref # 132C)  | 132Y0620    | 1        |
| BOLT-FLANGED-SMALL,6X30 (Ref # 132D)  | 132Y0630    | 1        |
| BOLT-FLANGED-SMALL,6X95 (Ref # 132E)  | 132Y0695    | 1        |
| O RING,16MM (Ref # 670)               | 670B2016    | 1        |
| GASKET-HEAD (Ref # 11004)             | 11004-0050  | 1        |
| HEAD-COMP-CYLINDER,FR (Ref # 11008)   | 11008-0030  | 1        |
| HEAD-COMP-CYLINDER,RR (Ref # 11008A)  | 11008-0031  | 1        |
| GASKET,6.2X12X0.3 (Ref # 11060)       | 11060-1994  | 1        |
| CAP,ROCKER CASE (Ref # 11065)         | 11065-1152  | 1        |
| HOLDER-CARBURETOR (Ref # 16065)       | 16065-1370  | 1        |
| HOLDER-CARBURETOR,RR (Ref # 16065A)   | 16065-1371  | 1        |
| PIPE-WATER (Ref # 39192)              | 39192-1132  | 1        |
| PIPE-WATER (Ref # 39192A)             | 39192-1133  | 1        |
| GUIDE-VALVE (Ref # 49002)             | 49002-1097  | 1        |
| STUD,8X22 (Ref # 92004)               | 92004-1217  | 1        |
| WASHER,11.5X20.5X1.6 (Ref # 92022)    | 92022-1720  | 1        |
| PIN,6.2X8X14 (Ref # 92043)            | 92043-1263  | 1        |
| PIN,10.1X12X14 (Ref # 92043A)         | 92043-4009  | 1        |
| RING-O,38X1.9 (Ref # 92055)           | 92055-1295  | 1        |
| RING-O,55.6X2.4 (Ref # 92055A)        | 92055-1644  | 1        |
| PLUG (Ref # 92066)                    | 92066-1289  | 1        |
| PLUG,12X25 (Ref # 92068)              | 92068-006   | 1        |
| BOLT,FLANGED,6X55 (Ref # 92150)       | 92150-1302  | 1        |
| BOLT,FLANGED,10X150 (Ref # 92151)     | 92151-1917  | 1        |
| CLAMP (Ref # 92170)                   | 92170-1722  | 1        |