

2016 NINJA® ZX™-6R ABS PARTS DIAGRAM

Cowling Lowers(FGF/FGFA)

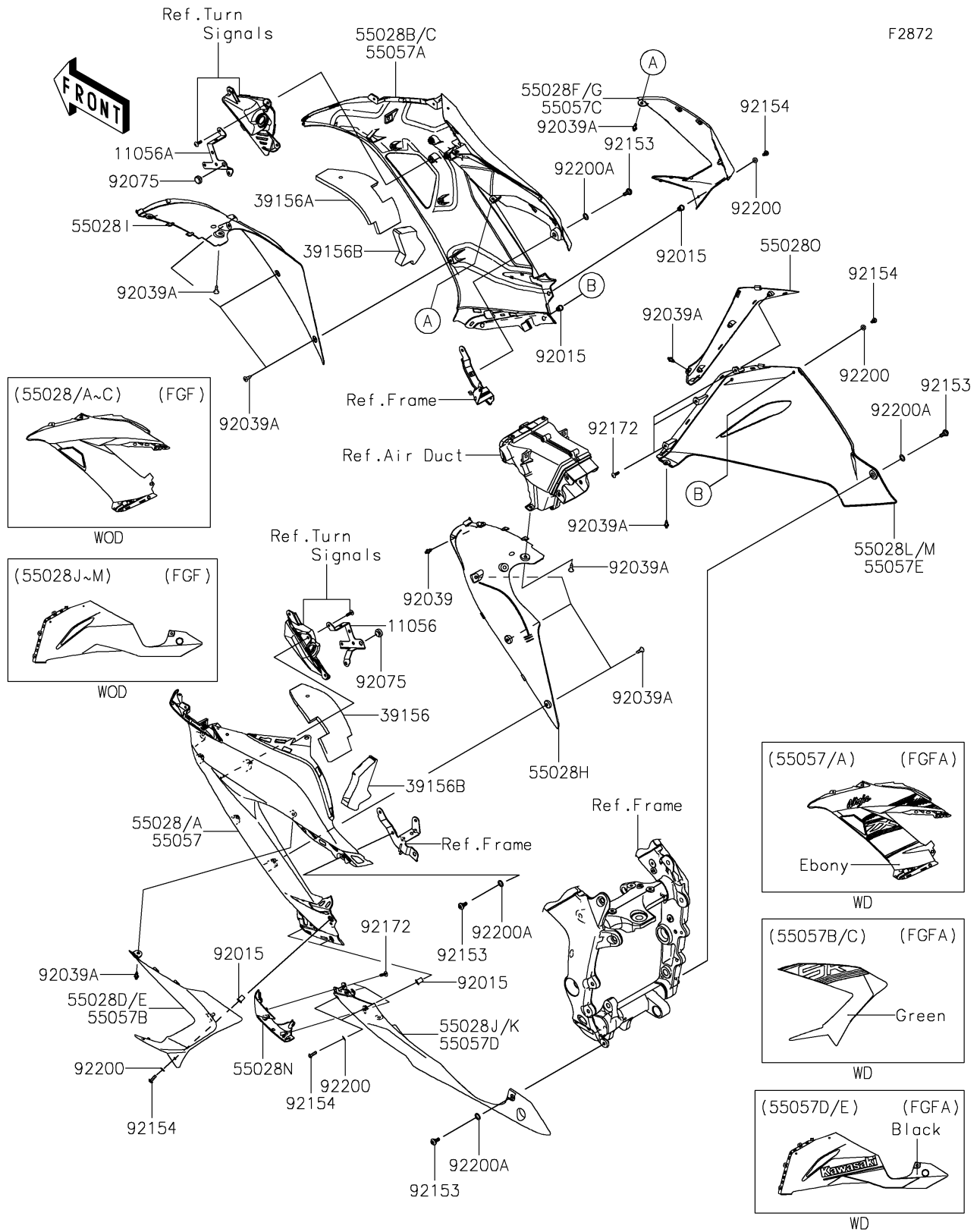

2016 NINJA® ZX™-6R ABS PARTS LIST

Cowling Lowers(FGF/FGFA)

| ITEM NAME | PART NUMBER | QUANTITY |
|---|----------------|----------|
| BRACKET,SIDE COWLING,LH (Ref # 11056) | 11056-2186 | 1 |
| BRACKET,SIDE COWLING,RH (Ref # 11056A) | 11056-2187 | 1 |
| PAD,T10,COWLING LH (Ref # 39156) | 39156-0944 | 1 |
| PAD,T10,COWLING RH (Ref # 39156A) | 39156-0945 | 1 |
| PAD,T20 (Ref # 39156B) | 39156-0958 | 1 |
| COWLING,SIDE,LH,M.M.C.GRAY (Ref # 55028) | 55028-0444-51B | 1 |
| COWLING,SIDE,LH,L.GREEN (Ref # 55028A) | 55028-0444-777 | 1 |
| COWLING,SIDE,RH,M.M.C.GRAY (Ref # 55028B) | 55028-0445-51B | 1 |
| COWLING,SIDE,RH,L.GREEN (Ref # 55028C) | 55028-0445-777 | 1 |
| COWLING,FIN,LH,M.M.C.GRAY (Ref # 55028D) | 55028-0446-51B | 1 |
| COWLING,FIN,LH,L.GREEN (Ref # 55028E) | 55028-0446-777 | 1 |
| COWLING,FIN,RH,M.M.C.GRAY (Ref # 55028F) | 55028-0447-51B | 1 |
| COWLING,FIN,RH,L.GREEN (Ref # 55028G) | 55028-0447-777 | 1 |
| COWLING,FR,LH (Ref # 55028H) | 55028-0448 | 1 |
| COWLING,FR,RH (Ref # 55028I) | 55028-0449 | 1 |
| COWLING,LWR,LH,M.M.C.GRAY (Ref # 55028J) | 55028-0450-51B | 1 |
| COWLING,LWR,LH,L.GREEN (Ref # 55028K) | 55028-0450-777 | 1 |
| COWLING,LWR,RH,M.M.C.GRAY (Ref # 55028L) | 55028-0451-51B | 1 |
| COWLING,LWR,RH,L.GREEN (Ref # 55028M) | 55028-0451-777 | 1 |
| COWLING,LWR,FR,LH (Ref # 55028N) | 55028-0452 | 1 |
| COWLING,LWR,FR,RH (Ref # 55028O) | 55028-0453 | 1 |
| NUT,WELL,5MM (Ref # 92015) | 92015-1757 | 1 |
| RIVET (Ref # 92039) | 92039-0051 | 1 |
| RIVET (Ref # 92039A) | 92039-0068 | 1 |
| DAMPER (Ref # 92075) | 92075-1983 | 1 |
| BOLT,SOCKET,6MM (Ref # 92153) | 92153-0489 | 1 |
| BOLT,SOCKET,5X16 (Ref # 92154) | 92154-0209 | 1 |
| SCREW,TAPPING,5X10 (Ref # 92172) | 92172-0262 | 1 |
| WASHER,NYLONE,5.3X11.5X0.5 (Ref # 92200) | 92200-0006 | 1 |

2016 NINJA® ZX™-6R ABS PARTS LIST

Cowling Lowers(FGF/FGFA)

| ITEM NAME | PART NUMBER | QUANTITY |
|-------------------------------------|-------------|----------|
| WASHER,10.4X15.9X0.5 (Ref # 92200A) | 92200-0157 | 1 |