

## 1982 750 CSR-Twin PARTS DIAGRAM

TRANSMISSION

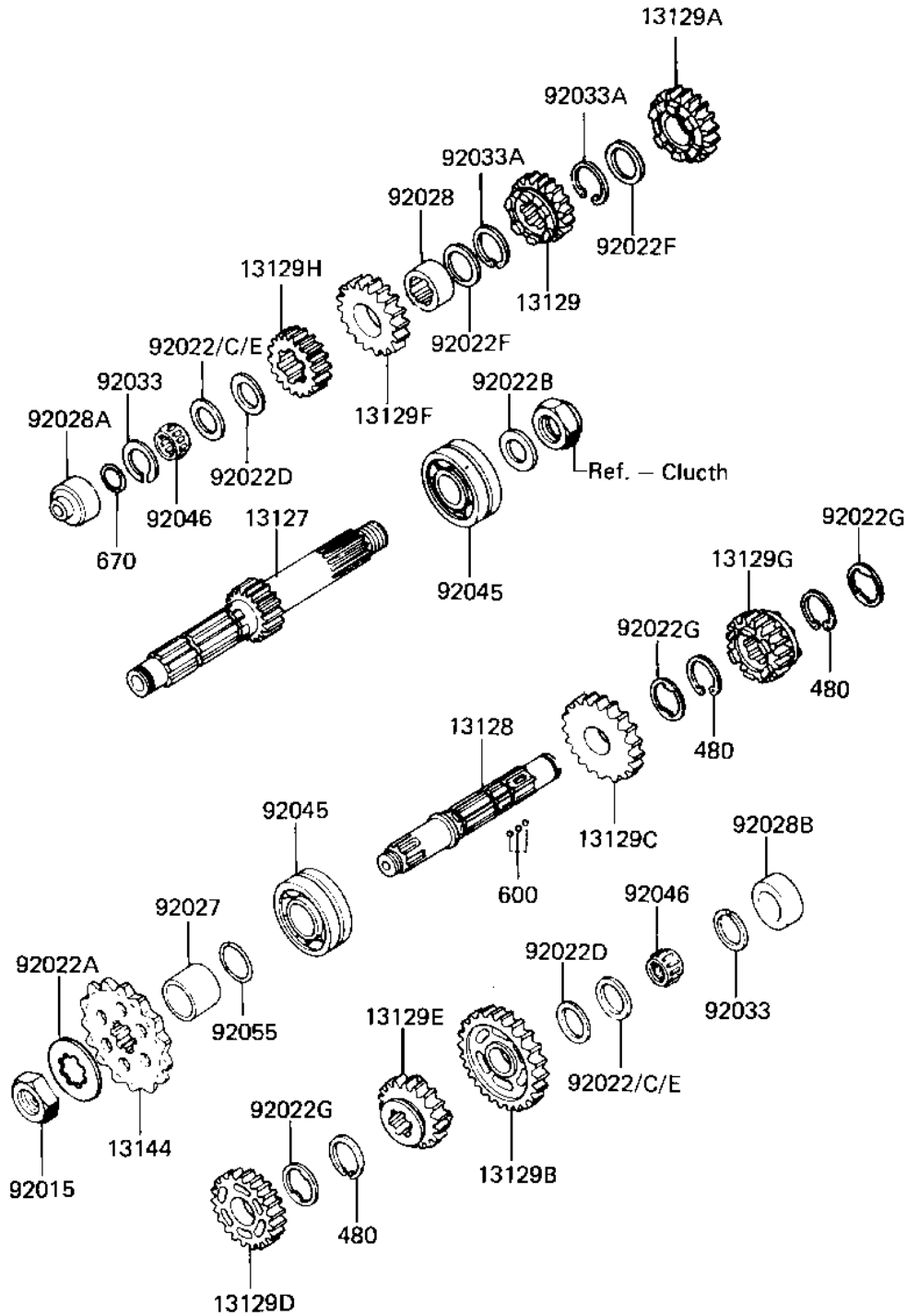

E1361-0030



## 1982 750 CSR-Twin PARTS LIST

### TRANSMISSION

ITEM NAME	PART NUMBER	QUANTITY
SHAFT,DRIVE (Ref # 13127)	13127-1018	1
SHAFT,OUTPUT (Ref # 13128)	13128-1012	1
3RD GEAR,DRIVE SHAFT (Ref # 13129)	13129-1032	1
4TH GEAR,DRIVE SHAFT (Ref # 13129A)	13129-1044	1
LOW GEAR,OUTPUT SHAF (Ref # 13129B)	13129-1046	1
2ND GEAR,OUTPUT SHAF (Ref # 13129C)	13129-1047	1
3RD GEAR,OUTPUT SHAF (Ref # 13129D)	13129-1048	1
4TH GEAR,OUTPUT SHAF (Ref # 13129E)	13129-1049	1
TOP GEAR,DRIVE SHAFT (Ref # 13129F)	13129-1200	1
TOP GEAR,DRIVEN SHAF (Ref # 13129G)	13129-1201	1
2ND GEAR,DRIVE (Ref # 13129H)	13130-041	1
ENGINE SPROCKET,16T (Ref # 13144)	13144-063	1
NUT,20MM (Ref # 92015)	92015-1254	1
WASHER,PLAIN (Ref # 92022)	92022-1026	1
WASHER (Ref # 92022A)	92200-1065	1
WASHER,PLAIN,2.3X20. (Ref # 92022B)	92022-1116	1
WASHER THRUST (Ref # 92022C)	92022-112	1
WASHER THRUST (Ref # 92022D)	92022-113	1
SHIM-KICK SHAFT (Ref # 92022E)	92022-144	1
WASHER PLAIN (Ref # 92022F)	92022-161	1
WASHER,LOCK (Ref # 92022G)	92024-069	1
COLLAR,ENG SPROCKET (Ref # 92027)	92027-288	1
BUSHING,DRV SHFT TOP (Ref # 92028)	92028-1007	1
BUSHING,DRIVE SHAFT (Ref # 92028A)	92028-1032	1
BUSHING,OUTPUT SHAFT (Ref # 92028B)	92028-180	1
CIRCLIP (Ref # 92033)	92033-015	1
CIRCLIP (Ref # 92033A)	92033-026	1
BEARING,BALL (Ref # 92045)	92045-035	1
BEARING,VS20/14A (Ref # 92046)	92046-1030	1

## 1982 750 CSR-Twin PARTS LIST

### TRANSMISSION

ITEM NAME	PART NUMBER	QUANTITY
"O" RING (Ref # 92055)	92055-035	1
CIRCLIP,30MM (Ref # 480)	480J3000	1
BALL STEEL 5/32' (Ref # 600)	600A0500	1
"O" RING,8MM (Ref # 670)	670B1508	1