

1969 PARTS DIAGRAM

CHASSIS ELECTRICAL EQUIPMENT (H1-B)

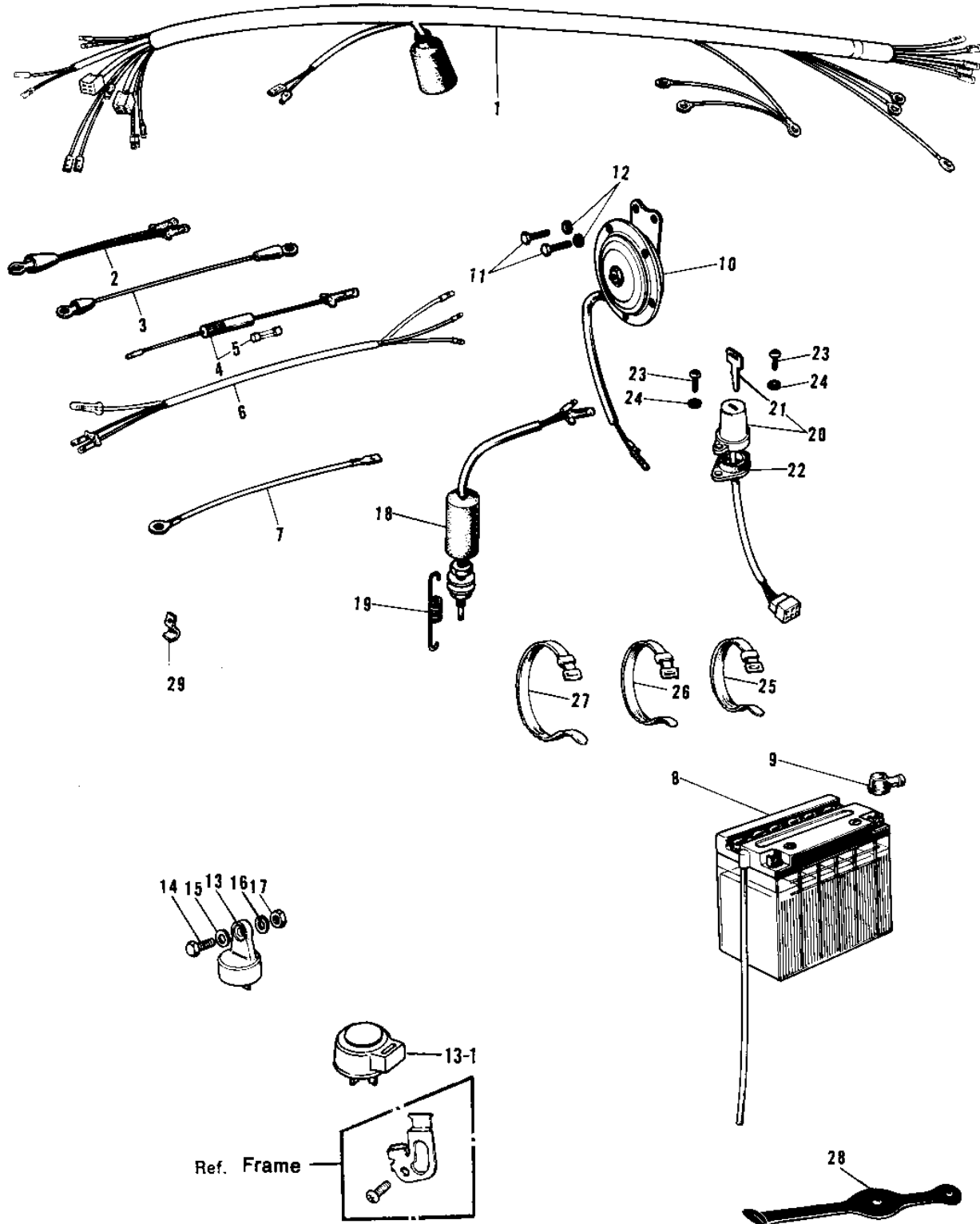

(H1-B)

1969 PARTS LIST

CHASSIS ELECTRICAL EQUIPMENT (H1-B)

ITEM NAME	PART NUMBER	QUANTITY
WIRING HARNESS-MAIN (Ref # 1)	26001-065	1
WIRE BATTERY LEAD (Ref # 2)	26010-015	1
WIRE BATTERY GROUND (Ref # 3)	26010-017	1
FUSE ASSY (Ref # 4)	26004-010	1
FUSE ASSY (Ref # 4)	26004-015	1
FUSE 20A (Ref # 5)	26006-002	1
WIRING HARNESS-REAR (Ref # 6)	26002-030	1
WIRE-READ (Ref # 7)	26011-047	1
YUA BAT 12N9-4B-1 (Ref # 8)	26012-017	1
CAP BAT TERMINAL RUBB (Ref # 9)	92073-001	1
HORN (Ref # 10)	27003-042	1
HORN (Ref # 10)	27003-066	1
BOLT,8X20 (Ref # 11)	115G0820	1
WASHER SPRING 8MM (Ref # 12)	461F0800	1
RELAY-TURN SIGNAL (Ref # 13)	27002-012	1
RELAY-TURN SIGNAL (Ref # 13-1)	27002-011	1
BOLT-UPSET 6X14 (Ref # 14)	112B0614	1
WASHER 6.5X20X1.6T (Ref # 15)	92022-125	1
WASHER SPRING 6MM (Ref # 16)	461F0600	1
NUT 6MM (Ref # 17)	311B0600	1
SWITCH-BRAKE LAMP (Ref # 18)	27010-020	2
SPRING-BRAKE LAMP SW (Ref # 19)	27011-013	1
SWITCH-ASSY-IGNITION (Ref # 20)	27005-1058	2
KEY SET #701 (Ref # 21)	27008-042-01	1
KEY SET #705 (Ref # 21)	27008-042-05	1
KEY SET #685 (Ref # 21)	27008-042-85	1
KEY SET #689 (Ref # 21)	27008-042-89	1
DAMPER RUBBER (Ref # 22)	92075-077	1
BOLT-HEX HEAD,6MM (Ref # 23)	92007-026	1

1969 PARTS LIST

CHASSIS ELECTRICAL EQUIPMENT (H1-B)

ITEM NAME	PART NUMBER	QUANTITY
WASHER PLAIN 8MM (Ref # 24)	410B0800	1
BAND,SHORT (Ref # 25)	92072-030	1
BAND,MIDDLE (Ref # 26)	92072-031	1
BAND,LONG (Ref # 27)	92072-032	1
BAND RUBBER (Ref # 28)	92072-018	1
CLAMP CABLE (Ref # 29)	92037-020	1