

1980 750 LTD-2 PARTS DIAGRAM

VALVES

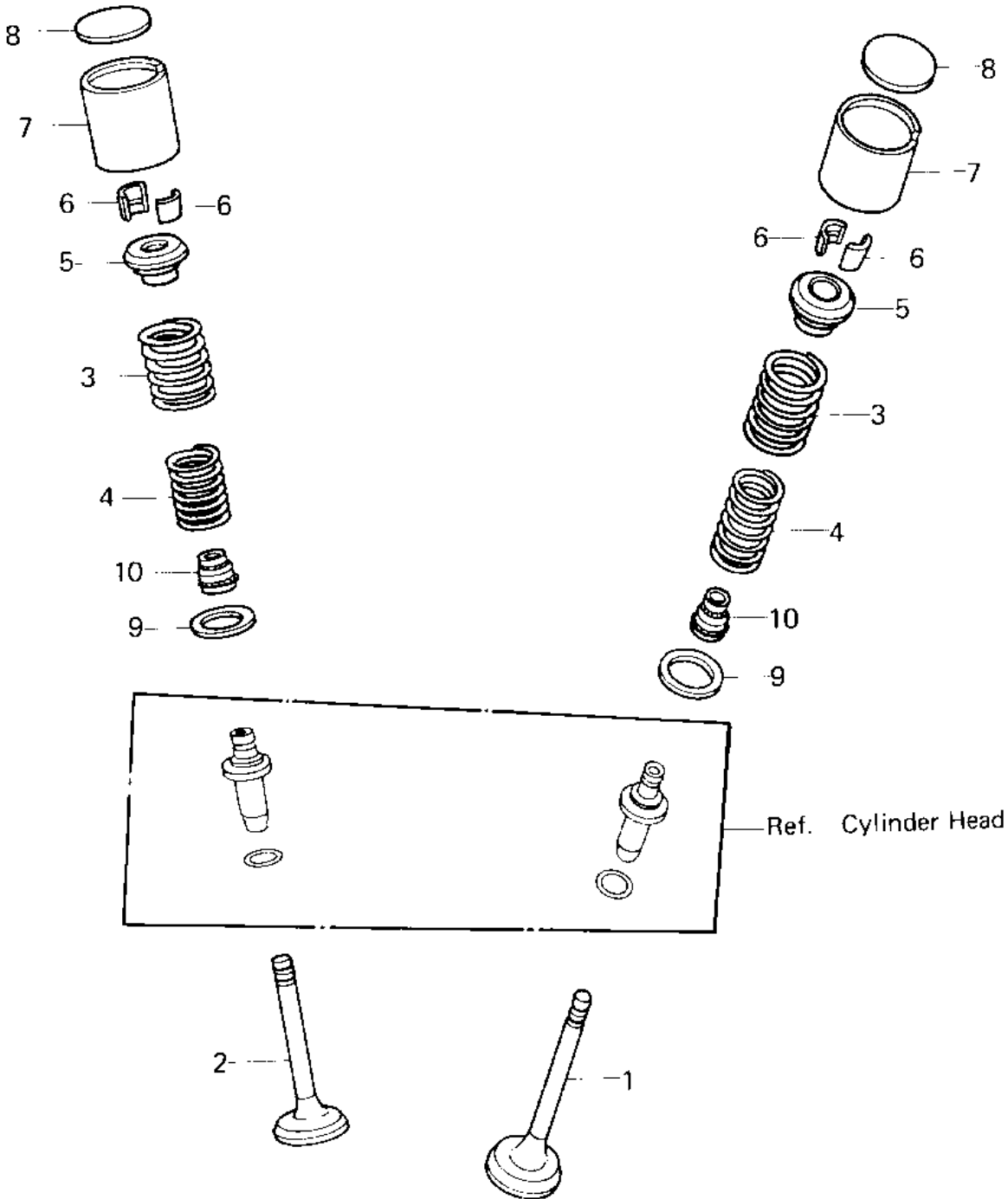

1980 750 LTD-2 PARTS LIST

VALVES

ITEM NAME	PART NUMBER	QUANTITY
VALVE,INLET (Ref # 1)	12004-014	1
VALVE,EXHAUST (Ref # 2)	12005-007	1
SPRING,OUTER VALVE (Ref # 3)	12007-015	1
SPRING,INNER VALVE (Ref # 4)	12007-016	1
RETAINER,VALVE SPRIN (Ref # 5)	12009-007	1
COLLAR,VALVE SPRING (Ref # 6)	12011-003	1
TAPPET (Ref # 7)	12032-006	1
SHIM,2.20T (Ref # 8)	12037-051	1
SHIM,2.25T (Ref # 8)	12037-052	1
SHIM,2.30T (Ref # 8)	12037-053	1
SHIM,2.35T (Ref # 8)	12037-054	1
SHIM,2.40T (Ref # 8)	12037-055	1
SHIM,2.45T (Ref # 8)	12037-056	1
SHIM,2.50T (Ref # 8)	12037-057	1
SHIM,2.55T (Ref # 8)	12037-058	1
SHIM,2.60T (Ref # 8)	12037-059	1
SHIM,2.65T (Ref # 8)	12037-060	1
SHIM,2.70T (Ref # 8)	12037-061	1
SHIM,2.75T (Ref # 8)	12037-062	1
SHIM,2.80T (Ref # 8)	12037-063	1
SHIM,2.85T (Ref # 8)	12037-064	1
SHIM,2.90T (Ref # 8)	12037-065	1
SHIM,2.95T (Ref # 8)	12037-066	1
SHIM,3.00T (Ref # 8)	12037-067	1
SHIM,3.05T (Ref # 8)	12037-068	1
SHIM,3.10T (Ref # 8)	12037-069	1
SHIM,3.15T (Ref # 8)	12037-070	1
SHIM,3.20T (Ref # 8)	12037-071	1
SHIM,3.25T (Ref # 8)	12037-072	1

1980 750 LTD-2 PARTS LIST

VALVES

ITEM NAME	PART NUMBER	QUANTITY
SHIM,3.30T (Ref # 8)	12037-073	1
SHIM,3.35T (Ref # 8)	12037-074	1
SHIM,3.40T (Ref # 8)	12037-075	1
WASHER,PLAIN (Ref # 9)	92022-309	1
OIL SEAL,VALVE (Ref # 10)	92049-017	1