

1981 1000 GP PARTS DIAGRAM

CHASSIS ELECTRICAL EQUIPMENT

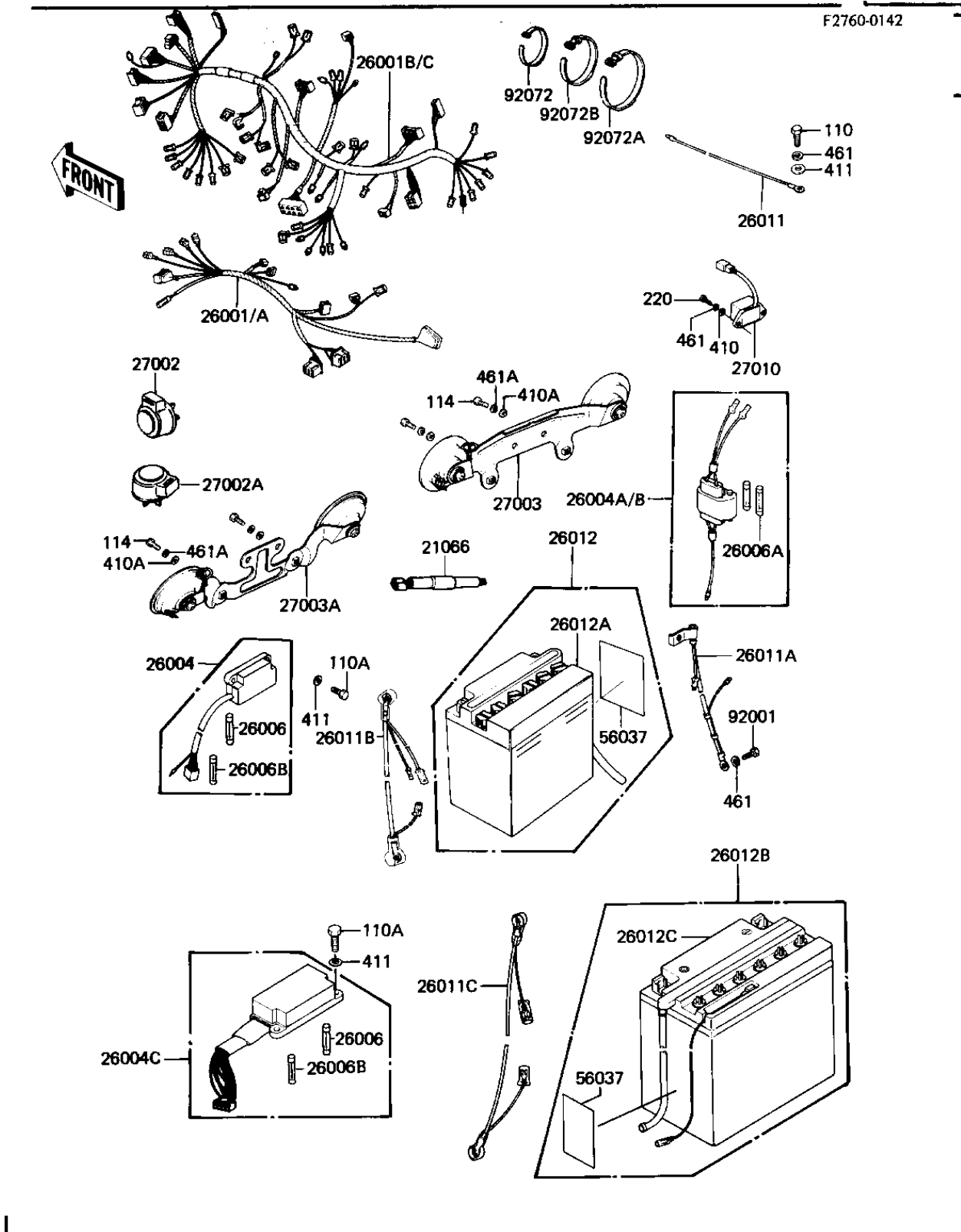

1981 1000 GP PARTS LIST

CHASSIS ELECTRICAL EQUIPMENT

ITEM NAME	PART NUMBER	QUANTITY
REGULATOR (Ref # 21066)	21066-026	1
HARNESS,CONTROL UNIT (Ref # 26001)	26001-1263	1
HARNESS,MAIN (Ref # 26001B)	26001-1354	1
FUSE-ASSY (Ref # 26004)	26004-1011	1
FUSE-ASSY,ACCESSORY (Ref # 26004A)	26004-1014	1
FUSE 10A (Ref # 26006)	26006-003	1
FUSE,10A,L=30M/M (Ref # 26006A)	26006-1002	1
FUSE,30A,L=25M/M (Ref # 26006B)	26006-1005	1
WIRE,LEAD (Ref # 26011)	26011-1069	1
WIRE-LEAD,BATTERY,(-) (Ref # 26011A)	26011-1119	1
WIRE-LEAD,STARTER MTR (Ref # 26011B)	26011-1126	1
FB BAT 12N16-3B (Ref # 26012)	26012-1013	1
BATT 12N16-3B (Ref # 26012A)	26012-1015	1
RELAY-TURN SIGNAL (Ref # 27002)	27002-011	1
RELAY,TURN SIGNAL (Ref # 27002A)	27002-016	1
HORN (Ref # 27003)	27003-1054	1
SWITCH,RESERVE LIGHTI (Ref # 27010)	27010-1024	1
LABEL-WARNING,BATTERY (Ref # 56037)	56040-1036	1
BOLT,HEX HEAD,6MM (Ref # 92001)	92001-137	1
BAND,MIDDLE (Ref # 92072)	92072-031	1
BAND,LONG (Ref # 92072A)	92072-032	1
BAND,WIRING HARNESS (Ref # 92072B)	92072-056	1
BOLT-UPSET,6X12 (Ref # 110)	112G0612	1
BOLT 6X22 (Ref # 110A)	112B0622	1
BOLT-SMALL,8X16,BLACK (Ref # 114)	115C0816	1
SCREW PAN HEAD 6X20 (Ref # 220)	220B0620	1
WASHER PLAIN 6MM (Ref # 410)	410B0600	1
WASHER,PLAIN,8MM (Ref # 410A)	92022-1554	1
WASHER PLAIN 6MM (Ref # 411)	411B0600	1

1981 1000 GP PARTS LIST

CHASSIS ELECTRICAL EQUIPMENT

ITEM NAME	PART NUMBER	QUANTITY
WASHER SPRING 6MM (Ref # 461)	461F0600	1
WASHER-SPRING,8MM,BLA (Ref # 461A)	461K0800	1