

1972 PARTS DIAGRAM

FRAME/FRAME FITTINGS (H2-B/C)

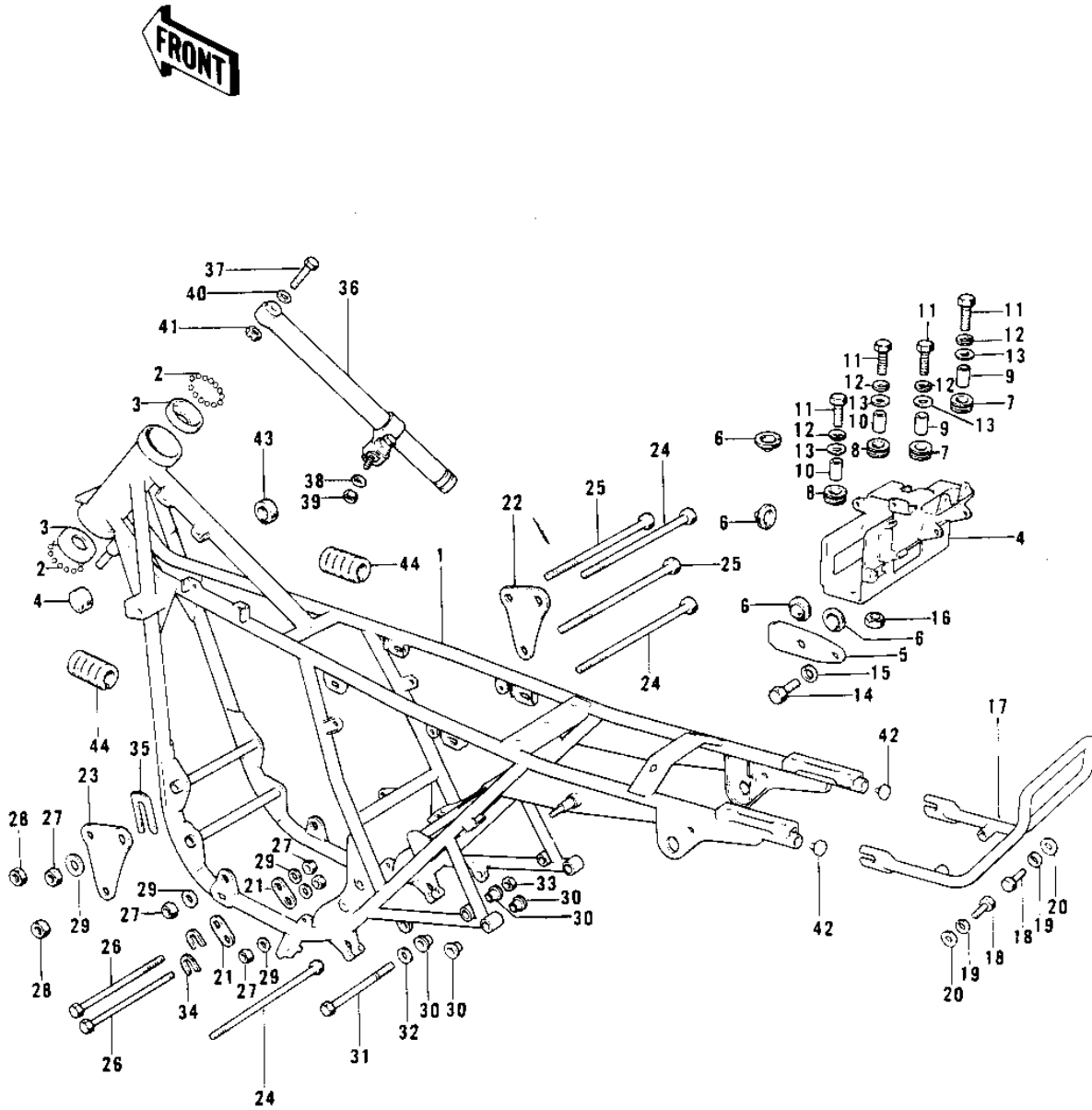

(H2-B/C)

1972 PARTS LIST

FRAME/FRAME FITTINGS (H2-B/C)

| ITEM NAME | PART NUMBER | QUANTITY |
|----------------------------------|-------------|----------|
| FRAME (Ref # 1) | 32002-080 | 1 |
| FRAME (Ref # 1) | 32002-107 | 1 |
| BALL STEEL 1/4' (Ref # 2) | 600A0800 | 1 |
| RACE STRNG STEM BERNG (Ref # 3) | 92048-006 | 1 |
| CASE,TOOL (Ref # 4) | 32099-014 | 1 |
| BAND-BATTERY (Ref # 5) | 32100-014 | 1 |
| DAMPER RUBBER (Ref # 6) | 92075-078 | 1 |
| DAMPER RUBBER,CASE (Ref # 7) | 92075-222 | 1 |
| DAMPER RUBBER (Ref # 8) | 92075-076 | 1 |
| COLLAR 6.8X10X10.5 (Ref # 9) | 92027-120 | 1 |
| COLLAR,6.8X10X8.5 (Ref # 10) | 92027-129 | 1 |
| BOLT 6X22 (Ref # 11) | 112B0622 | 1 |
| WASHER SPRING 6MM (Ref # 12) | 461F0600 | 1 |
| WASHER 6.5X20X1.6T (Ref # 13) | 92022-125 | 1 |
| BOLT-UPSET 6X14 (Ref # 14) | 112B0614 | 1 |
| WASHER PLAIN 6MM (Ref # 15) | 410B0600 | 1 |
| NUT 6MM (Ref # 16) | 311B0600 | 1 |
| STAY,REAR FENDER (Ref # 17) | 35032-025 | 1 |
| BOLT,8X20 (Ref # 18) | 115G0820 | 1 |
| WASHER SPRING 8MM (Ref # 19) | 461F0800 | 2 |
| WASHER PLAIN 8MM (Ref # 20) | 411B0800 | 2 |
| PLATE REAR ENG HOLDER (Ref # 21) | 32030-016 | 1 |
| PLATE,ENGINE R.H (Ref # 22) | 32030-042 | 1 |
| PLATE,ENGINE L.H (Ref # 23) | 32030-043 | 1 |
| BOLT-ENG MOUNT,10X274 (Ref # 24) | 92091-024 | 1 |
| BOLT-ENG MOUNT,8X270 (Ref # 25) | 92091-021 | 1 |
| BOLT,HEX HEAD,10X125 (Ref # 26) | 92001-1248 | 1 |
| NUT,10MM (Ref # 27) | 92015-1429 | 1 |
| NUT,LOCK,8MM (Ref # 28) | 92015-1124 | 2 |

1972 PARTS LIST

FRAME/FRAME FITTINGS (H2-B/C)

| ITEM NAME | PART NUMBER | QUANTITY |
|----------------------------------|-------------|----------|
| WASHER PLAIN 10MM (Ref # 29) | 410B1000 | 1 |
| BUSHING,MUFFLER FITT (Ref # 30) | 92092-010 | 1 |
| BOLT HEX HEAD 10X56 (Ref # 31) | 113N1056 | 1 |
| WASHER-HANDLEBAR FIT (Ref # 32) | 92022-196 | 1 |
| NUT,LOCK,10MM (Ref # 33) | 92019-021 | 1 |
| SHIM-ENG FIT RR,0.5MM (Ref # 34) | 92025-048 | 1 |
| SHIM-ENG FIT RR,0.8MM (Ref # 34) | 92025-049 | 1 |
| SHIM-ENG FIT RR,1.0MM (Ref # 34) | 92025-050 | 1 |
| SHIM-ENG FIT RR,1.6MM (Ref # 34) | 92025-051 | 1 |
| SHIM-ENG FIT RR,2.0MM (Ref # 34) | 92025-052 | 1 |
| SHIM-ENG FIT FR,0.5MM (Ref # 35) | 92025-053 | 1 |
| SHIM-ENG FIT FR,0.8MM (Ref # 35) | 92025-054 | 1 |
| SHIM-ENG FIT FR,1.0MM (Ref # 35) | 92025-055 | 1 |
| SHIM-ENG FIT FR,1.6MM (Ref # 35) | 92025-056 | 1 |
| SHIM-ENG FIT FR,2.0MM (Ref # 35) | 92025-057 | 1 |
| SHIM-ENG FIT FR,2.3MM (Ref # 35) | 92025-058 | 1 |
| OIL DAMPER-STEERING (Ref # 36) | 46117-006 | 1 |
| BOLT-SMALL-UPSET,8X30 (Ref # 37) | 115G0830 | 1 |
| NUT,8MM (Ref # 41) | 311B0800 | 1 |
| PLUG (Ref # 42) | 32112-006 | 1 |
| DAMPER RUBBER (Ref # 43) | 92075-044 | 1 |
| DAMPER RUBBER (Ref # 44) | 92075-084 | 1 |