

## 1972 PARTS DIAGRAM

HANDLEBAR ('71-'72 F8/F8-A)

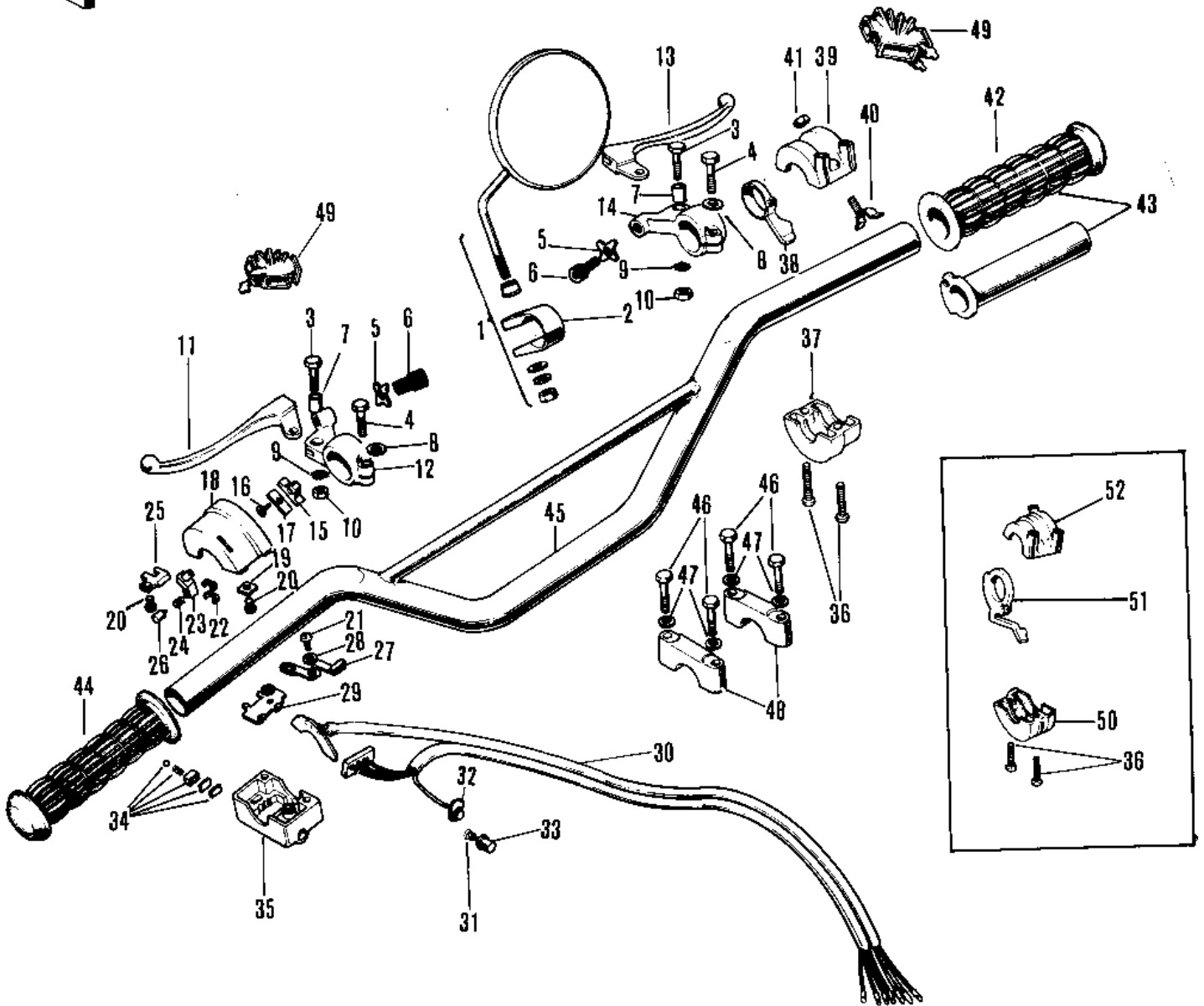

## 1972 PARTS LIST

HANDLEBAR ('71-'72 F8/F8-A)

| ITEM NAME                          | PART NUMBER | QUANTITY |
|------------------------------------|-------------|----------|
| REAR VIEW MIRROR (Ref # 1)         | 56001-005   | 1        |
| BRACKET (Ref # 2)                  | 56006-001   | 1        |
| LEVER ASSY-CLUTCH (Ref # 3~12,4)   | 46076-014   | 1        |
| BOLT HEX HEAD 5X20 (Ref # 3)       | 92007-020   | 1        |
| BOLT-UPSET (Ref # 4)               | 112N0620    | 1        |
| NUT LOCK ADJUST SCREW (Ref # 5)    | 46056-001   | 1        |
| SCREW CABLE ADJUST (Ref # 6)       | 46055-003   | 1        |
| COLLAR LEVER (Ref # 7)             | 46059-011   | 1        |
| WASHER PLAIN 6MM (Ref # 8)         | 410B0600    | 1        |
| WASHER LOCK 5MM (Ref # 9)          | 464H0500    | 1        |
| NUT 5MM (Ref # 10)                 | 312B0500    | 2        |
| LEVER-CLUTCH (Ref # 11)            | 46092-015   | 1        |
| HOLDER,CLUTCH LEVER (Ref # 12)     | 46094-010   | 1        |
| LEVER ASSY-FRNT BRAKE (Ref # 3~10) | 46021-010   | 1        |
| LEVER FRONT BRAKE (Ref # 13)       | 46058-004   | 1        |
| HOLDER-FR BRAKE LEVER (Ref # 14)   | 46060-006   | 1        |
| CASE ASSY-L.H (Ref # 15~36)        | 46091-004   | 1        |
| KNOB-L.H SWITCH (Ref # 15)         | 46044-011   | 1        |
| SCREW CNTSNK HD 3X8 (Ref # 16)     | 221B0308A   | 1        |
| SPRING L.H SW KNOB (Ref # 17)      | 46031-003   | 1        |
| CASE L.H SWITCH UPPER (Ref # 18)   | 46086-013   | 1        |
| HOLDER L.H SW UPPER A (Ref # 19)   | 46085-013   | 1        |
| SCREW PAN HEAD 3X5 (Ref # 20)      | 220B0305A   | 1        |
| SCREW PAN HEAD 3X8 (Ref # 21)      | 220B0308    | 1        |
| PLATE L.H SW CONTACT (Ref # 22)    | 46080-002   | 1        |
| SWITCH L.H (Ref # 23)              | 46089-003   | 1        |
| SPRING L.H SWITCH (Ref # 24)       | 46031-004   | 1        |
| HOLDER L.H SW LOWER B (Ref # 25)   | 46085-014   | 1        |
| CONTACT L.H SWITCH (Ref # 26)      | 46079-002   | 1        |

## 1972 PARTS LIST

HANDLEBAR ('71-'72 F8/F8-A)

| ITEM NAME                            | PART NUMBER | QUANTITY |
|--------------------------------------|-------------|----------|
| KNOB-SWITCH (Ref # 27)               | 46044-006   | 1        |
| WASHER (Ref # 28)                    | 92095-010   | 1        |
| HOLDER L.H SW LOWER (Ref # 29)       | 46085-015   | 1        |
| WIRING HARNESS-L.H SW (Ref # 30)     | 46082-017   | 1        |
| SWITCH ASSY,HORN BUTN (Ref # 31)     | 27010-1009  | 3        |
| SLIDE BLOCK AY-L.H SW (Ref # 34)     | 46089-004   | 1        |
| CASE L.H SWITCH LOWER (Ref # 35)     | 46077-015   | 1        |
| CASE ASSY-R.H (Ref # 36~43)          | 46018-019   | 2        |
| SCREW PAN HEAD 5X22 (Ref # 36)       | 220B0522    | 1        |
| CASE-R.H LOWER (Ref # 37)            | 46023-005   | 2        |
| LEVER-STARTER (Ref # 38)             | 46096-006   | 2        |
| UNAVAILABLE IN PRICE BOOK (Ref # 39) | 46041-003   | 1        |
| SPRING THROTTLE GRIP (Ref # 40)      | 46024-002   | 1        |
| RUBBER-R.H GRIP (Ref # 42)           | 46061-012   | 1        |
| GRIP ASSY-THROTTLE (Ref # 43)        | 46019-013   | 1        |
| RUBBER-L.H GRIP (Ref # 44)           | 46075-017   | 1        |
| HANDLEBAR (Ref # 45)                 | 46004-016   | 1        |
| BOLT 8X38 (Ref # 46)                 | 92001-1405  | 1        |
| WASHER SPRING 8MM (Ref # 47)         | 461F0800    | 1        |
| HOLDER-HANDLEBAR (Ref # 48)          | 46012-008   | 1        |
| DUST COVER (Ref # 49)                | 46071-001   | 1        |
| CASE-R.H.UPPER (Ref # 52)            | 46041-005   | 1        |