

1980 Invader 340 PARTS DIAGRAM

HOOD (SS340-A3, SS440-A3)

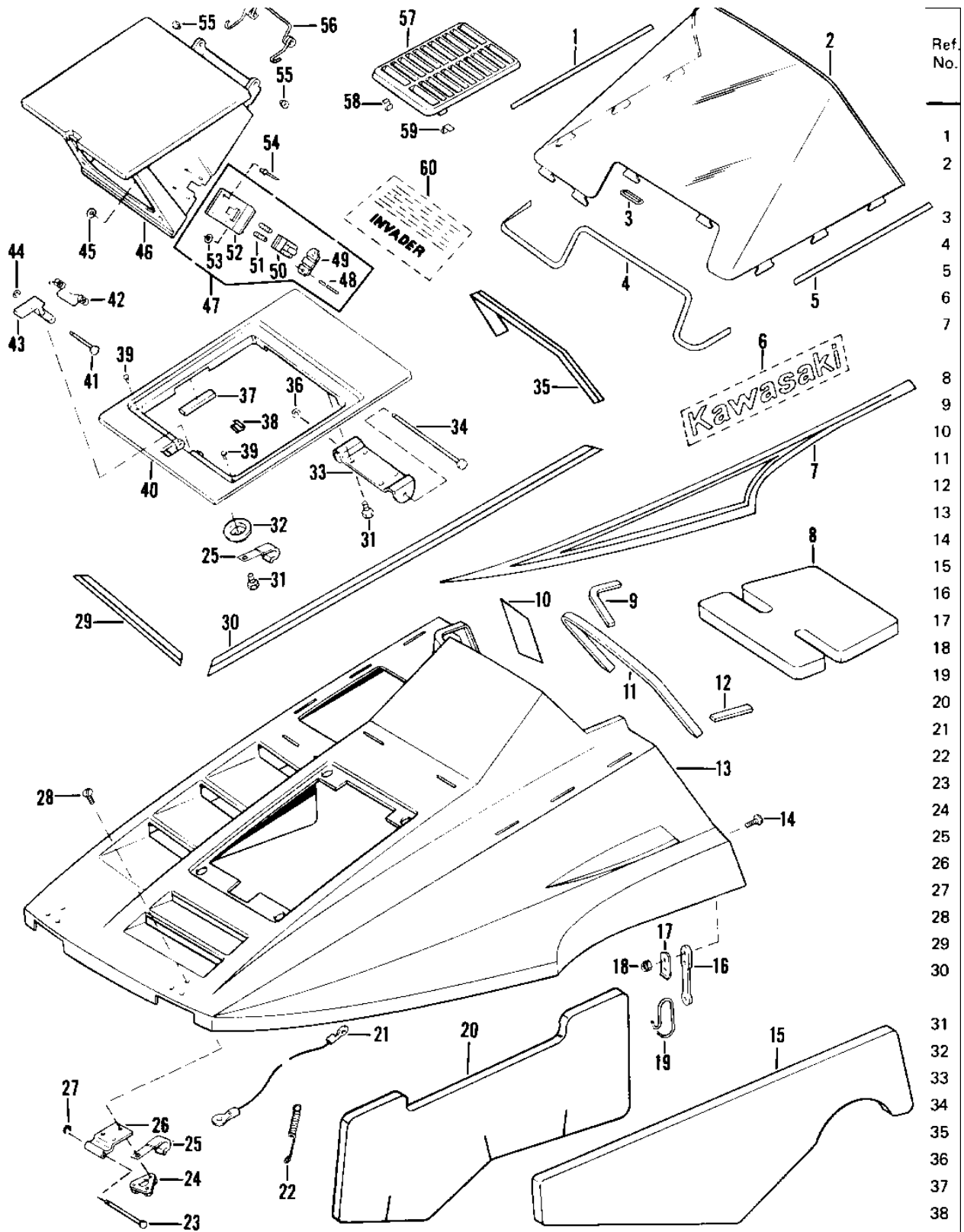

| Ref. No. |
|----------|
| 1 |
| 2 |
| 3 |
| 4 |
| 5 |
| 6 |
| 7 |
| 8 |
| 9 |
| 10 |
| 11 |
| 12 |
| 13 |
| 14 |
| 15 |
| 16 |
| 17 |
| 18 |
| 19 |
| 20 |
| 21 |
| 22 |
| 23 |
| 24 |
| 25 |
| 26 |
| 27 |
| 28 |
| 29 |
| 30 |
| 31 |
| 32 |
| 33 |
| 34 |
| 35 |
| 36 |
| 37 |
| 38 |

1980 Invader 340 PARTS LIST

HOOD (SS340-A3, SS440-A3)

| ITEM NAME | PART NUMBER | QUANTITY |
|------------------------------------|-------------|----------|
| PATTERN-WINDSHIELD-RH (Ref # 1) | 56027-3518 | 1 |
| WINDSHIELD-LOW (Ref # 2) | 39154-3505 | 1 |
| WINDSHIELD-HIGH (Ref # 2) | 39154-3514 | 1 |
| RING-O (Ref # 3) | 92055-3503 | 1 |
| PATTERN-WINDSHIELD FT (Ref # 4) | 56027-3517 | 1 |
| PATTERN-WINDSHIELD LH (Ref # 5) | 56027-3519 | 1 |
| MARK-KAWASAKI (Ref # 6) | 56018-3511 | 1 |
| PATTERN-COWL LH (Ref # 7) | 56027-3542 | 1 |
| PATTERN-COWL RH (Ref # 7) | 56027-3543 | 1 |
| PAD-TOP (Ref # 8) | 39156-3516 | 1 |
| SEAL-HOOD PANEL (Ref # 9) | 39156-3537 | 1 |
| LABEL-WARN-OPERATE (Ref # 10) | 56040-3507 | 1 |
| SEAL-HOOD PANEL (Ref # 11) | 39156-3553 | 1 |
| SEAL-HOOD PANEL (Ref # 12) | 39156-3536 | 1 |
| HOOD-DRK BLUE CNTR \$\$ (Ref # 13) | 59456-3512 | 1 |
| PAD-HOOD,CUT TO FIT (Ref # 15) | 39156-3580 | 2 |
| BAND (Ref # 16) | 92072-3508 | 1 |
| PLATE-BAND (Ref # 17) | 13169-3511 | 1 |
| NUT (Ref # 18) | 351BA0800 | 1 |
| HOOK-RETAINER (Ref # 19) | 27012-3501 | 1 |
| LANYARD-HOOD (Ref # 21) | 39073-3501 | 1 |
| SPRING-LANYARD (Ref # 22) | 92081-3529 | 1 |
| PIN-HINGE (Ref # 23) | 92043-3503 | 1 |
| PLATE-HINGE (Ref # 24) | 13169-3525 | 1 |
| CLAMP-HARNESS-HEAD (Ref # 25) | 92037-3511 | 1 |
| HINGE-HOOD-RH OR LH (Ref # 26) | 53009-3513 | 1 |
| RING-SNAP (Ref # 27) | 92033-3502 | 1 |
| SCREW (Ref # 28) | 250DH0814 | 1 |
| PATTERN-STRIP-FRONT (Ref # 29) | 56027-3541 | 1 |

1980 Invader 340 PARTS LIST

HOOD (SS340-A3, SS440-A3)

| ITEM NAME | PART NUMBER | QUANTITY |
|---------------------------------|-------------|----------|
| PATTERN-SIDE (Ref # 30) | 56027-3540 | 1 |
| PATTERN-STRIPESIDE (Ref # 30) | 56027-3545 | 1 |
| SCREW (Ref # 31) | 92009-3557 | 1 |
| WASHER (Ref # 32) | 92022-3519 | 1 |
| BRACKET-HINGE (Ref # 33) | 11034-3549 | 1 |
| PIN-PIVOT (Ref # 34) | 92043-3507 | 1 |
| PATTERN-TOP (Ref # 35) | 56027-3544 | 1 |
| RING-SNAP (Ref # 36) | 92033-3508 | 1 |
| GASKET-HDLMP HOUSE (Ref # 37) | 11009-3504 | 1 |
| RETAINER-LATCH (Ref # 38) | 14020-3512 | 1 |
| GROMMET (Ref # 39) | 92071-3504 | 1 |
| HOLDER-HEADLAMP (Ref # 40) | 13091-3506 | 1 |
| PIN (Ref # 41) | 92043-3509 | 1 |
| SPRING-TORSION (Ref # 42) | 92081-3520 | 1 |
| LATCH-CLOSED-HDLMP (Ref # 43) | 49031-3503 | 1 |
| RING-SNAP (Ref # 44) | 92033-3506 | 1 |
| WASHER (Ref # 45) | 92022-3539 | 2 |
| HOUSING-HEAD LAMP (Ref # 46) | 13227-3507 | 1 |
| LATCH-ASSY-HDLMP (Ref # 47) | 49031-3507 | 1 |
| .RIVET (Ref # 48) | 535WV0606 | 1 |
| .COVER-LATCH (Ref # 49) | 14025-3506 | 1 |
| .LATCH-OPEN-HDLMP (Ref # 50) | 49031-3508 | 1 |
| .SPRING-LATCH-LDLMP (Ref # 51) | 92081-3552 | 1 |
| .HOUSING-LATCH-HDLMP (Ref # 52) | 13227-3518 | 1 |
| RIVET (Ref # 54) | 534WV0606 | 1 |
| BUSHING-HEAD LAMP (Ref # 55) | 92028-3505 | 1 |
| SPRING-TORSION (Ref # 56) | 92081-3532 | 1 |
| PANEL-VENT (Ref # 57) | 39090-3502 | 1 |
| RETAINER-PANEL VENT (Ref # 58) | 14020-3516 | 1 |

1980 Invader 340 PARTS LIST

HOOD (SS340-A3, SS440-A3)

| ITEM NAME | PART NUMBER | QUANTITY |
|--------------------------------------|-------------|----------|
| RETAINER-PANEL (Ref # 59) | 14020-3507 | 1 |
| MARK-340 INVADER (Ref # 60) | 56018-3513 | 1 |
| UNAVAILABLE IN PRICE BOOK (Ref # 60) | *50275-3512 | 1 |