

1986 KX™125 PARTS DIAGRAM

TRANSMISSION

E1361-0153

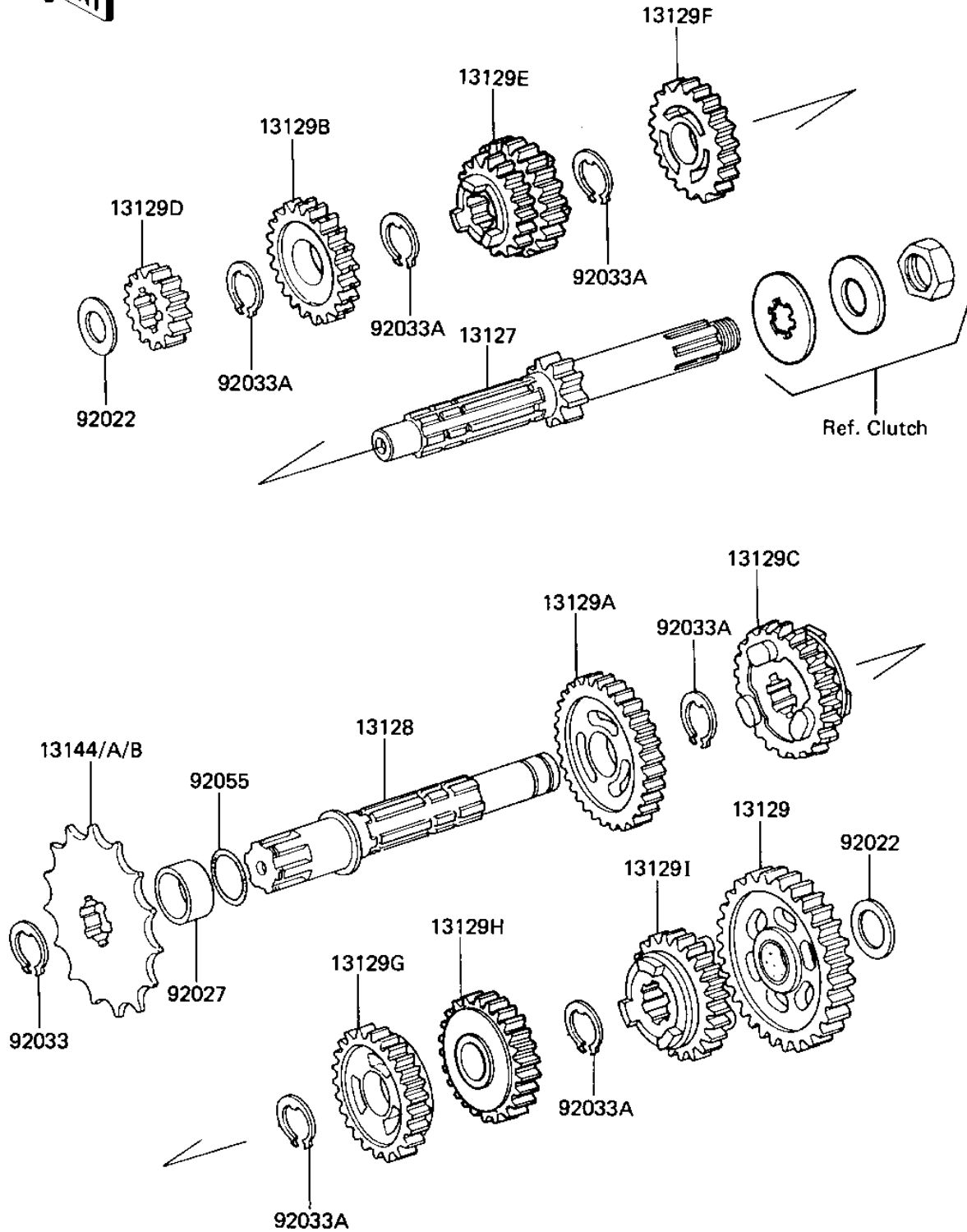

1986 KX™125 PARTS LIST

TRANSMISSION

ITEM NAME	PART NUMBER	QUANTITY
SHAFT-TRANSMISSION I (Ref # 13127)	13127-1116	1
SHAFT-TRANSMISSION O (Ref # 13128)	13128-1115	1
GEAR,OUTPUT,LOW,30T (Ref # 13129)	13129-1304	1
GEAR OUTPUT 2ND,28T (Ref # 13129A)	13129-1386	1
GEAR,INPUT 5TH,24T (Ref # 13129B)	13129-1399	1
GEAR,OUTPUT 5TH,25T (Ref # 13129C)	13129-1405	1
GEAR,INPUT 2ND,16T (Ref # 13129D)	13129-1624	1
GEAR,INPUT 3RD&4TH,2 (Ref # 13129E)	13129-1625	1
GEAR,INPUT TOP,22T (Ref # 13129F)	13129-1626	1
GEAR,OUTPUT 3RD,28T (Ref # 13129G)	13129-1627	1
GEAR,OUTPUT 4TH,26T (Ref # 13129H)	13129-1628	1
GEAR,OUTPUT TOP,21T (Ref # 13129I)	13129-1629	1
ENGINE SPROCKET,11T (Ref # 13144)	13144-1036	1
SPROCKET-OUTPUT,12T (Ref # 13144A)	13144-1049	1
SPROCKET-OUTPUT 13T (Ref # 13144B)	13144-1050	1
WASHER,THRUST,15MM (Ref # 92022)	92022-279	1
COLLAR,20X25X10.8 (Ref # 92027)	92027-1445	1
RING-SNAP,18MM (Ref # 92033)	92033-1079	1
RING-SNAP (Ref # 92033A)	92033-1231	1
"O" RING (Ref # 92055)	92055-022	1