

1982 KZ550 Standard PARTS DIAGRAM

CYLINDER HEAD (KZ550-A3)

E1111-0036

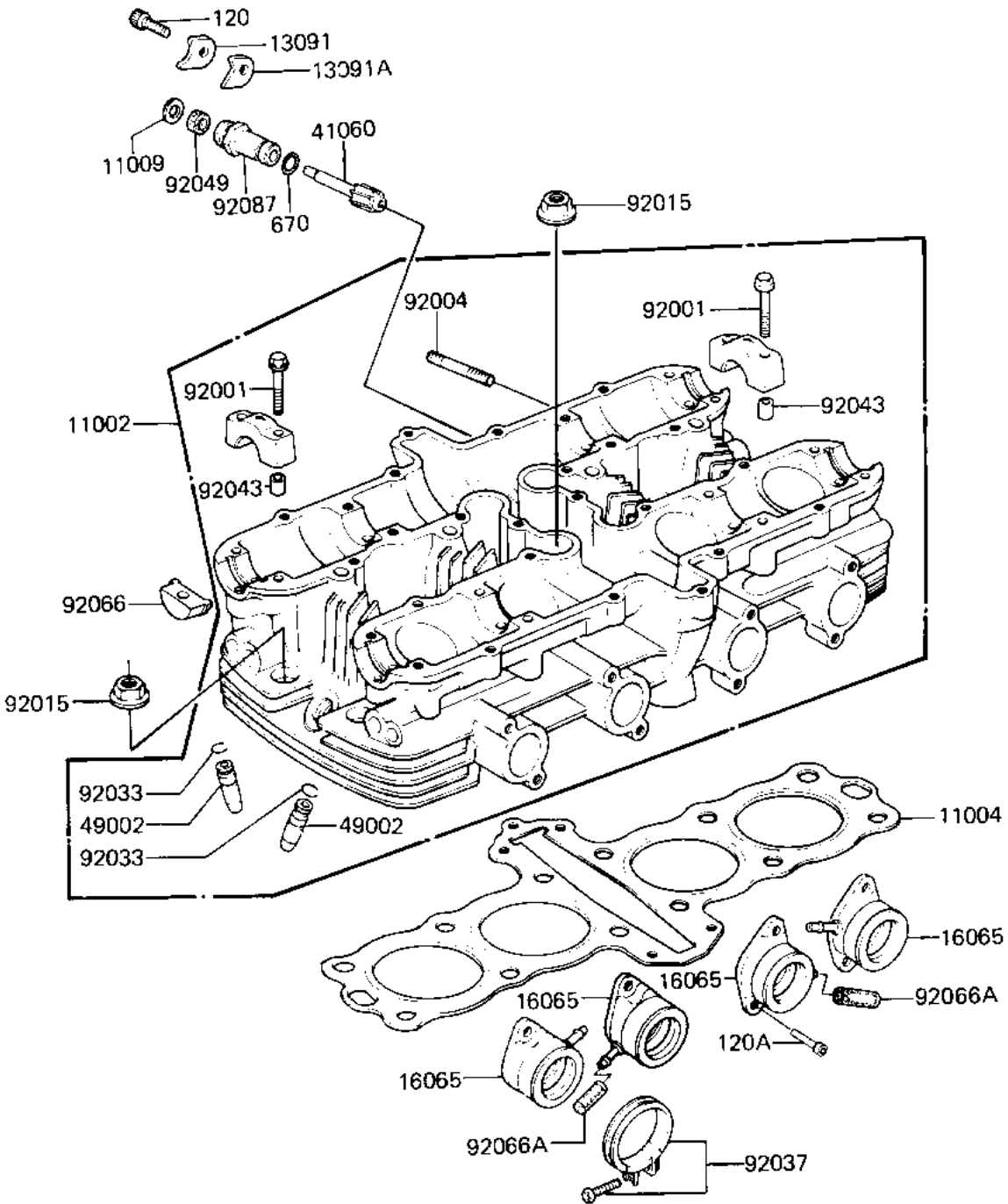

1982 KZ550 Standard PARTS LIST

CYLINDER HEAD (KZ550-A3)

ITEM NAME	PART NUMBER	QUANTITY
HEAD-ASSY-CYL,F.BLACK (Ref # 11002)	11002-1062	1
GASKET-HEAD (Ref # 11004)	11004-1212	1
GASKET,TACHOMETER GER (Ref # 11009)	92065-103	1
HOLDER,TACHOMETER2.3T (Ref # 13091)	13091-1008	1
HOLDER,TACHOMETR,3.2T (Ref # 13091A)	13091-1009	1
HOLDER,CARBURETOR (Ref # 16065)	16065-1014	1
GEAR,TACHOMETER,10T (Ref # 41060)	13223-011	1
GUIDE,VALVE (Ref # 49002)	49002-1005	1
BOLT,FLANGED,6X38 (Ref # 92001)	92001-1105	1
STUD,6X27 (Ref # 92004)	92004-066	1
NUT-8MM (Ref # 92015)	92015-1143	1
CIRCLIP-VALVE (Ref # 92033)	92036-023	1
CLAMP,CARBURETOR,40MM (Ref # 92037)	92037-1129	1
PIN-DOWEL (Ref # 92043)	92042-007	1
OIL SEAL (Ref # 92049)	92050-075	1
PLUG,CAMSHAFT,11.35X1 (Ref # 92066)	92066-1111	1
RUBBER PLUG (Ref # 92066A)	92068-006	1
GUIDE,TACHOMETER GEAR (Ref # 92087)	92087-010	1
BOLT,6X14 (Ref # 120)	120P0614	1
BOLT-SOCKET,6X16,BLAC (Ref # 120A)	120S0616	1
"O" RING,10MM (Ref # 670)	670D1510	1