

1982 KZ1300 Standard PARTS DIAGRAM

FRONT MASTER CYLINDER

F2291-0064

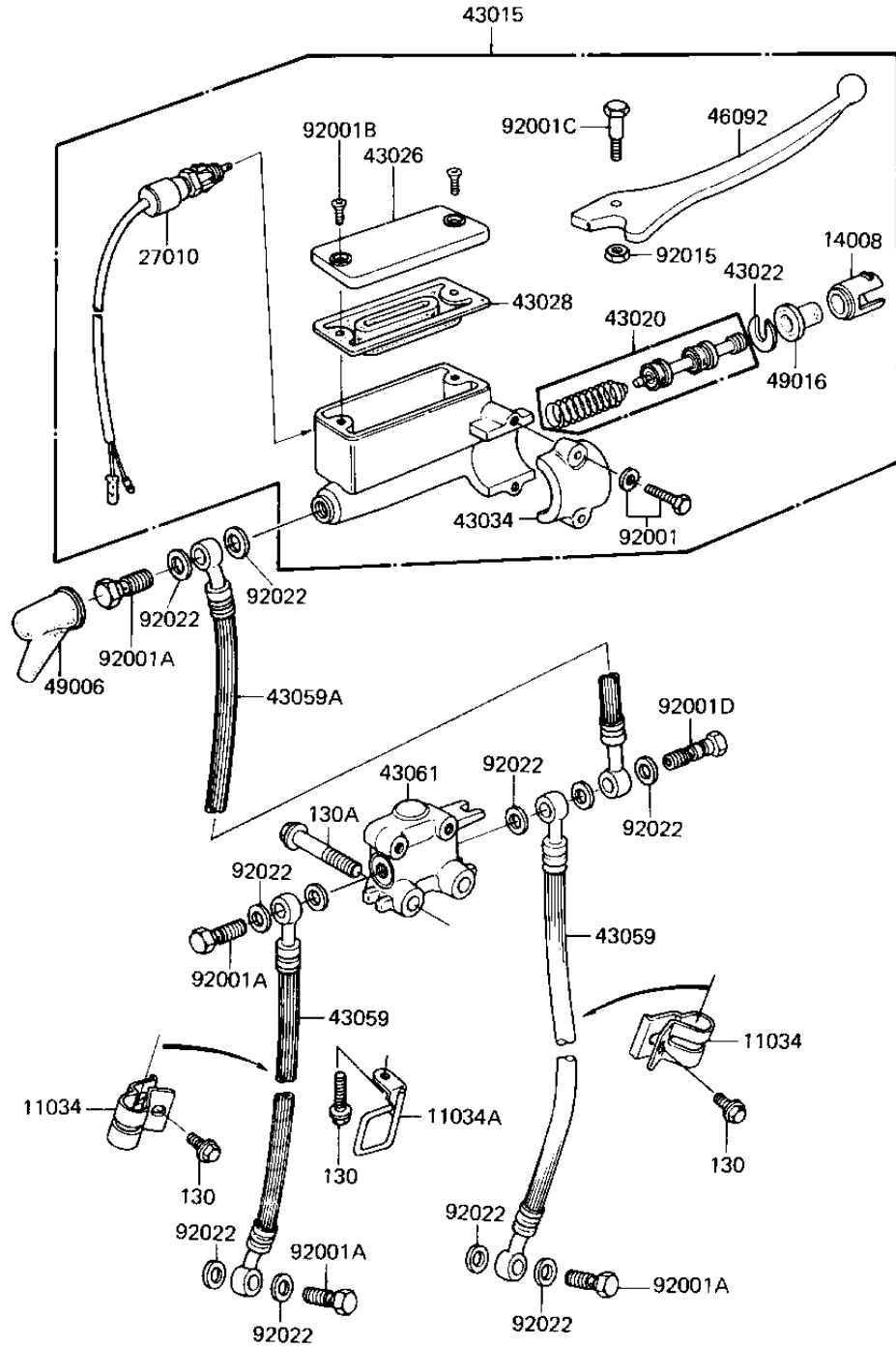

1982 KZ1300 Standard PARTS LIST

FRONT MASTER CYLINDER

| ITEM NAME | PART NUMBER | QUANTITY |
|--------------------------------------|-------------|----------|
| BRACKET,BRAKE HOSE (Ref # 11034) | 11034-1284 | 1 |
| BRACKET,SPEED CABLE (Ref # 11034A) | 11034-1285 | 1 |
| LINER,PISTON (Ref # 14008) | 14008-1007 | 1 |
| SWITCH,BRAKE (Ref # 27010) | 27010-1028 | 1 |
| CYLINDER ASSY,FRONT (Ref # 43015) | 43015-1060 | 1 |
| PISTON-COMP-BRAKE (Ref # 43020) | 43020-1023 | 1 |
| STOPER,PISTON (Ref # 43022) | 43022-1001 | 1 |
| CAP,OIL CUP (Ref # 43026) | 43026-1012 | 1 |
| DIAPHRAGM (Ref # 43028) | 43028-1008 | 1 |
| HOLDER,MASTER CYLINDR (Ref # 43034) | 43034-1001 | 1 |
| HOSE-BRAKE,L=570 (Ref # 43059) | 43059-1175 | 1 |
| HOSE,BRAKE (Ref # 43059A) | 43059-1042 | 1 |
| JOINT,BRAKE (Ref # 43061) | 43061-1001 | 1 |
| LEVER,FRONT BRAKE (Ref # 46092) | 46092-1004 | 1 |
| BOOT,DUST (Ref # 49006) | 49006-1041 | 1 |
| DUST COVER (Ref # 49016) | 49016-1010 | 1 |
| BOLT,HEX HEAD,6X25 (Ref # 92001) | 43033-003 | 1 |
| BOLT,OIL,L=23 (Ref # 92001A) | 92002-1888 | 1 |
| SCREW,COUNTERSUNK HED (Ref # 92001B) | 92001-1055 | 1 |
| BOLT,CLUTCH LEV FITT (Ref # 92001C) | 92001-1056 | 1 |
| BOLT (Ref # 92001D) | 92002-1909 | 1 |
| NUT 6MM (Ref # 92015) | 312B0600 | 1 |
| WASHER-OIL BOLT (Ref # 92022) | 43067-001 | 1 |
| BOLT,FLANGED,6X8 (Ref # 130) | 130B0608 | 1 |
| BOLT,FLANGED,8X45 (Ref # 130A) | 130G0845 | 1 |