

1973 F11 PARTS DIAGRAM

FENDERS (73-75 F11/F11-A/F11-B)

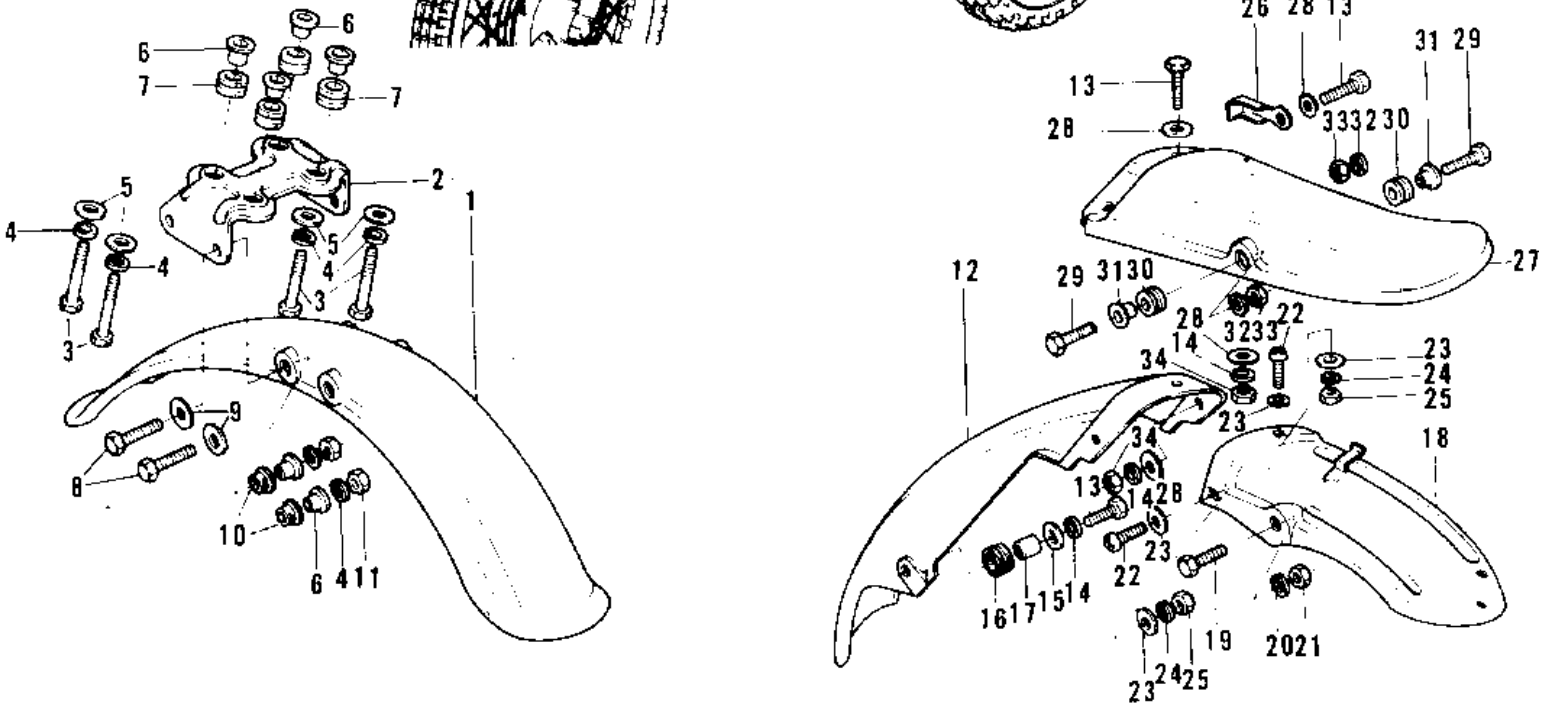
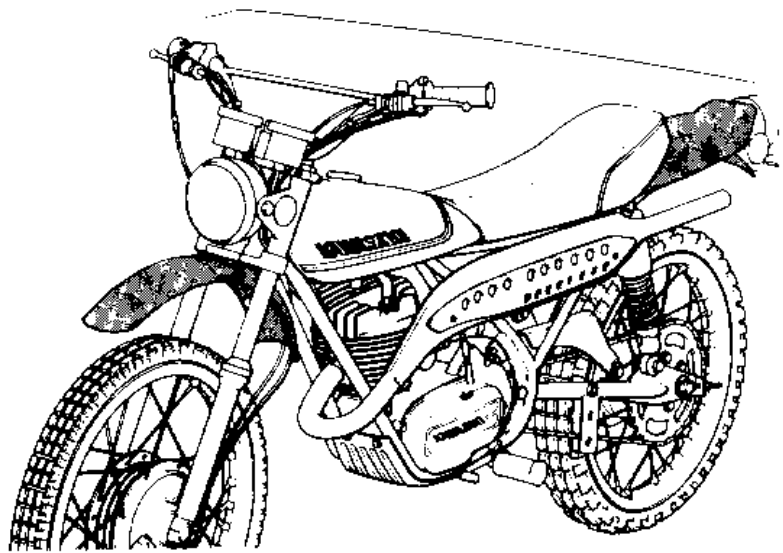

1973 F11 PARTS LIST

FENDERS (73-'75 F11/F11-A/F11-B)

ITEM NAME	PART NUMBER	QUANTITY
FENDER-FR,C.YELLOW (Ref # 1)	35004-066-1U	1
FENDER-FR,C.RED (Ref # 1)	35004-066-92	1
FENDER-FR,C.YELLOW (Ref # 1)	35004-066-1U	1
FENDER-FR,C.LIME (Ref # 1)	35004-066-1M	1
FENDER-FR,SILVER (Ref # 1)	35004-066-1W	1
BRACKET-FRONT FENDER (Ref # 2)	35012-016	1
BOLT-UPSET,6X20 (Ref # 3)	112G0620	4
BOLT-UPSET,6X20 (Ref # 3)	112G0620	AL
WASHER SPRING 6MM (Ref # 4)	461F0600	8
WASHER 6.5X20X1.6T (Ref # 5)	92022-125	4
COLLAR (Ref # 6)	92027-153	8
DAMPER RUBBER (Ref # 7)	92075-051	4
BOLT HEX HEAD 6X18 (Ref # 8)	110N0618	4
WASHER PLAIN (Ref # 9)	92022-024	4
DAMPER RUBBER (Ref # 10)	92075-103	4
NUT 6MM (Ref # 11)	311B0600	4
FENDER-RR (Ref # 12)	35022-066	1
BOLT-UPSET (Ref # 13)	112G0618	5
BOLT-UPSET (Ref # 13)	112G0618	AL
WASHER SPRING 6MM (Ref # 14)	461F0600	5
WASHER 6.5X20X1.6T (Ref # 15)	92022-125	2
DAMPER RUBBER (Ref # 16)	92075-105	2
COLLAR (Ref # 17)	92027-103	2
FENDER-RR,BLACK (Ref # 18)	35022-067-21	1
BOLT-SMALL-UPSET,8X1 (Ref # 19)	115B0814	2
BOLT-SMALL-UPSET,8X1 (Ref # 19)	115B0814	AL
WASHER SPRING 8MM (Ref # 20)	461F0800	2
NUT,8MM (Ref # 21)	311B0800	2
BOLT-UPSET,6X16 (Ref # 22)	112G0616	3

1973 F11 PARTS LIST

FENDERS (73-75 F11/F11-A/F11-B)

ITEM NAME	PART NUMBER	QUANTITY
BOLT-UPSET,6X16 (Ref # 22)	112G0616	AL
WASHER 6.5X20X1.6T (Ref # 23)	92022-125	6
WASHER SPRING 6MM (Ref # 24)	461F0600	3
NUT 6MM (Ref # 25)	311B0600	1
CLAMP (Ref # 26)	92037-085	1
COVER-RR FENDR,YELLO (Ref # 27)	53043-003-74	1
COVER,RR FENDER.C.RE (Ref # 27)	53043-003-92	1
COVER,RR FENDER,YELO (Ref # 27)	53043-003-1U	1
COVER,RR FENDER,YELO (Ref # 27)	53043-003-1U	1
COVER,RR FEND,SILVER (Ref # 27)	53043-003-1W	1
WASHER-PL-10.5X26X2. (Ref # 28)	92022-044	6
BOLT-HEX HEAD,10X46 (Ref # 29)	92007-029	2
DAMPER RUBBER (Ref # 30)	92075-104	2
COLLAR (Ref # 31)	92027-147	2
WASHER SPRING 10MM (Ref # 32)	461F1000	2
NUT,10MM (Ref # 33)	314B1000	2
NUT (Ref # 34)	92019-008	3