

# 2010 Brute Force® 750 4x4i

## PARTS DIAGRAM

### Chassis Electrical Equipment

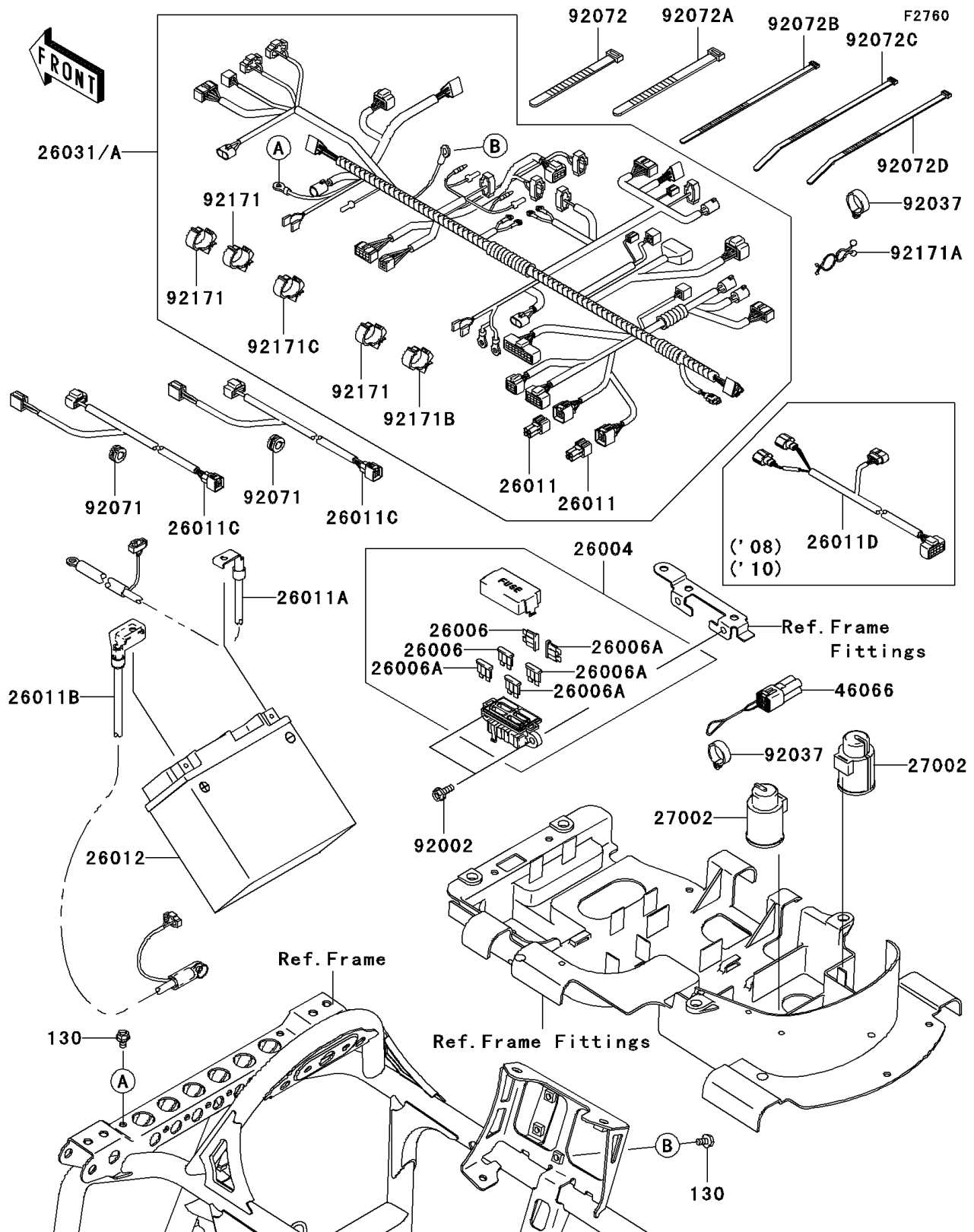

# 2010 Brute Force® 750 4x4i

## PARTS LIST

### Chassis Electrical Equipment

ITEM NAME	PART NUMBER	QUANTITY
BOLT-FLANGED,6X10 (Ref # 130)	130BB0610	2
FUSE-ASSY (Ref # 26004)	26004-0016	1
FUSE,30A (Ref # 26006)	26006-0004	2
FUSE,10A (Ref # 26006A)	26006-0005	4
WIRE-LEAD (Ref # 26011)	26011-0037	2
WIRE-LEAD,BATTERY(-) (Ref # 26011A)	26011-0137	1
WIRE-LEAD,BATTERY(+) (Ref # 26011B)	26011-0138	1
WIRE-LEAD,HEAD LAMP (Ref # 26011C)	26011-0141	2
WIRE-LEAD,HARNESS INJECTOR (Ref # 26011D)	26011-0150	1
BATTERY,MF,KMX14-BS,12V 12AH (Ref # 26012)	26012-1414	1
HARNESS,MAIN (Ref # 26031)	26031-0654	1
RELAY-ASSY (Ref # 27002)	27002-1062	2
CONNECTOR-ASSY,RESET (Ref # 46066)	46066-0001	1
BOLT,6X16 (Ref # 92002)	92002-1571	2
CLAMP,HOSE (Ref # 92037)	92037-1827	10
GROMMET (Ref # 92071)	92071-1128	2
BAND,L=123 (Ref # 92072)	92072-030	5
BAND,L=149 (Ref # 92072A)	92072-031	1
BAND,L=186 (Ref # 92072B)	92072-056	1
BAND,L=188 (Ref # 92072C)	92072-1239	4
BAND,L=292.1 (Ref # 92072D)	92072-3509	1
CLAMP,DIA=20 (Ref # 92171)	92171-0081	3
CLAMP (Ref # 92171A)	92171-0476	1
CLAMP,DIA=10 (Ref # 92171B)	92171-1423	1
CLAMP,DIA=15 (Ref # 92171C)	92171-1424	1