

# 2025 MULE PRO-FXT 1000 LE Ranch Edition

## PARTS DIAGRAM

### Master Cylinder

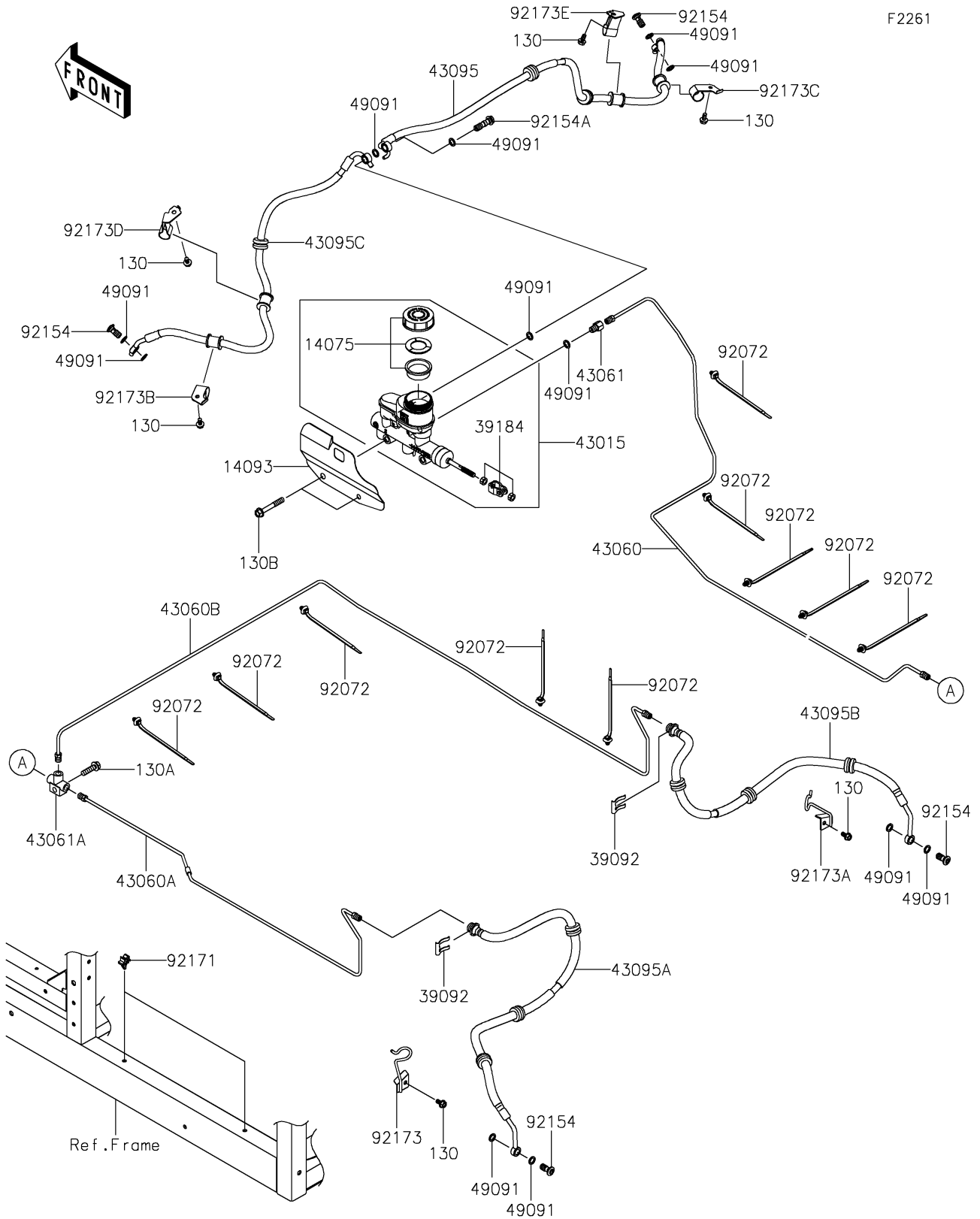

# 2025 MULE PRO-FXT 1000 LE Ranch Edition

## PARTS LIST

### Master Cylinder

| ITEM NAME                               | PART NUMBER | QUANTITY |
|---|-------------|----------|
| CAP-ASSY (Ref # 14075)                  | 14075-0038  | 1        |
| COVER,M/C BODY (Ref # 14093)            | 14093-1357  | 1        |
| PIN-HAIR (Ref # 39092)                  | 39092-1052  | 2        |
| BRACKET-ASSY (Ref # 39184)              | 39184-0031  | 1        |
| CYLINDER-ASSY-MASTER (Ref # 43015)      | 43015-0595  | 1        |
| PIPE-BRAKE (Ref # 43060)                | 43060-0360  | 1        |
| PIPE-BRAKE,LH (Ref # 43060A)            | 43060-0361  | 1        |
| PIPE-BRAKE,RH (Ref # 43060B)            | 43060-0362  | 1        |
| JOINT-BRAKE,M/C (Ref # 43061)           | 43061-0302  | 1        |
| JOINT-BRAKE (Ref # 43061A)              | 43061-1063  | 1        |
| HOSE-BRAKE,1068.5MM (Ref # 43095)       | 43095-1883  | 1        |
| HOSE-BRAKE,857MM (Ref # 43095A)         | 43095-1884  | 1        |
| HOSE-BRAKE,777MM (Ref # 43095B)         | 43095-1885  | 1        |
| HOSE-BRAKE,738.5MM (Ref # 43095C)       | 43095-1886  | 1        |
| WASHER-SEAL,10.1X14.5X1.5 (Ref # 49091) | 49091-0001  | 12       |
| BAND,OS170-FT7(BLACK) (Ref # 92072)     | 92072-1414  | 10       |
| BOLT,HEXALOBULAR,10X21 (Ref # 92154)    | 92154-1328  | 4        |
| BOLT,OIL,10X34.5 (Ref # 92154A)         | 92154-1398  | 1        |
| CLAMP (Ref # 92171)                     | 92171-0805  | 2        |
| CLAMP (Ref # 92173)                     | 92173-1217  | 1        |
| CLAMP (Ref # 92173A)                    | 92173-1218  | 1        |
| CLAMP (Ref # 92173B)                    | 92173-2571  | 1        |
| CLAMP (Ref # 92173C)                    | 92173-2572  | 1        |
| CLAMP (Ref # 92173D)                    | 92173-2651  | 1        |
| CLAMP (Ref # 92173E)                    | 92173-2652  | 1        |
| BOLT-FLANGED,6X12 (Ref # 130)           | 130BA0612   | 6        |
| BOLT-FLANGED,8X30 (Ref # 130A)          | 130BA0830   | 1        |
| BOLT-FLANGED,8X55 (Ref # 130B)          | 130BA0855   | 2        |