

# 2026 RIDGE HVAC Camo

## PARTS DIAGRAM

### Front Suspension

F2152

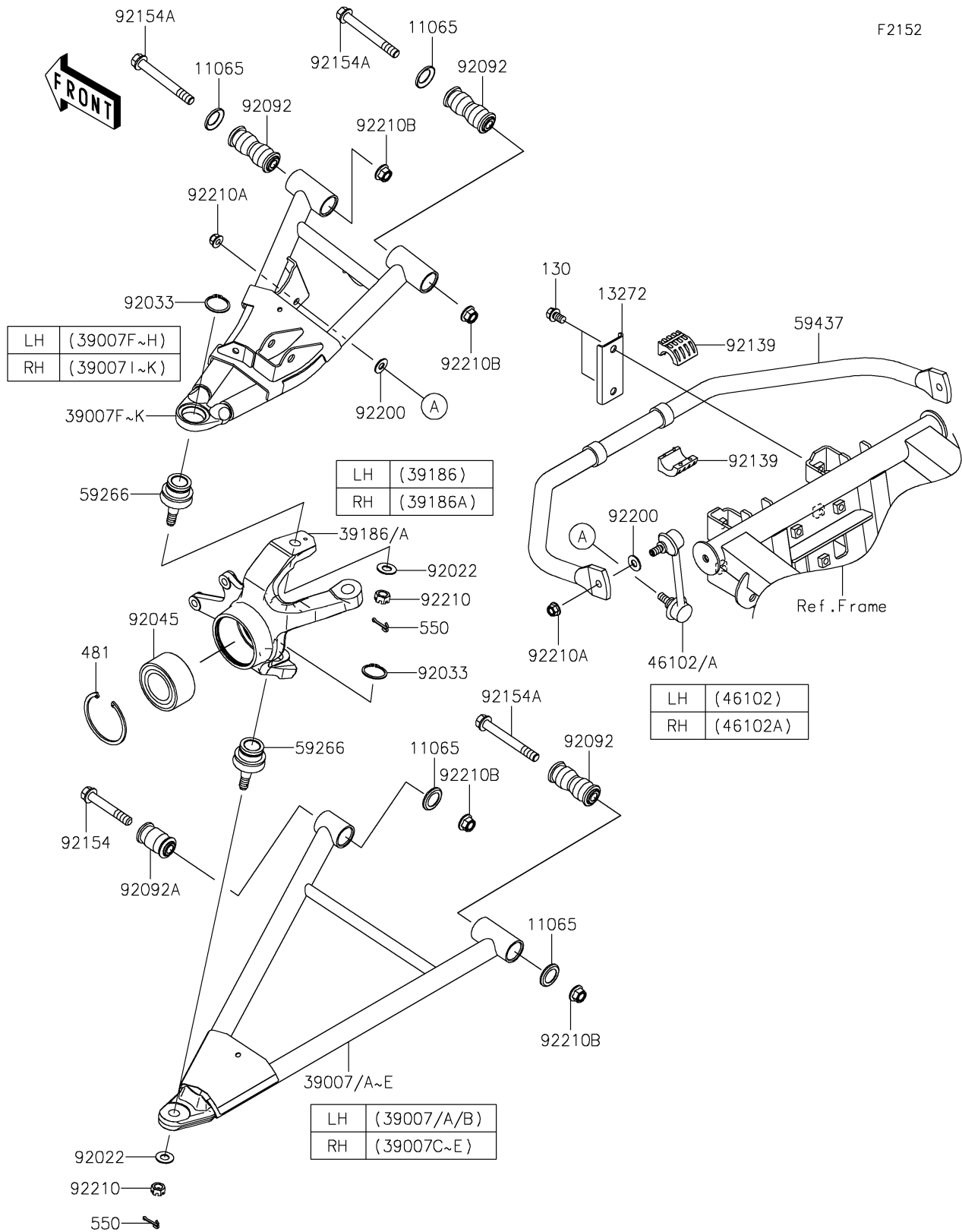

# 2026 RIDGE HVAC Camo

## PARTS LIST

### Front Suspension

ITEM NAME	PART NUMBER	QUANTITY
CAP,ARM (Ref # 11065)	11065-0838	8
PLATE,FR STABILIZER (Ref # 13272)	13272-7216	2
ARM-SUSP,FR,LWR,LH,BLACK (Ref # 39007)	39007-0489-10	1
ARM-SUSP,FR,LWR,LH,P.I.GRAY (Ref # 39007A)	39007-0489-72D	1
ARM-SUSP,FR,LWR,LH,P.W.BEIGE (Ref # 39007B)	39007-0489-75K	1
ARM-SUSP,FR,LWR,RH,BLACK (Ref # 39007C)	39007-0490-10	1
ARM-SUSP,FR,LWR,RH,P.I.GRAY (Ref # 39007D)	39007-0490-72D	1
ARM-SUSP,FR,LWR,RH,P.W.BEIGE (Ref # 39007E)	39007-0490-75K	1
ARM-SUSP,FR,UPP,LH,BLACK (Ref # 39007F)	39007-0528-10	1
ARM-SUSP,FR,UPP,LH,P.I.GRAY (Ref # 39007G)	39007-0528-72D	1
ARM-SUSP,FR,UPP,LH,P.W.BEIGE (Ref # 39007H)	39007-0528-75K	1
ARM-SUSP,FR,UPP,RH,BLACK (Ref # 39007I)	39007-0529-10	1
ARM-SUSP,FR,UPP,RH,P.I.GRAY (Ref # 39007J)	39007-0529-72D	1
ARM-SUSP,FR,UPP,RH,P.W.BEIGE (Ref # 39007K)	39007-0529-75K	1
KNUCKLE,FR,LH (Ref # 39186)	39186-0335	1
KNUCKLE,FR,RH (Ref # 39186A)	39186-0336	1
ROD,STABILIZER,LH (Ref # 46102)	46102-0689	1
ROD,STABILIZER,RH (Ref # 46102A)	46102-0690	1
JOINT-BALL (Ref # 59266)	59266-0711	4
STABILIZER,FR (Ref # 59437)	59437-0036	1
WASHER (Ref # 92022)	92022-1831	4
RING-SNAP,C-TYPE,32MM (Ref # 92033)	92033-1262	4
BEARING-BALL,40X74X36 (Ref # 92045)	92045-0919	2
BUSHING-RUBBER,12X20X78 (Ref # 92092)	92092-0028	6
BUSHING-RUBBER (Ref # 92092A)	92092-0555	2
BUSHING (Ref # 92139)	92139-1352	4
BOLT,FLANGED,12X76.5 (Ref # 92154)	92154-7079	2
BOLT,FLANGED,12X100 (Ref # 92154A)	92154-7081	6
WASHER,10.3X23X1.6 (Ref # 92200)	92200-0724	4

# 2026 RIDGE HVAC Camo

## PARTS LIST

### Front Suspension

ITEM NAME	PART NUMBER	QUANTITY
NUT,CASTLE,12MM (Ref # 92210)	92210-0395	4
NUT,LOCK,FLANGED,10MM (Ref # 92210A)	92210-1080	4
NUT,LOCK,FLANGED,12MM (Ref # 92210B)	92210-1931	8
BOLT-FLANGED,10X16 (Ref # 130)	130CA1016	4
CIRCLIP-TYPE-C (Ref # 481)	481J7500	2
PIN-COTTER,3.0X25 (Ref # 550)	550AA3025	4