

# 2026 BRUTE FORCE® 300

## PARTS DIAGRAM

### Front Hub

F2230

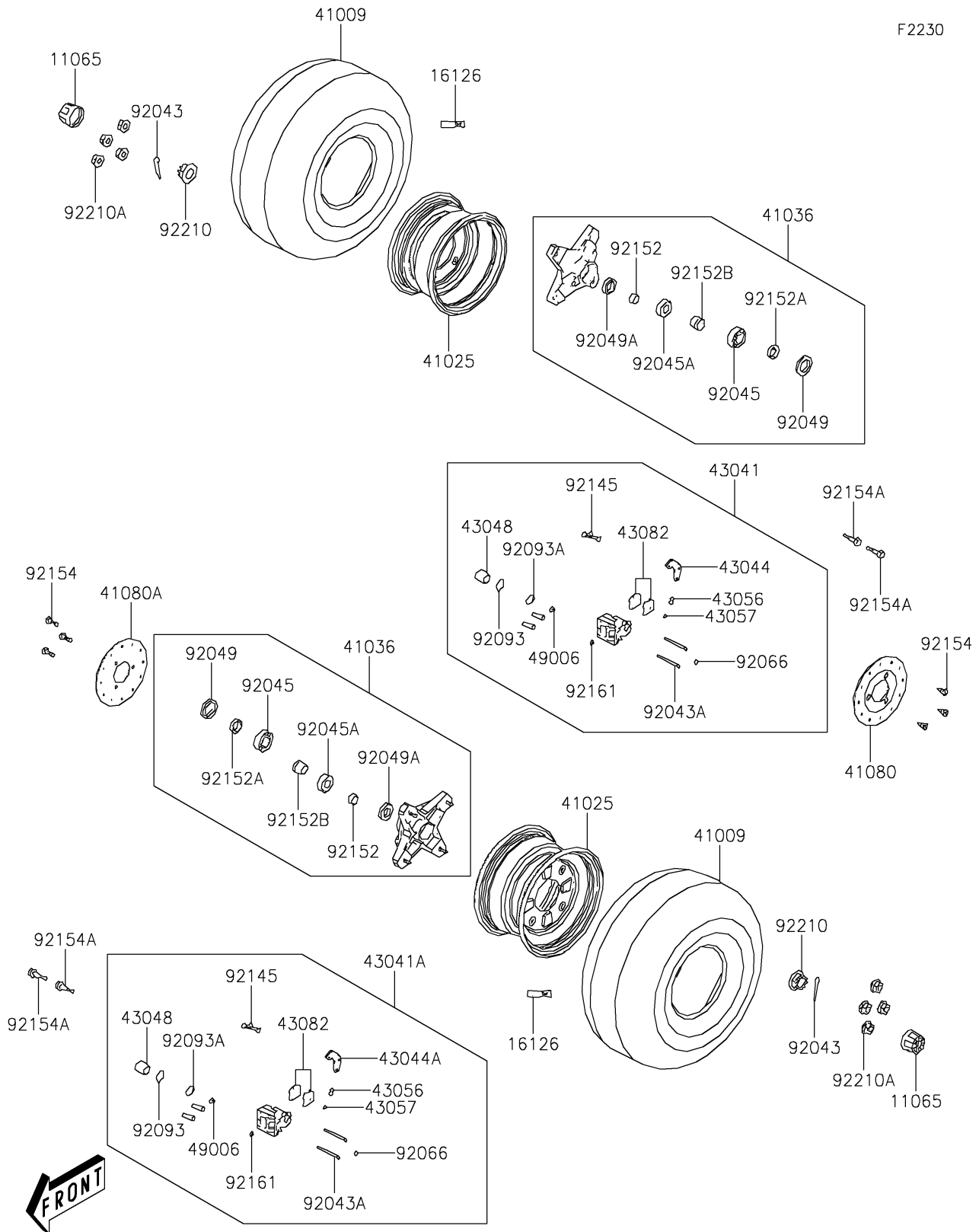

# 2026 BRUTE FORCE® 300

## PARTS LIST

### Front Hub

ITEM NAME	PART NUMBER	QUANTITY
CAP,WHEEL (Ref # 11065)	11065-Y015	2
VALVE,RIM (Ref # 16126)	16126-Y001	2
TIRE,FR (Ref # 41009)	41009-Y004	2
RIM,FR,BLACK (Ref # 41025)	41025-Y004-935	2
HUB-ASSY,FR (Ref # 41036)	41036-Y004	2
DISC,FR,RH (Ref # 41080)	41080-Y002	1
DISC,FR,LH (Ref # 41080A)	41080-Y003	1
CALIPER-ASSY,FR,RH (Ref # 43041)	43041-Y002	1
CALIPER-ASSY,FR,LH (Ref # 43041A)	43041-Y003	1
HOLDER-COMP-CALIPER,FR (Ref # 43044)	43044-Y001	1
HOLDER-COMP-CALIPER,FR,LH (Ref # 43044A)	43044-Y005	1
PISTON-CALIPER (Ref # 43048)	43048-Y002	2
BREATHER-BRAKE (Ref # 43056)	43056-Y001	2
CAP-BREATHER (Ref # 43057)	43057-Y001	2
PAD-ASSY-BRAKE (Ref # 43082)	43082-Y003	2
BOOT,CALIPER (Ref # 49006)	49006-Y005	2
PIN,3X25 (Ref # 92043)	92043-Y011	2
PIN,HANGER (Ref # 92043A)	92043-Y019	4
BEARING-BALL,6004 (Ref # 92045)	92045-Y024	2
BEARING-BALL,6202 (Ref # 92045A)	92045-Y025	2
SEAL-OIL,28X42X7 (Ref # 92049)	92049-Y016	2
SEAL-OIL,20X35X7 (Ref # 92049A)	92049-Y017	2
PLUG (Ref # 92066)	92066-Y001	2
SEAL,DUST (Ref # 92093)	92093-Y005	2
SEAL,PISTON (Ref # 92093A)	92093-Y006	2
SPRING,PAD (Ref # 92145)	92145-Y035	2
COLLAR (Ref # 92152)	92152-Y020	2
COLLAR (Ref # 92152A)	92152-Y021	2
COLLAR (Ref # 92152B)	92152-Y022	2

# 2026 BRUTE FORCE® 300

## PARTS LIST

### Front Hub

ITEM NAME	PART NUMBER	QUANTITY
BOLT,8X24 (Ref # 92154)	92154-Y025	6
BOLT,FLANGE,8X20 (Ref # 92154A)	92154-Y226	4
DAMPER (Ref # 92161)	92161-Y012	2
NUT,14MM (Ref # 92210)	92210-Y025	2
NUT,10MM (Ref # 92210A)	92210-Y044	8