

2026 Teryx4 H2

PARTS DIAGRAM

Transmission

E1361

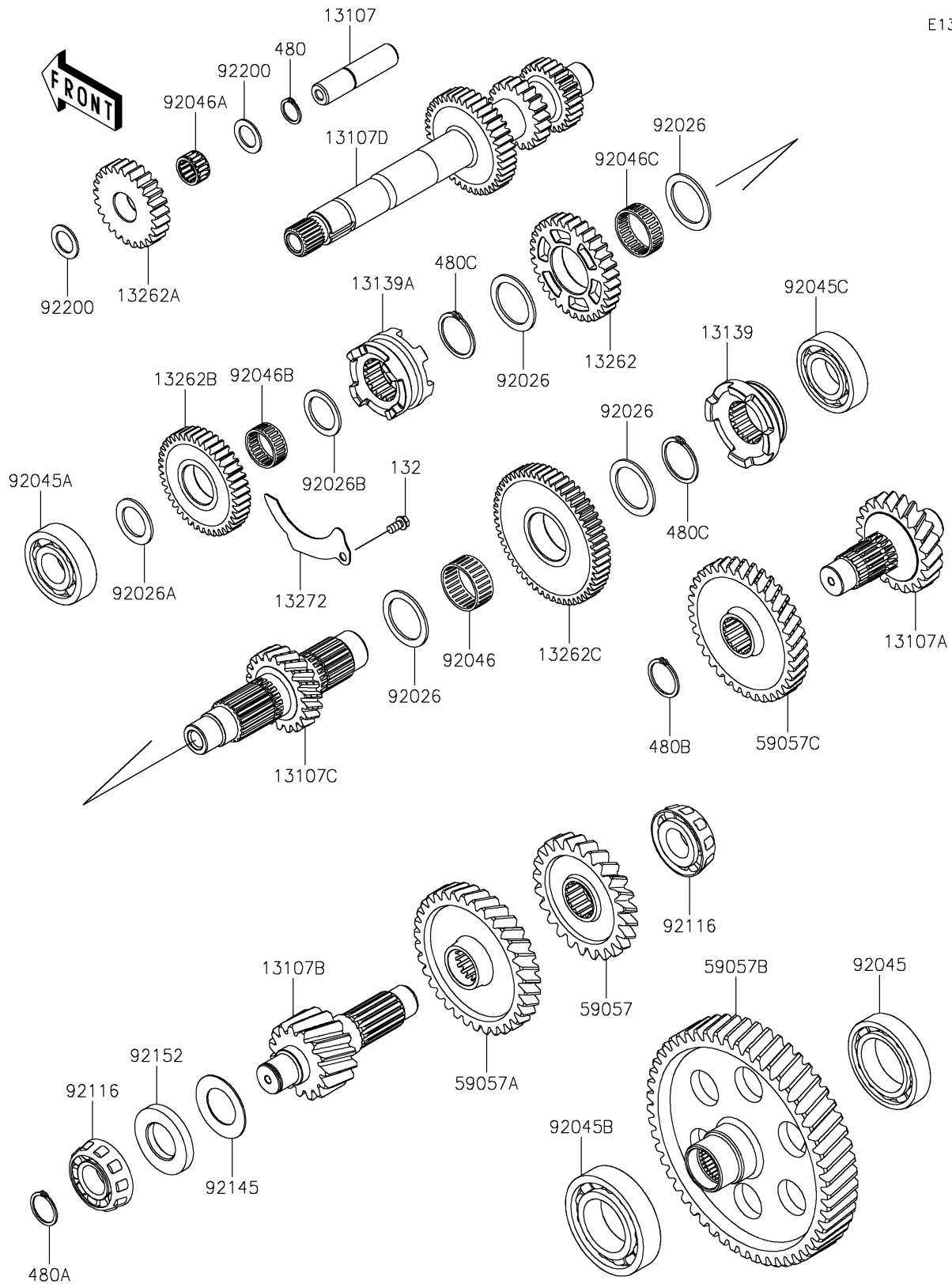

2026 Teryx4 H2

PARTS LIST

Transmission

ITEM NAME	PART NUMBER	QUANTITY
SHAFT,REVERSE IDLER (Ref # 13107)	13107-0879	1
SHAFT,3RD,21T (Ref # 13107A)	13107-1538	1
SHAFT,4TH,15T (Ref # 13107B)	13107-1539	1
SHAFT,2ND,20T (Ref # 13107C)	13107-1569	1
SHAFT,INPUT (Ref # 13107D)	13107-1606	1
SHIFTER,LOW,19T (Ref # 13139)	13139-0030	1
SHIFTER,HIGH&REV,19T (Ref # 13139A)	13139-0037	1
GEAR,REV,32T (Ref # 13262)	13262-1364	1
GEAR,REVERSE IDLER,25T (Ref # 13262A)	13262-1567	1
GEAR,HIGH,41T (Ref # 13262B)	13262-1673	1
GEAR,LOW,55T (Ref # 13262C)	13262-1674	1
PLATE,OIL (Ref # 13272)	13272-2570	1
GEAR-HELICAL,24T (Ref # 59057)	59057-0037	1
GEAR-HELICAL,4TH,34T (Ref # 59057A)	59057-0050	1
GEAR-HELICAL,FINAL,53T (Ref # 59057B)	59057-0711	1
GEAR-HELICAL,3RD,36T (Ref # 59057C)	59057-0716	1
SPACER,35.2X47X2 (Ref # 92026)	92026-0765	4
SPACER,25.2X38X2 (Ref # 92026A)	92026-0856	1
SPACER,28X38X2 (Ref # 92026B)	92026-1299	1
BEARING-BALL,6009 (Ref # 92045)	92045-0903	1
BEARING-BALL,6305ZUR3 (Ref # 92045A)	92045-0926	1
BEARING-BALL,TMB209 (Ref # 92045B)	92045-0935	1
BEARING-BALL,30X62X16,6206RSH2 (Ref # 92045C)	92045-1000	1
BEARING-NEEDLE,35X40X17 (Ref # 92046)	92046-0611	1
BEARING-NEEDLE (Ref # 92046A)	92046-0634	1
BEARING-NEEDLE (Ref # 92046B)	92046-0635	1
BEARING-NEEDLE (Ref # 92046C)	92046-0636	1
BEARING-ROLLER,HC30305JRLFT (Ref # 92116)	92116-0012	2
SPRING (Ref # 92145)	92145-1837	1

2026 Teryx4 H2

PARTS LIST

Transmission

ITEM NAME	PART NUMBER	QUANTITY
COLLAR (Ref # 92152)	92152-2526	1
WASHER,18.2X28X1.5 (Ref # 92200)	92200-0716	2
BOLT-FLANGED-SMALL,6X12 (Ref # 132)	132BA0612	1
CIRCLIP-TYPE-C,18MM (Ref # 480)	480J1800	1
CIRCLIP-TYPE-C,25MM (Ref # 480A)	480J2500	1
CIRCLIP (Ref # 480B)	480J2900	1
CIRCLIP (Ref # 480C)	480J3500	2