

# 2024 MULE PRO-MX™ EPS CAMO

## PARTS DIAGRAM

### Drive Shaft-Rear

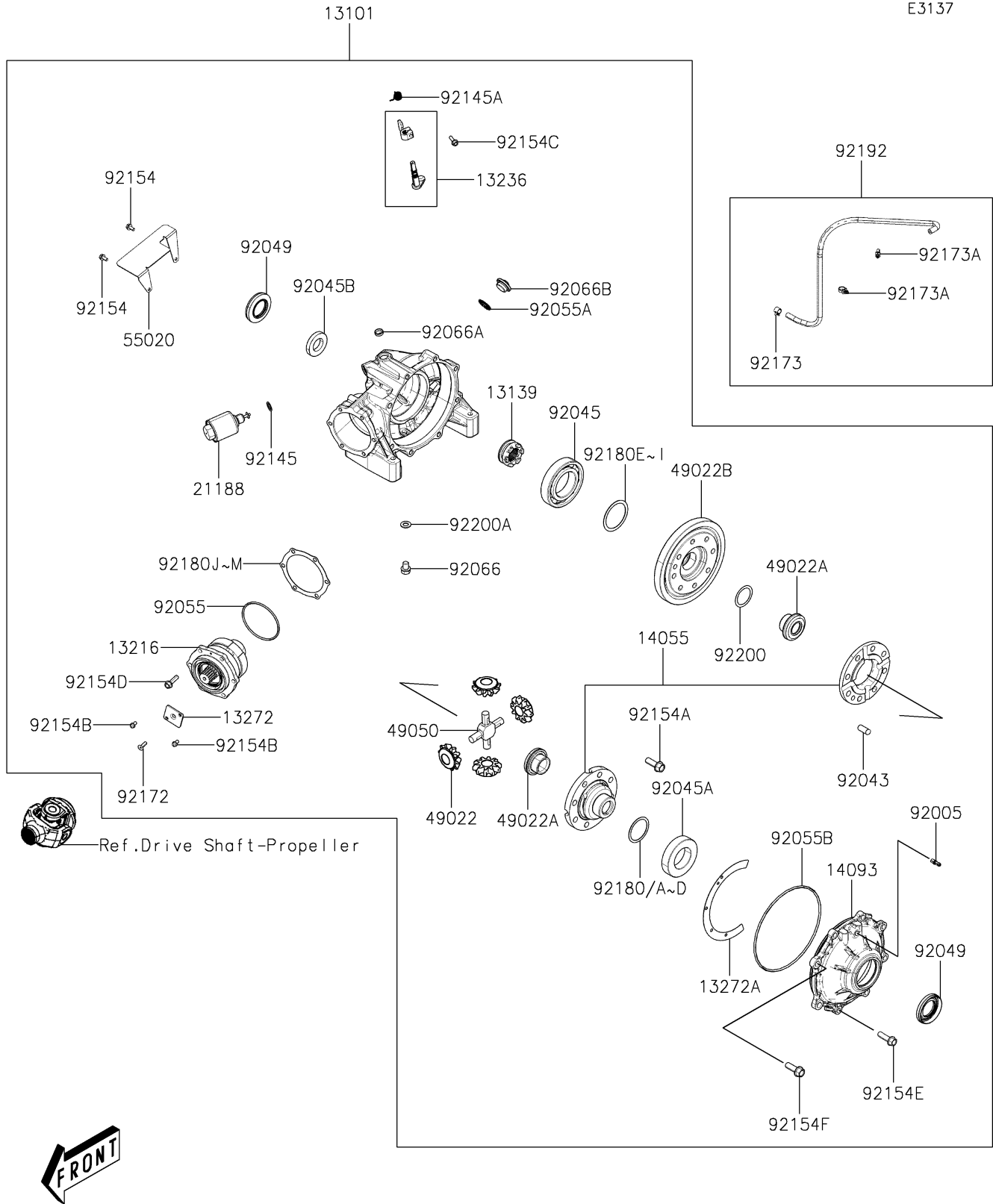

# 2024 MULE PRO-MX™ EPS CAMO

## PARTS LIST

### Drive Shaft-Rear

ITEM NAME	PART NUMBER	QUANTITY
GEAR-ASSY,RR (Ref # 13101)	13101-Y003	1
SHIFTER (Ref # 13139)	13139-Y005	1
GEAR-COMP (Ref # 13216)	13216-Y008	1
LEVER-COMP (Ref # 13236)	13236-Y001	1
PLATE (Ref # 13272)	13272-Y037	1
PLATE (Ref # 13272A)	13272-Y038	1
CASE-GEAR,SET (Ref # 14055)	14055-Y006	1
COVER (Ref # 14093)	14093-Y049	1
SOLENOID (Ref # 21188)	21188-Y001	1
GEAR-BEVEL,10T (Ref # 49022)	49022-0572	4
GEAR-BEVEL,16T (Ref # 49022A)	49022-0622	2
GEAR-BEVEL,35T (Ref # 49022B)	49022-0628	1
SPIDER (Ref # 49050)	49050-Y002	1
GUARD,DIFF (Ref # 55020)	55020-Y009	1
FITTING (Ref # 92005)	92005-Y001	1
PIN (Ref # 92043)	92043-Y048	1
BEARING-BALL,6212 (Ref # 92045)	92045-0766	1
BEARING-BALL,6210CM (Ref # 92045A)	92045-1213	1
BEARING-BALL,16007 (Ref # 92045B)	92045-1230	1
SEAL-OIL,40X68X13.5 (Ref # 92049)	92049-0806	2
RING-O (Ref # 92055)	92055-Y067	1
RING-O (Ref # 92055A)	92055-Y068	1
RING-O (Ref # 92055B)	92055-Y069	1
PLUG,DRAIN (Ref # 92066)	92066-Y003	1
PLUG (Ref # 92066A)	92066-Y020	1
PLUG (Ref # 92066B)	92066-Y021	1
SPRING (Ref # 92145)	92145-Y069	1
SPRING (Ref # 92145A)	92145-Y070	1
BOLT,FLANGE,6X14 (Ref # 92154)	92154-Y153	2

# 2024 MULE PRO-MX™ EPS CAMO

## PARTS LIST

### Drive Shaft-Rear

ITEM NAME	PART NUMBER	QUANTITY
BOLT (Ref # 92154A)	92154-Y214	8
BOLT (Ref # 92154B)	92154-Y215	2
BOLT,FLANGE (Ref # 92154C)	92154-Y216	1
BOLT,FLANGE,8X30 (Ref # 92154D)	92154-Y218	6
BOLT,FLANGE,10X35 (Ref # 92154E)	92154-Y220	6
BOLT,FLANGE,12X35 (Ref # 92154F)	92154-Y221	2
SCREW (Ref # 92172)	92172-Y087	1
CLAMP,10.5 (Ref # 92173)	92173-Y023	1
CLAMP (Ref # 92173A)	92173-Y078	2
SHIM,T=1.2 (Ref # 92180)	92180-Y044	1
SHIM,T=1.5 (Ref # 92180A)	92180-Y045	1
SHIM,T=1.6 (Ref # 92180B)	92180-Y046	1
SHIM,T=1.3 (Ref # 92180C)	92180-Y047	1
SHIM,T=1.4 (Ref # 92180D)	92180-Y048	1
SHIM,T=1.0 (Ref # 92180E)	92180-Y050	1
SHIM,T=1.1 (Ref # 92180F)	92180-Y051	1
SHIM,T=1.2 (Ref # 92180G)	92180-Y052	1
SHIM,T=1.3 (Ref # 92180H)	92180-Y053	1
SHIM,T=1.4 (Ref # 92180I)	92180-Y054	1
SHIM,T=1.0 (Ref # 92180J)	92180-Y056	1
SHIM,T=0.1 (Ref # 92180K)	92180-Y057	1
SHIM,T=0.2 (Ref # 92180L)	92180-Y058	1
SHIM,T=0.3 (Ref # 92180M)	92180-Y059	1
TUBE,GEAR CASE (Ref # 92192)	92192-Y072	1
WASHER (Ref # 92200)	92200-Y098	1
WASHER (Ref # 92200A)	92200-Y099	1