

# 2023 MULE PRO-MX™ EPS CAMO

## PARTS DIAGRAM

### Cylinder Head

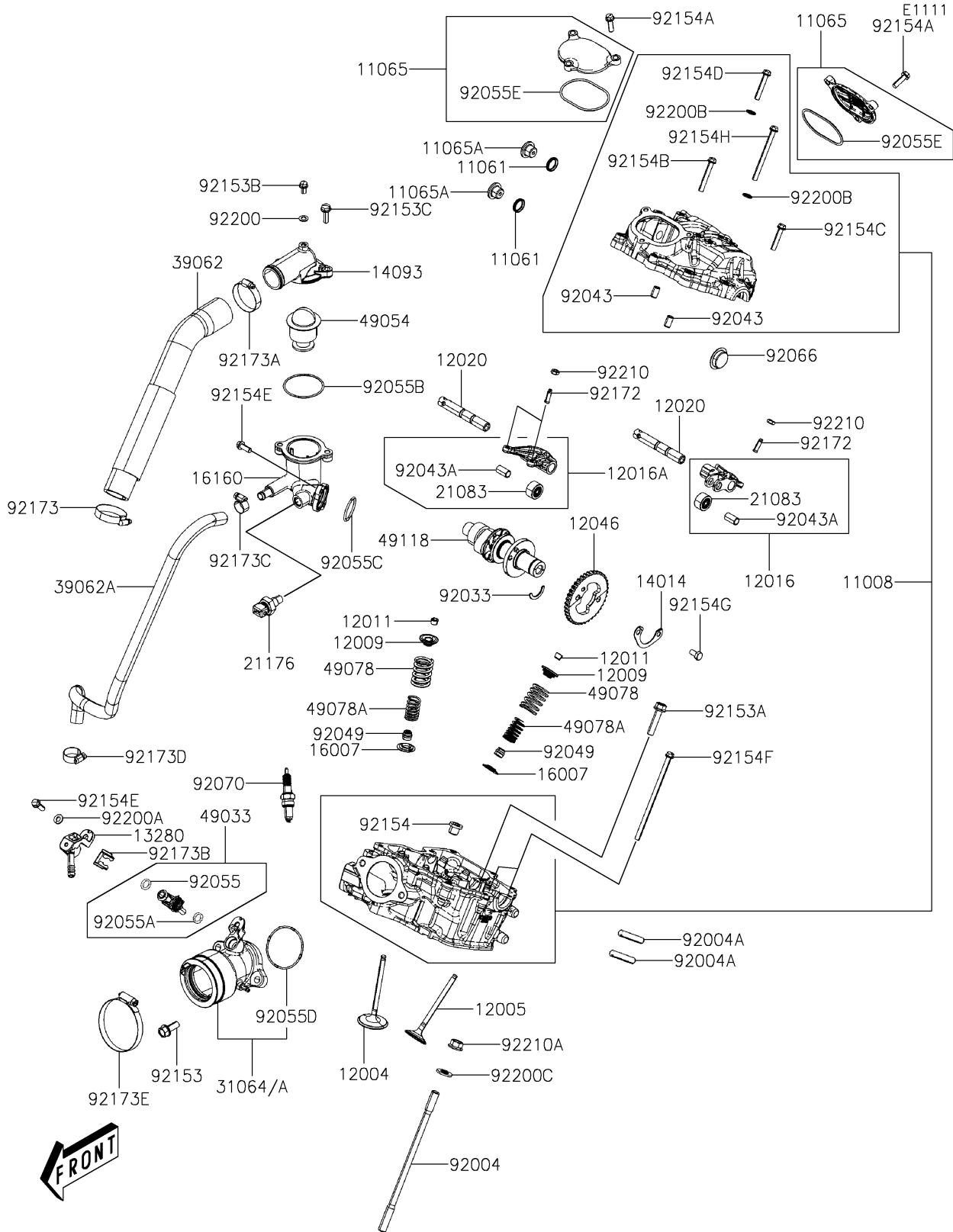

# 2023 MULE PRO-MX™ EPS CAMO

## PARTS LIST

### Cylinder Head

ITEM NAME	PART NUMBER	QUANTITY
HEAD-COMP-CYLINDER (Ref # 11008)	11008-Y008	1
GASKET (Ref # 11061)	11061-Y064	2
CAP (Ref # 11065)	11065-Y035	2
CAP (Ref # 11065A)	11065-Y041	2
VALVE-INTAKE (Ref # 12004)	12004-Y007	2
VALVE-EXHAUST (Ref # 12005)	12005-Y006	2
RETAINER-VALVE SPRING (Ref # 12009)	12009-Y003	4
COLLET (Ref # 12011)	12011-Y003	8
ARM-ROCKER,EXHAUST (Ref # 12016)	12016-Y008	1
ARM-ROCKER,INTAKE (Ref # 12016A)	12016-Y009	1
SHAFT-ROCKER (Ref # 12020)	12020-Y009	2
SPROCKET,CAMSHAFT (Ref # 12046)	12046-Y005	1
HOLDER (Ref # 13280)	13280-Y020	1
PLATE-POSITION (Ref # 14014)	14014-Y001	1
COVER,THERMOSTAT (Ref # 14093)	14093-Y006	1
SEAT-SPRING (Ref # 16007)	16007-Y006	4
BODY,THERMOSTAT (Ref # 16160)	16160-Y005	1
ARM,ROCKER (Ref # 21083)	21083-Y004	2
SENSOR,WATER TEMP (Ref # 21176)	21176-Y011	1
PIPE-COMP,INLET (Ref # 31064)	31064-Y009	1
PIPE-COMP,INLET (Ref # 31064A)	31064-Y019	1
HOSE-COOLING,ENGINE-PIPE (Ref # 39062)	39062-Y019	1
HOSE-COOLING,THRO (Ref # 39062A)	39062-Y020	1
NOZZLE-INJECTION (Ref # 49033)	49033-Y003	1
THERMOSTAT (Ref # 49054)	49054-Y004	1
SPRING-ENGINE VALVE,OUTER (Ref # 49078)	49078-Y009	4
SPRING-ENGINE VALVE,INNER (Ref # 49078A)	49078-Y010	4
CAMSHAFT-COMP (Ref # 49118)	49118-Y006	1
STUD (Ref # 92004)	92004-Y017	4

# 2023 MULE PRO-MX™ EPS CAMO

## PARTS LIST

### Cylinder Head

ITEM NAME	PART NUMBER	QUANTITY
STUD,8X38 (Ref # 92004A)	92004-Y018	2
RING-SNAP (Ref # 92033)	92033-Y030	1
PIN,8X14 (Ref # 92043)	92043-Y012	2
PIN,ROCKER ARM (Ref # 92043A)	92043-Y038	2
SEAL-OIL (Ref # 92049)	92049-Y042	4
RING-O,BLACK (Ref # 92055)	92055-Y053	1
RING-O,GREEN (Ref # 92055A)	92055-Y054	1
RING-O,48.3X2 (Ref # 92055B)	92055-Y059	1
RING-O,28.8X2.4 (Ref # 92055C)	92055-Y060	1
RING-O (Ref # 92055D)	92055-Y062	1
RING-O (Ref # 92055E)	92055-Y063	2
PLUG (Ref # 92066)	92066-Y018	1
PLUG-SPARK,CR7E (Ref # 92070)	92070-Y004	1
BOLT,FLANGE,8X20 (Ref # 92153)	92153-Y033	2
BOLT,FLANGE,8X35 (Ref # 92153A)	92153-Y034	1
BOLT,FLANGE,6X10 (Ref # 92153B)	92153-Y045	1
BOLT,FLANGE,6X20 (Ref # 92153C)	92153-Y049	2
BOLT,SEALING,12MM (Ref # 92154)	92154-Y009	1
BOLT,6X20 (Ref # 92154A)	92154-Y057	6
BOLT,FLANGE,6X35 (Ref # 92154B)	92154-Y069	2
BOLT,FLANGE,6X30 (Ref # 92154C)	92154-Y107	6
BOLT,FLANGE,6X32 (Ref # 92154D)	92154-Y128	2
BOLT,FLANGE,6X16 (Ref # 92154E)	92154-Y134	3
BOLT,FLANGE,6X120 (Ref # 92154F)	92154-Y159	2
BOLT,HEX,6X12 (Ref # 92154G)	92154-Y189	2
BOLT,FLANGE,6X70 (Ref # 92154H)	92154-Y229	4
SCREW (Ref # 92172)	92172-Y081	4
CLAMP,28.6MM (Ref # 92173)	92173-1205	1
CLAMP (Ref # 92173A)	92173-1892	1

# 2023 MULE PRO-MX™ EPS CAMO

## PARTS LIST

### Cylinder Head

ITEM NAME	PART NUMBER	QUANTITY
CLAMP,INJECTOR (Ref # 92173B)	92173-Y053	1
CLAMP (Ref # 92173C)	92173-Y067	1
CLAMP (Ref # 92173D)	92173-Y068	1
CLAMP (Ref # 92173E)	92173-Y075	1
WASHER,6MM (Ref # 92200)	92200-Y024	1
WASHER,6MM (Ref # 92200A)	92200-Y042	1
WASHER (Ref # 92200B)	92200-Y084	6
WASHER,21X10X2.2 (Ref # 92200C)	92200-Y088	4
NUT (Ref # 92210)	92210-Y004	4
NUT,FLANGE,10MM (Ref # 92210A)	92210-Y058	4