

2000 Ninja[®] ZX[™]-7R

PARTS DIAGRAM

Front Fork

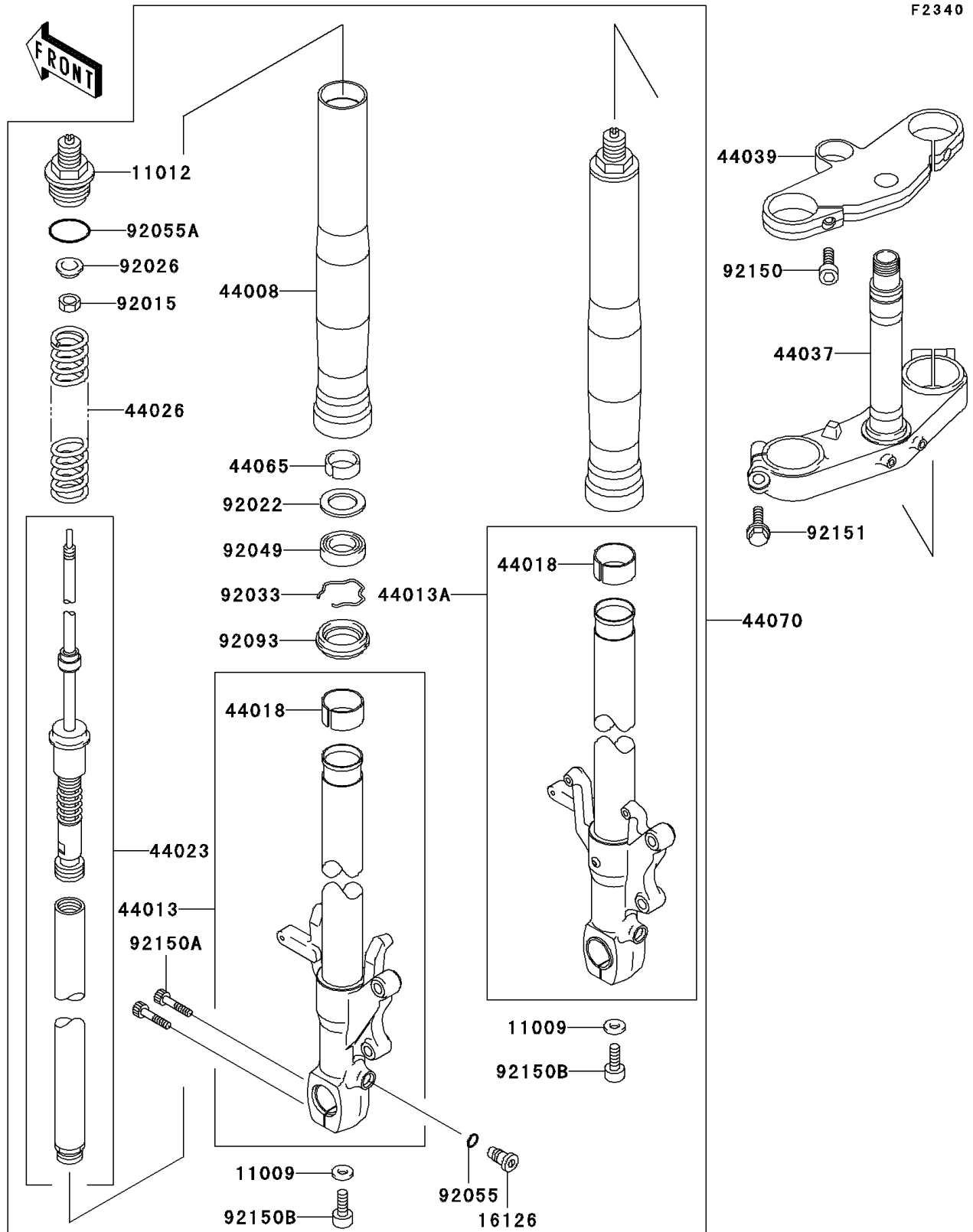

2000 Ninja® ZX™-7R

PARTS LIST

Front Fork

| ITEM NAME | PART NUMBER | QUANTITY |
|--|---------------|----------|
| GASKET,FORK CYLINDER BOLT (Ref # 11009) | 11009-1127 | 2 |
| CAP,FORK TOP (Ref # 11012) | 11012-1792 | 2 |
| VALVE,FORK (Ref # 16126) | 16126-1261 | 2 |
| PIPE-FORK OUTER,A.BRONZE (Ref # 44008) | 44008-1039-JS | 2 |
| PIPE-FORK INNER,LH,SILVER (Ref # 44013) | 44013-1415-KF | 1 |
| PIPE-FORK INNER,RH,SILVER (Ref # 44013A) | 44013-1416-KF | 1 |
| PISTON-FORK,INNER PIPE (Ref # 44018) | 44018-1056 | 2 |
| CYLINDER-COMP-FORK (Ref # 44023) | 44023-1098 | 2 |
| SPRING-FRONT FORK (Ref # 44026) | 44026-1593 | 2 |
| HOLDER-FORK UNDER (Ref # 44037) | 44037-1339 | 1 |
| HOLDER-FORK UPPER (Ref # 44039) | 44039-1264 | 1 |
| BUSHING-FRONT FORK (Ref # 44065) | 44065-1111 | 2 |
| DAMPER-ASSY,FORK,SILVER (Ref # 44070) | 44070-1490-KF | 1 |
| NUT (Ref # 92015) | 92015-1795 | 2 |
| WASHER (Ref # 92022) | 92022-1299 | 2 |
| SPACER,FORK (Ref # 92026) | 92026-1471 | 2 |
| RING-SNAP (Ref # 92033) | 92033-1077 | 2 |
| SEAL-OIL,FORK OUTER TUBE (Ref # 92049) | 92049-1456 | 2 |
| RING-O,ANTI-DIVE UNIT (Ref # 92055) | 92055-1201 | 2 |
| RING-O,FORK,AIR TUBE (Ref # 92055A) | 92055-1333 | 2 |
| SEAL,FORK OUTER TUBE (Ref # 92093) | 92093-1415 | 2 |
| BOLT,SOCKET,8X25 (Ref # 92150) | 92150-1172 | 2 |
| BOLT,SOCKET,8X40 (Ref # 92150A) | 92150-1194 | 4 |
| BOLT,12X22 (Ref # 92150B) | 92150-1398 | 2 |
| BOLT,FLANGED,10X40 (Ref # 92151) | 92151-1171 | 2 |