

# 2022 Teryx<sup>®</sup> S

## PARTS DIAGRAM

### Master Cylinder



F2261

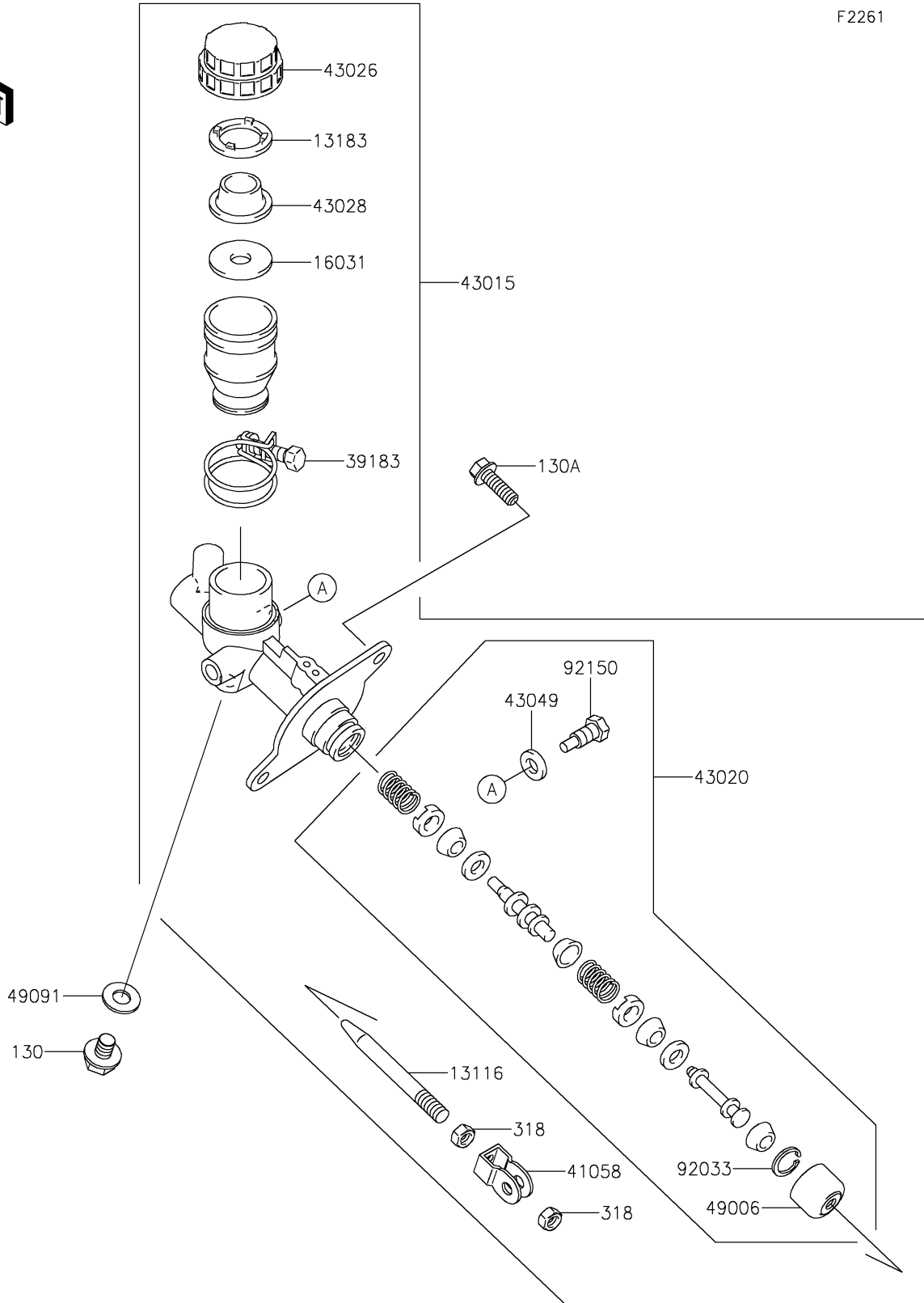

# 2022 Teryx<sup>®</sup> S

## PARTS LIST

### Master Cylinder

| ITEM NAME                               | PART NUMBER | QUANTITY |
|---|-------------|----------|
| ROD-PUSH (Ref # 13116)                  | 13116-1134  | 1        |
| PLATE (Ref # 13183)                     | 13183-1306  | 1        |
| FLOAT (Ref # 16031)                     | 16031-1069  | 1        |
| BAND-ASSY (Ref # 39183)                 | 39183-1055  | 1        |
| RODEND-BRAKE (Ref # 41058)              | 41058-1057  | 1        |
| CYLINDER-ASSY-MASTER (Ref # 43015)      | 43015-1683  | 1        |
| PISTON-COMP-BRAKE (Ref # 43020)         | 43020-1124  | 1        |
| CAP-BRAKE (Ref # 43026)                 | 43026-1067  | 1        |
| DIAPHRAGM (Ref # 43028)                 | 43028-1078  | 1        |
| PACKING (Ref # 43049)                   | 43049-1065  | 1        |
| BOOT (Ref # 49006)                      | 49006-1245  | 1        |
| WASHER-SEAL,10.1X14.5X1.5 (Ref # 49091) | 49091-0001  | 1        |
| RING-SNAP (Ref # 92033)                 | 92033-1255  | 1        |
| BOLT,STOP (Ref # 92150)                 | 92150-1165  | 1        |
| BOLT-FLANGED,10X12 (Ref # 130)          | 130AA1012   | 1        |
| BOLT-FLANGED,8X25 (Ref # 130A)          | 130BA0825   | 2        |
| NUT-HEX-SMALL,8MM (Ref # 318)           | 318BA0800   | 2        |