

# 2001 Ninja<sup>®</sup> ZX<sup>™</sup>-6R

## PARTS DIAGRAM

### Cowling(ZX600-J2)

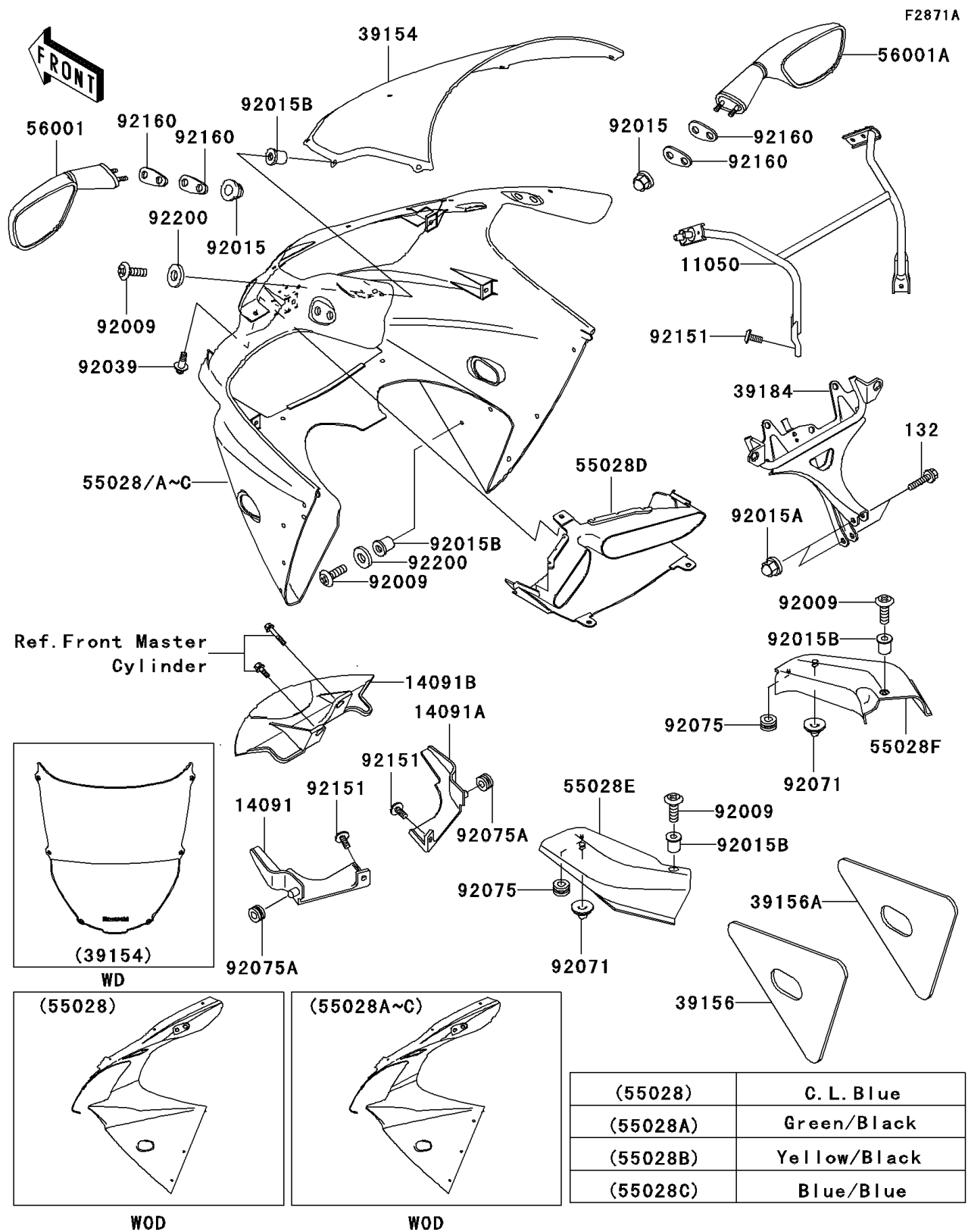

# 2001 Ninja® ZX™-6R

## PARTS LIST

### Cowling(ZX600-J2)

| ITEM NAME                               | PART NUMBER   | QUANTITY |
|---|---------------|----------|
| BOLT-FLANGED-SMALL (Ref # 132)          | 132J0830      | 2        |
| BRACKET,MIRROR (Ref # 11050)            | 11050-1640    | 1        |
| COVER,RADIATOR,LH (Ref # 14091)         | 14091-1170    | 1        |
| COVER,RADIATOR,RH (Ref # 14091A)        | 14091-1171    | 1        |
| COVER,UNDER BRACKET (Ref # 14091B)      | 14091-1271    | 1        |
| WINDSHIELD (Ref # 39154)                | 39154-5013    | 1        |
| PAD,UPP COWLING,LH (Ref # 39156)        | 39156-1622    | 1        |
| PAD,UPP COWLING,RH (Ref # 39156A)       | 39156-1623    | 1        |
| BRACKET-ASSY,MAIN (Ref # 39184)         | 39184-1085    | 1        |
| COWLING,UPP,GREEN/BLACK (Ref # 55028A)  | 55028-1390-3I | 1        |
| COWLING,UPP,YELLOW/BLACK (Ref # 55028B) | 55028-1390-4I | 1        |
| COWLING,DUCT,M.F.C.GRAY (Ref # 55028D)  | 55028-1391-3L | 1        |
| COWLING,INNER,LH (Ref # 55028E)         | 55028-1394    | 1        |
| COWLING,INNER,RH (Ref # 55028F)         | 55028-1395    | 1        |
| MIRROR-ASSY,LH (Ref # 56001)            | 56001-1483    | 1        |
| MIRROR-ASSY,RH (Ref # 56001A)           | 56001-1484    | 1        |
| SCREW,5X16 (Ref # 92009)                | 92009-1909    | 10       |
| NUT,CAP,6MM,BLACK (Ref # 92015)         | 92015-1170    | 4        |
| NUT,CAP,8MM,BLACK (Ref # 92015A)        | 92015-1174    | 2        |
| NUT,WELL,5MM (Ref # 92015B)             | 92015-1757    | 10       |
| RIVET (Ref # 92039)                     | 92039-1227    | 1        |
| GROMMET (Ref # 92071)                   | 92071-1222    | 2        |
| DAMPER (Ref # 92075)                    | 92075-1067    | 2        |
| DAMPER (Ref # 92075A)                   | 92075-1912    | 2        |
| BOLT,SOCKET,6X14 (Ref # 92151)          | 92151-1654    | 4        |
| DAMPER,MIRROR (Ref # 92160)             | 92160-1089    | 4        |
| WASHER,NYLON,5.3X11.5X0.5 (Ref # 92200) | 92200-1480    | 8        |
| COWLING,UPP,C.L.BLUE (Ref # 55028)      | 55028-1390-E1 | 1        |
| COWLING,UPP,BLUE/BLUE (Ref # 55028C)    | 55028-1390-5I | 1        |