

# 2025 Z900 ABS

## PARTS DIAGRAM

### Chassis Electrical Equipment

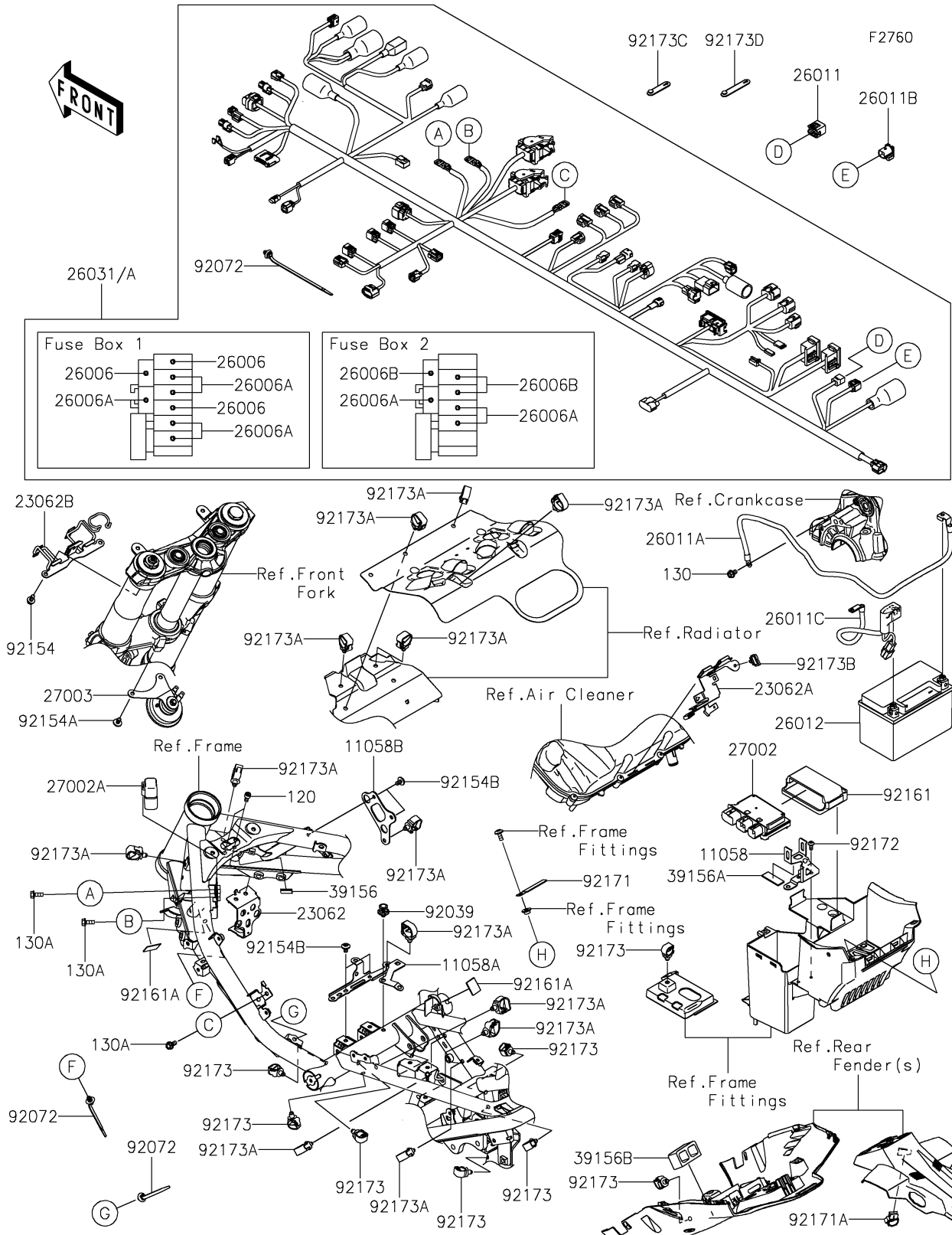

# 2025 Z900 ABS

## PARTS LIST

### Chassis Electrical Equipment

ITEM NAME	PART NUMBER	QUANTITY
BRACKET,MAGNETIC SWITCH (Ref # 11058)	11058-1828	1
BRACKET (Ref # 11058A)	11058-1829	1
BRACKET,IMU (Ref # 11058B)	11058-1832	1
BRACKET-COMP,VDS (Ref # 23062)	23062-1544	1
BRACKET-COMP,A/C BOX (Ref # 23062A)	23062-1545	1
BRACKET-COMP,FORK UPPER HOLDER (Ref # 23062B)	23062-1546	1
FUSE,MINI BLADE,15A,BLUE (Ref # 26006)	26006-0001	3
FUSE,MINI BLADE,10A,RED (Ref # 26006A)	26006-1078	8
FUSE,MINI BLADE,30A,GREEN (Ref # 26006B)	26006-1080	3
WIRE-LEAD,CONNECTOR COVER (Ref # 26011)	26011-0275	1
WIRE-LEAD,BATTERY(-) (Ref # 26011A)	26011-0972	1
WIRE-LEAD,DIAG CONNECTOR (Ref # 26011B)	26011-1901	1
WIRE-LEAD,BATTERY(+) (Ref # 26011C)	26011-2483	1
BATTERY,FTX9-BS,12V 8AH (Ref # 26012)	26012-0608	1
HARNESS,MAIN (Ref # 26031)	26031-7051	1
HARNESS,MAIN (Ref # 26031A)	26031-7052	1
RELAY-ASSY (Ref # 27002)	27002-0061	1
RELAY-ASSY (Ref # 27002A)	27002-1086	1
HORN (Ref # 27003)	27003-0121	1
PAD,20X20X1 (Ref # 39156)	39156-2288	1
PAD,40X15X2 (Ref # 39156A)	39156-2639	1
PAD,DIAG CONNECTOR (Ref # 39156B)	39156-2904	1
RIVET,HOLE 8MM (Ref # 92039)	92039-0014	1
BAND,OS170-FT7(BLACK) (Ref # 92072)	92072-1414	AR
BOLT,FLANGED,6X12 (Ref # 92154)	92154-1050	2
BOLT,SOCKET,6X10 (Ref # 92154A)	92154-2667	2
BOLT,SOCKET,6X10 (Ref # 92154B)	92154-4298	4
DAMPER,RELAY BOX (Ref # 92161)	92161-0203	1
DAMPER,25X40,T1.0 (Ref # 92161A)	92161-1432	2

# 2025 Z900 ABS

## PARTS LIST

### Chassis Electrical Equipment

ITEM NAME	PART NUMBER	QUANTITY
CLAMP,L=60 (Ref # 92171)	92171-0652	1
CLAMP,EDGE CLIP (Ref # 92171A)	92171-1722	1
SCREW,SOCKET,5X14 (Ref # 92172)	92172-0823	2
CLAMP,12MM DIA. (Ref # 92173)	92173-0736	8
CLAMP (Ref # 92173A)	92173-0861	14
CLAMP,CLIP,TAIL LAMP,ETC (Ref # 92173B)	92173-1429	1
CLAMP (Ref # 92173C)	92173-2198	2
CLAMP (Ref # 92173D)	92173-2199	5
BOLT-SOCKET,6X12 (Ref # 120)	120CA0612	2
BOLT-FLANGED,6X10 (Ref # 130)	130BA0610	1
BOLT-FLANGED,6X16 (Ref # 130A)	130BA0616	3