

# 1997 Vulcan 800 Classic

## PARTS DIAGRAM

### Headlight(s)

F2710

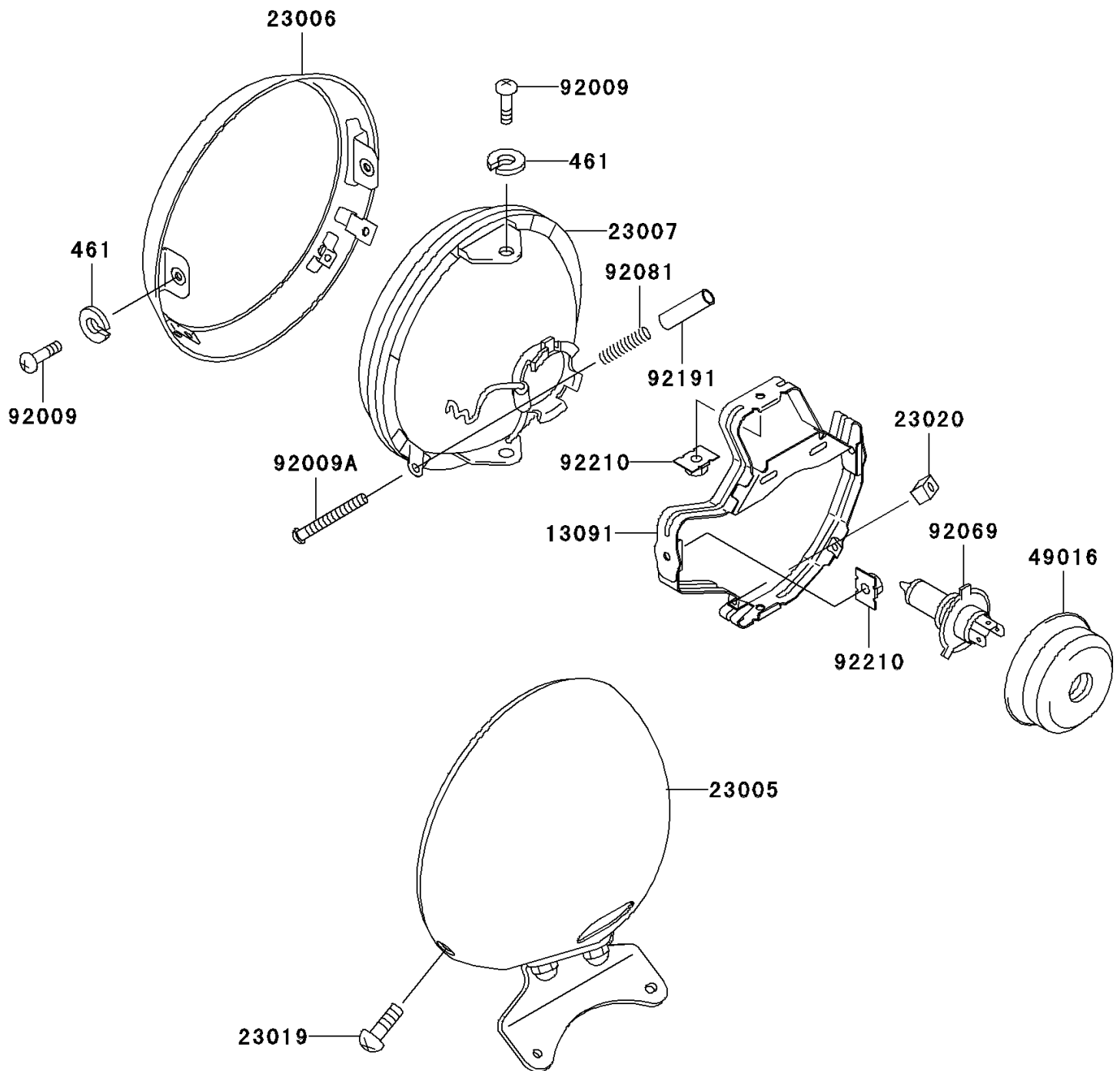

# 1997 Vulcan 800 Classic

## PARTS LIST

### Headlight(s)

ITEM NAME	PART NUMBER	QUANTITY
WASHER-SPRING,5MM (Ref # 461)	461F0500	4
HOLDER,HEAD LAMP (Ref # 13091)	13091-1948	1
BODY-COMP-HEAD LAMP (Ref # 23005)	23005-1152	1
RIM-LAMP (Ref # 23006)	23006-1071	1
LENS-COMP,HEAD LAMP (Ref # 23007)	23007-1338	1
SCREW,SPECIAL,5X14 (Ref # 23019)	23019-024	2
NUT,4MM,FOCUS ADJUST (Ref # 23020)	23020-018	2
COVER-SEAL,HEAD LAMP (Ref # 49016)	49016-1046	1
SCREW,5X12 (Ref # 92009)	92009-1296	4
SCREW,FOCUS ADJUST,4X60 (Ref # 92009A)	92009-1816	2
BULB,12V 60/55W,H4 (Ref # 92069)	92069-1002	1
SPRING,HEAD LAMP LENS (Ref # 92081)	92081-1103	2
TUBE,3.5X4.5X19 (Ref # 92191)	92191-1217	2
NUT,SPECIAL,5MM (Ref # 92210)	92210-1060	4