

2022 KLR® 650 TRAVELER

PARTS DIAGRAM

Frame

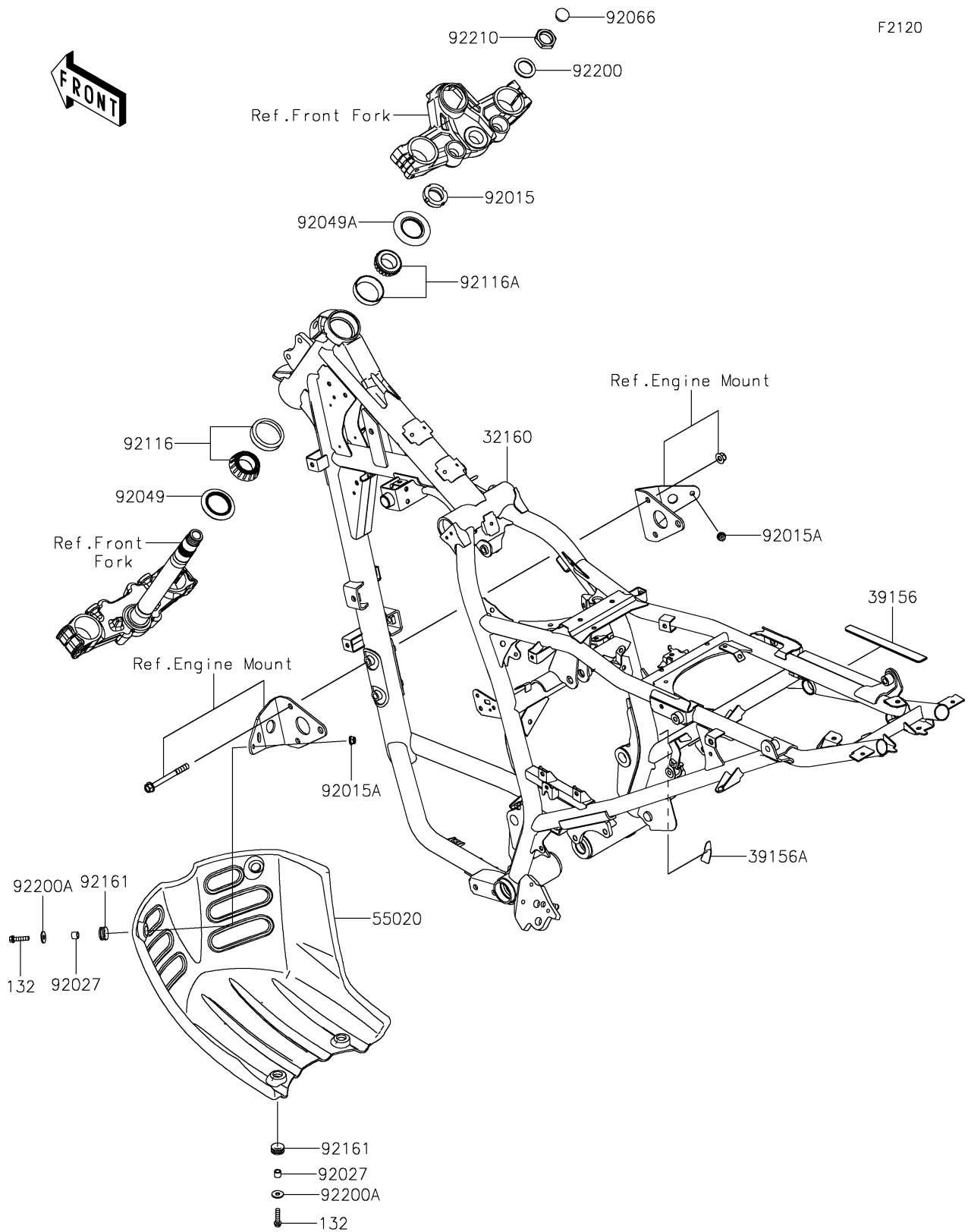

2022 KLR® 650 TRAVELER

PARTS LIST

Frame

| ITEM NAME | PART NUMBER | QUANTITY |
|---|----------------|----------|
| FRAME-COMP,F.S.BLACK (Ref # 32160) | 32160-1906-18R | 1 |
| PAD,RH (Ref # 39156) | 39156-2775 | 1 |
| PAD (Ref # 39156A) | 39156-2794 | 1 |
| GUARD,ENGINE,F.BLACK (Ref # 55020) | 55020-2372-6Z | 1 |
| NUT,25MM,T=12 (Ref # 92015) | 92015-1546 | 1 |
| NUT,LOCK,FLANGED,6MM (Ref # 92015A) | 92015-1603 | 2 |
| COLLAR,6.8X10X8.5 (Ref # 92027) | 92027-129 | 4 |
| SEAL-OIL,XMHE36X52X4J (Ref # 92049) | 92049-1162 | 1 |
| SEAL-OIL,STEERING STEM (Ref # 92049A) | 92049-1214 | 1 |
| PLUG (Ref # 92066) | 92066-1306 | 1 |
| BEARING-ROLLER,HR320/28XJ (Ref # 92116) | 92116-1009 | 1 |
| BEARING-ROLLER,HICAP 32005JR (Ref # 92116A) | 92116-1052 | 1 |
| DAMPER,10X20X8 (Ref # 92161) | 92161-1828 | 4 |
| WASHER,STEERING STEM (Ref # 92200) | 92200-0517 | 1 |
| WASHER,6.5X18X1.6 (Ref # 92200A) | 92200-0766 | 4 |
| NUT,STEERING STEM,22MM (Ref # 92210) | 92210-1521 | 1 |
| BOLT-FLANGED-SMALL,6X25 (Ref # 132) | 132BB0625 | 4 |