

2008 Ninja® ZX™-10R

PARTS DIAGRAM

Engine Cover(s)

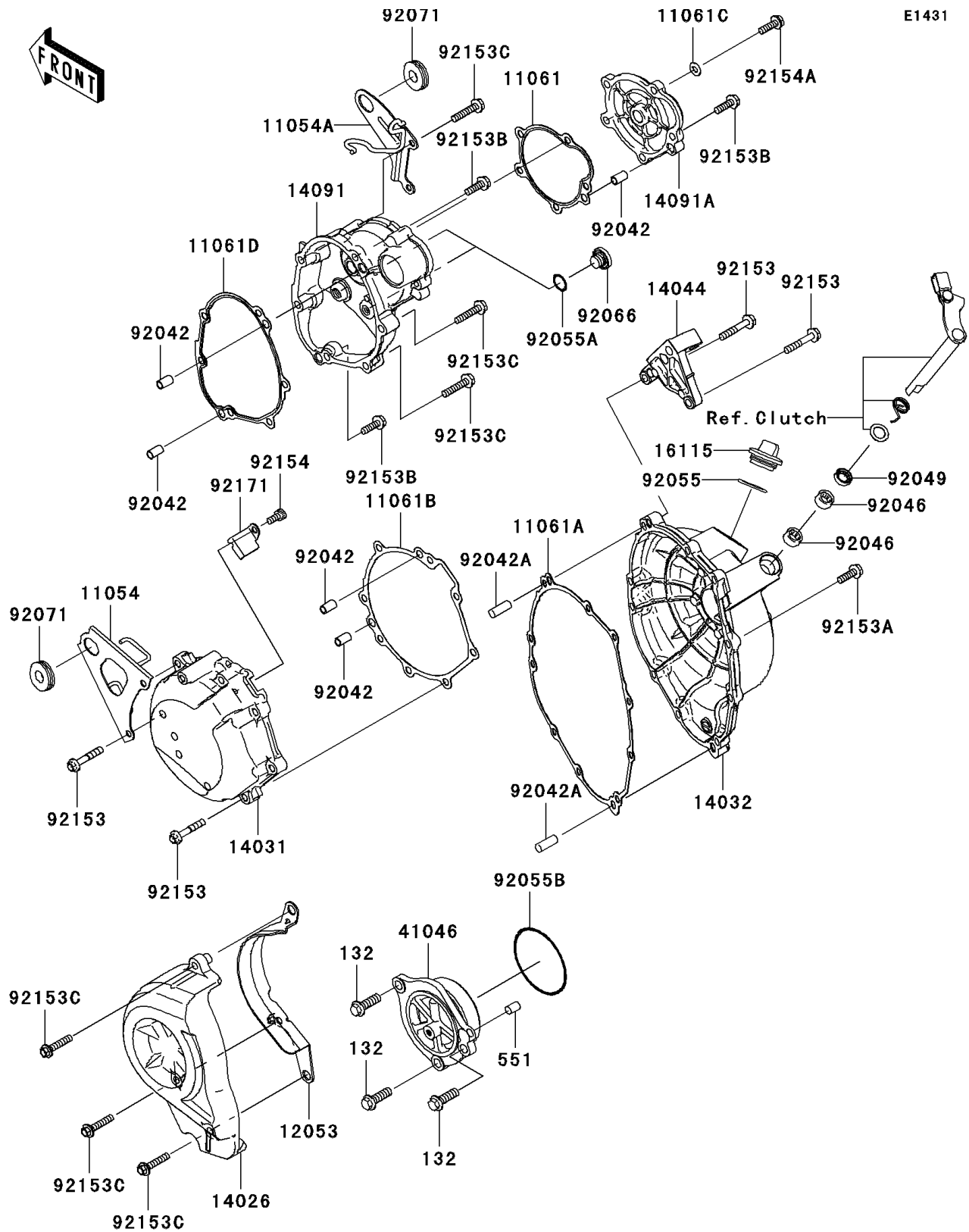

2008 Ninja® ZX™-10R

PARTS LIST

Engine Cover(s)

| ITEM NAME | PART NUMBER | QUANTITY |
|-----------------------------------------|----------------|----------|
| BRACKET,GENERATOR COVER (Ref # 11054) | 11054-1958 | 1 |
| BRACKET,STARTER COVER (Ref # 11054A) | 11054-1959 | 1 |
| GASKET,IDLE GEAR COVER (Ref # 11061) | 11061-0177 | 1 |
| GASKET,CLUTCH COVER (Ref # 11061A) | 11061-0178 | 1 |
| GASKET,GENERATOR COVER (Ref # 11061B) | 11061-0179 | 1 |
| GASKET,6.2X13.5X1.0 (Ref # 11061C) | 11061-0262 | 1 |
| GASKET,LARGE COVER (Ref # 11061D) | 11061-0336 | 1 |
| GUIDE-CHAIN (Ref # 12053) | 12053-0089 | 1 |
| COVER-CHAIN (Ref # 14026) | 14026-0054 | 1 |
| COVER-GENERATOR,F.S.BLACK (Ref # 14031) | 14031-0045-11E | 1 |
| COVER-CLUTCH (Ref # 14032) | 14032-0105 | 1 |
| HOLDER-CABLE (Ref # 14044) | 14044-0031 | 1 |
| COVER,STARTER,LARGE (Ref # 14091) | 14091-0860 | 1 |
| COVER,STARTER,SMALL (Ref # 14091A) | 14091-0905 | 1 |
| CAP-OIL FILLER (Ref # 16115) | 16115-1009 | 1 |
| HOUSING-BEARING (Ref # 41046) | 41046-0012 | 1 |
| PIN,DOWEL,6.3X8X14 (Ref # 92042) | 92042-007 | 5 |
| PIN,DOWEL,8X22 (Ref # 92042A) | 92042-044 | 2 |
| BEARING-NEEDLE,HK1210FM (Ref # 92046) | 92046-0034 | 2 |
| SEAL-OIL,CLUTCH RELEASE (Ref # 92049) | 92049-1475 | 1 |
| RING-O,31.7X2.4 (Ref # 92055) | 92055-049 | 1 |
| RING-O,ID=13.8 (Ref # 92055A) | 92055-1141 | 2 |
| RING-O,65.2X2.4 (Ref # 92055B) | 92055-1408 | 1 |
| PLUG,TIMING HOLE (Ref # 92066) | 92066-0067 | 2 |
| GROMMET (Ref # 92071) | 92071-1043 | 2 |
| BOLT,FLANGED,6X35 (Ref # 92153) | 92153-0690 | 10 |
| BOLT,FLANGED,6X25 (Ref # 92153A) | 92153-0764 | 8 |
| BOLT-FLANGED,6X20 (Ref # 92153B) | 92153-1010 | 6 |
| BOLT-FLANGED,6X30 (Ref # 92153C) | 92153-1315 | 7 |

2008 Ninja[®] ZX[™]-10R

PARTS LIST

Engine Cover(s)

| ITEM NAME | PART NUMBER | QUANTITY |
|-------------------------------------|-------------|----------|
| BOLT,SOCKET,6X12 (Ref # 92154) | 92154-0040 | 1 |
| BOLT,FLANGED,6X20 (Ref # 92154A) | 92154-0107 | 1 |
| CLAMP (Ref # 92171) | 92171-1566 | 1 |
| BOLT-FLANGED-SMALL,8X25 (Ref # 132) | 132BD0825 | 3 |
| PIN-DOWEL,8X12 (Ref # 551) | 551A0812 | 1 |