

2021 Vulcan® S ABS CAFE

PARTS DIAGRAM

Cowling

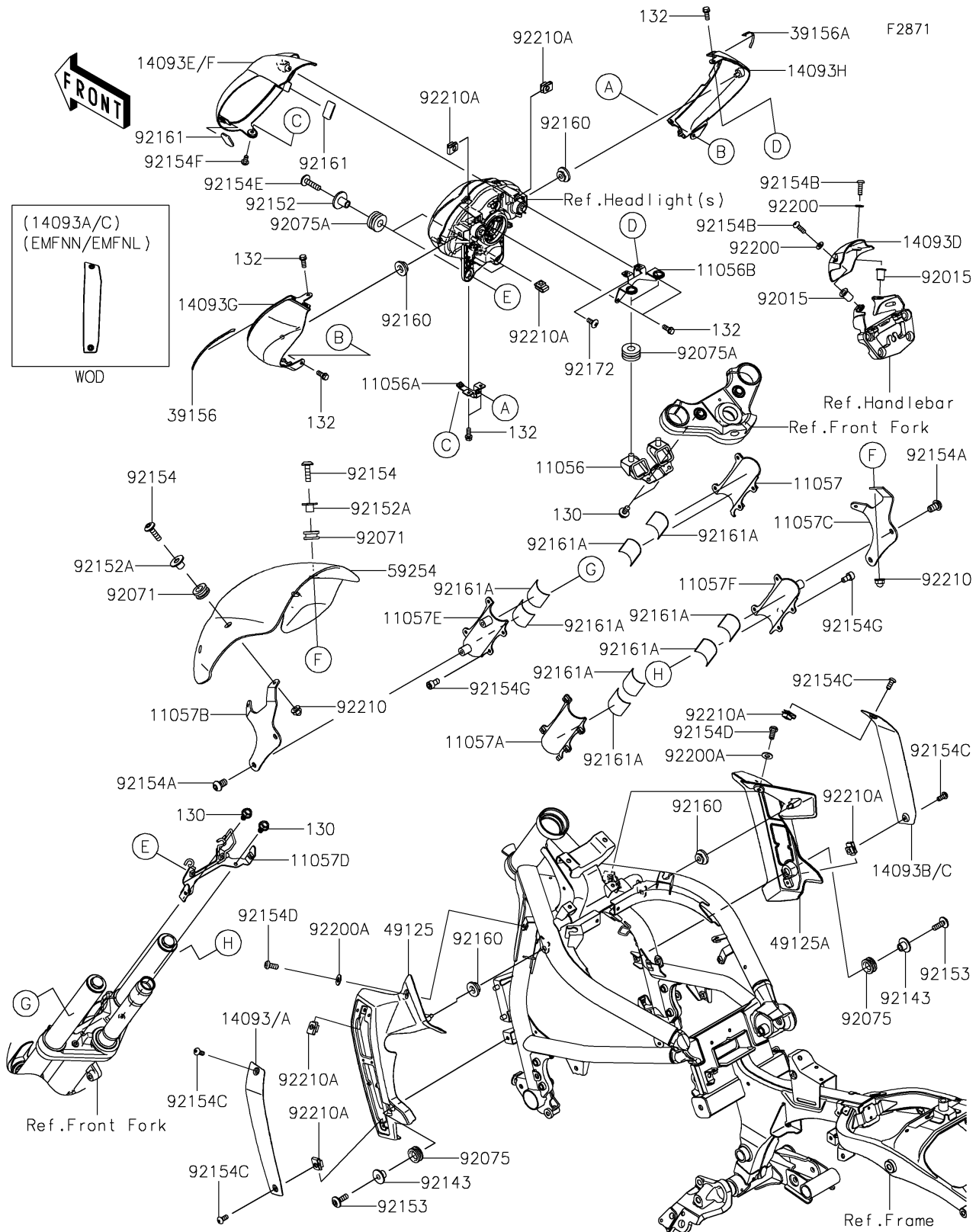

2021 Vulcan® S ABS CAFE

PARTS LIST

Cowling

| ITEM NAME | PART NUMBER | QUANTITY |
|---|----------------|----------|
| BRACKET,HEAD LAMP,UPP (Ref # 11056) | 11056-4380 | 1 |
| BRACKET,HEAD LAMP COVER,LWR (Ref # 11056A) | 11056-4384 | 1 |
| BRACKET,HEAD LAMP COVER,UPP (Ref # 11056B) | 11056-4385 | 1 |
| BRACKET,LH,INNER (Ref # 11057) | 11057-0215 | 1 |
| BRACKET,RH,INNER (Ref # 11057A) | 11057-0217 | 1 |
| BRACKET,LH (Ref # 11057B) | 11057-0220 | 1 |
| BRACKET,RH (Ref # 11057C) | 11057-0221 | 1 |
| BRACKET,HEAD LAMP,LWR (Ref # 11057D) | 11057-0706 | 1 |
| BRACKET,LH,OUTER (Ref # 11057E) | 11057-0857 | 1 |
| BRACKET,RH,OUTER (Ref # 11057F) | 11057-0858 | 1 |
| COVER,SHROUD,LH,C.S.F.ORANGE (Ref # 14093) | 14093-0113-62J | 1 |
| COVER,SHROUD,LH,EBONY (Ref # 14093A) | 14093-0113-H8 | 1 |
| COVER,SHROUD,RH,C.S.F.ORANGE (Ref # 14093B) | 14093-0114-62J | 1 |
| COVER,SHROUD,RH,EBONY (Ref # 14093C) | 14093-0114-H8 | 1 |
| COVER,METER (Ref # 14093D) | 14093-0128 | 1 |
| COVER,HEAD LAMP,C.S.F.ORANGE (Ref # 14093E) | 14093-0339-62J | 1 |
| COVER,HEAD LAMP,EBONY (Ref # 14093F) | 14093-0339-H8 | 1 |
| COVER,HEAD LAMP,LH,F.EBONY (Ref # 14093G) | 14093-0496-45L | 1 |
| COVER,HEAD LAMP,RH,F.EBONY (Ref # 14093H) | 14093-0497-45L | 1 |
| PAD,HEAD LAMP COVER,LH (Ref # 39156) | 39156-2120 | 1 |
| PAD,HEAD LAMP COVER,RH (Ref # 39156A) | 39156-2121 | 1 |
| SHROUD,LH (Ref # 49125) | 49125-0586 | 1 |
| SHROUD,RH (Ref # 49125A) | 49125-0587 | 1 |
| DEFLECTOR (Ref # 59254) | 59254-0005 | 1 |
| NUT,WELL,5MM (Ref # 92015) | 92015-1757 | 2 |
| GROMMET,10X20X10 (Ref # 92071) | 92071-0759 | 4 |
| DAMPER (Ref # 92075) | 92075-1634 | 2 |
| DAMPER,10X24X12 (Ref # 92075A) | 92075-1690 | 4 |
| COLLAR (Ref # 92143) | 92143-1962 | 2 |

2021 Vulcan® S ABS CAFE

PARTS LIST

Cowling

| ITEM NAME | PART NUMBER | QUANTITY |
|-------------------------------------|-------------|----------|
| COLLAR,6.5X24X15.3 (Ref # 92152) | 92152-2106 | 2 |
| COLLAR,6.8X10X11.1 (Ref # 92152A) | 92152-2251 | 4 |
| BOLT,6X18 (Ref # 92153) | 92153-0816 | 2 |
| BOLT,SOCKET,6X22 (Ref # 92154) | 92154-0787 | 4 |
| BOLT,SOCKET,8X14 (Ref # 92154A) | 92154-1032 | 4 |
| BOLT,SOCKET,5X16 (Ref # 92154B) | 92154-1470 | 2 |
| BOLT,SOCKET,5X12 (Ref # 92154C) | 92154-1471 | 4 |
| BOLT,SOCKET,6X14 (Ref # 92154D) | 92154-1512 | 2 |
| BOLT,SOCKET,6X25 (Ref # 92154E) | 92154-1532 | 2 |
| BOLT,SOCKET,5X10 (Ref # 92154F) | 92154-1547 | 1 |
| BOLT-SOCKET,6X12 (Ref # 92154G) | 92154-2688 | 8 |
| DAMPER (Ref # 92160) | 92160-1613 | 4 |
| DAMPER,12X23 (Ref # 92161) | 92161-1367 | 2 |
| DAMPER,60X140X1 (Ref # 92161A) | 92161-1868 | 8 |
| SCREW,5X12 (Ref # 92172) | 92172-0821 | 1 |
| WASHER,5.3X11X1 (Ref # 92200) | 92200-0973 | 2 |
| WASHER,6.5X14X1 (Ref # 92200A) | 92200-1388 | 2 |
| NUT,CAP,6MM (Ref # 92210) | 92210-0322 | 4 |
| NUT,PLATE,5MM (Ref # 92210A) | 92210-0935 | 8 |
| BOLT-FLANGED,6X12 (Ref # 130) | 130BB0612 | 4 |
| BOLT-FLANGED-SMALL,5X12 (Ref # 132) | 132BB0512 | 7 |