

# 2021 Z H2 SE

## PARTS DIAGRAM

### Air Cleaner

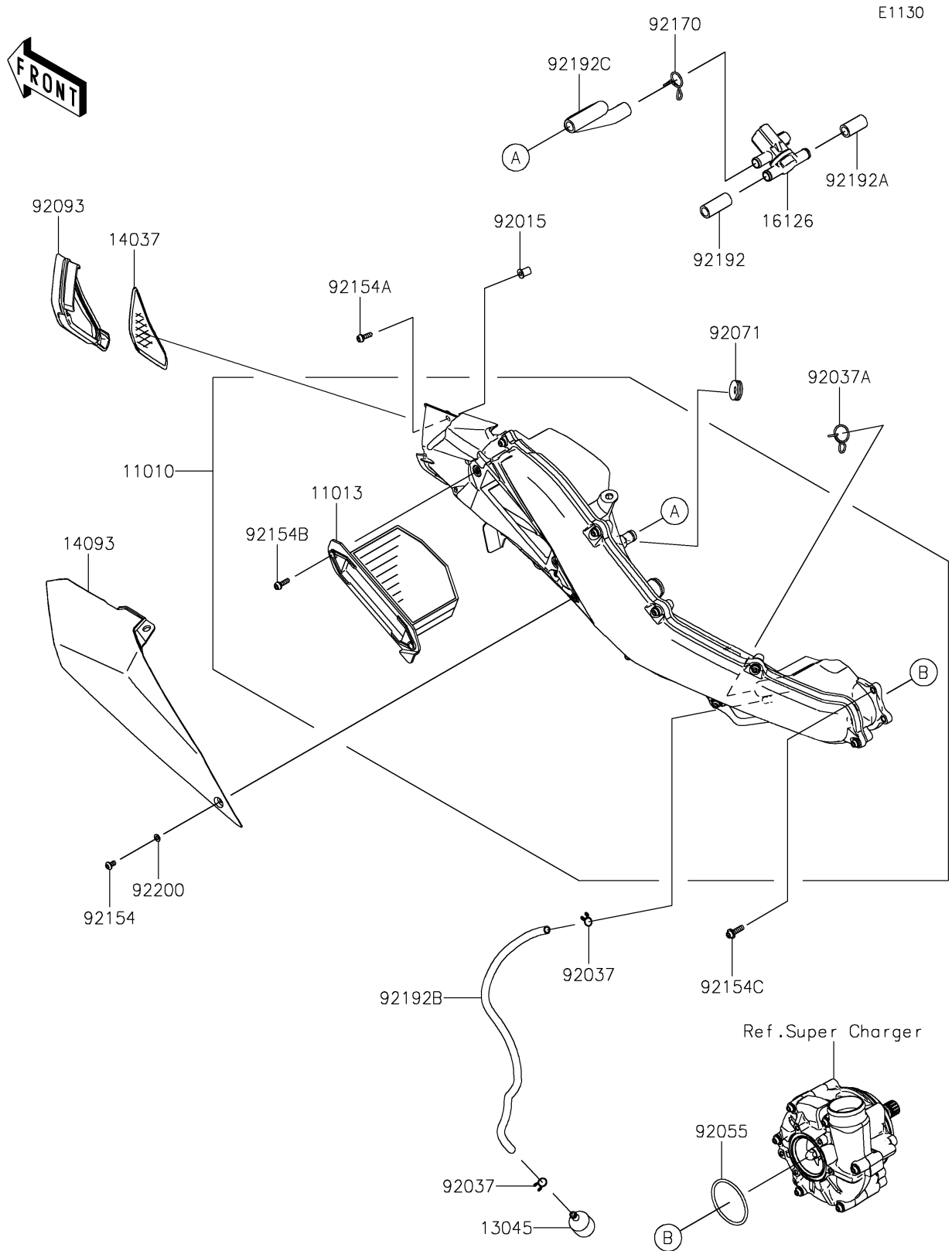

# 2021 Z H2 SE

## PARTS LIST

### Air Cleaner

ITEM NAME	PART NUMBER	QUANTITY
FILTER-ASSY-AIR (Ref # 11010)	11010-0994	1
ELEMENT-AIR FILTER (Ref # 11013)	11013-0804	1
RECEIVER-OIL (Ref # 13045)	13045-1057	1
SCREEN,G.B.GREEN (Ref # 14037)	14037-0807-46Y	1
COVER,M.C.BLACK (Ref # 14093)	14093-0976-43Z	1
VALVE,AIR SWITCHING (Ref # 16126)	16126-0745	1
NUT,WELL,5MM (Ref # 92015)	92015-1757	2
CLAMP,TUBE (Ref # 92037)	92037-147	2
CLAMP,TUBE (Ref # 92037A)	92037-213	1
RING-O,59.6X3.5 (Ref # 92055)	92055-0974	1
GROMMET (Ref # 92071)	92071-056	1
SEAL,SCREEN (Ref # 92093)	92093-0746	1
BOLT,SOCKET,5X10 (Ref # 92154)	92154-0211	1
BOLT,SOCKET,5X16 (Ref # 92154A)	92154-1449	2
BOLT,SOCKET,5X18 (Ref # 92154B)	92154-1450	9
BOLT,SOCKET,6X22,MEC (Ref # 92154C)	92154-2736	3
BOLT,SOCKET,5X45 (Ref # 92154D)	92154-2934	1
CLAMP (Ref # 92170)	92170-1017	1
SCREW,TAPPING,5X16 (Ref # 92172)	92172-0482	2
TUBE,ASWV-HEAD CAP,LH (Ref # 92192)	92192-1847	1
TUBE,ASWV-HEAD CAP,RH (Ref # 92192A)	92192-2276	1
TUBE,DRAIN (Ref # 92192B)	92192-2280	1
TUBE,2ND AIR (Ref # 92192C)	92192-2281	1
WASHER,5.2X10X1.0 (Ref # 92200)	92200-1820	1