

2019 KLX[®]110

PARTS DIAGRAM

Front Fork

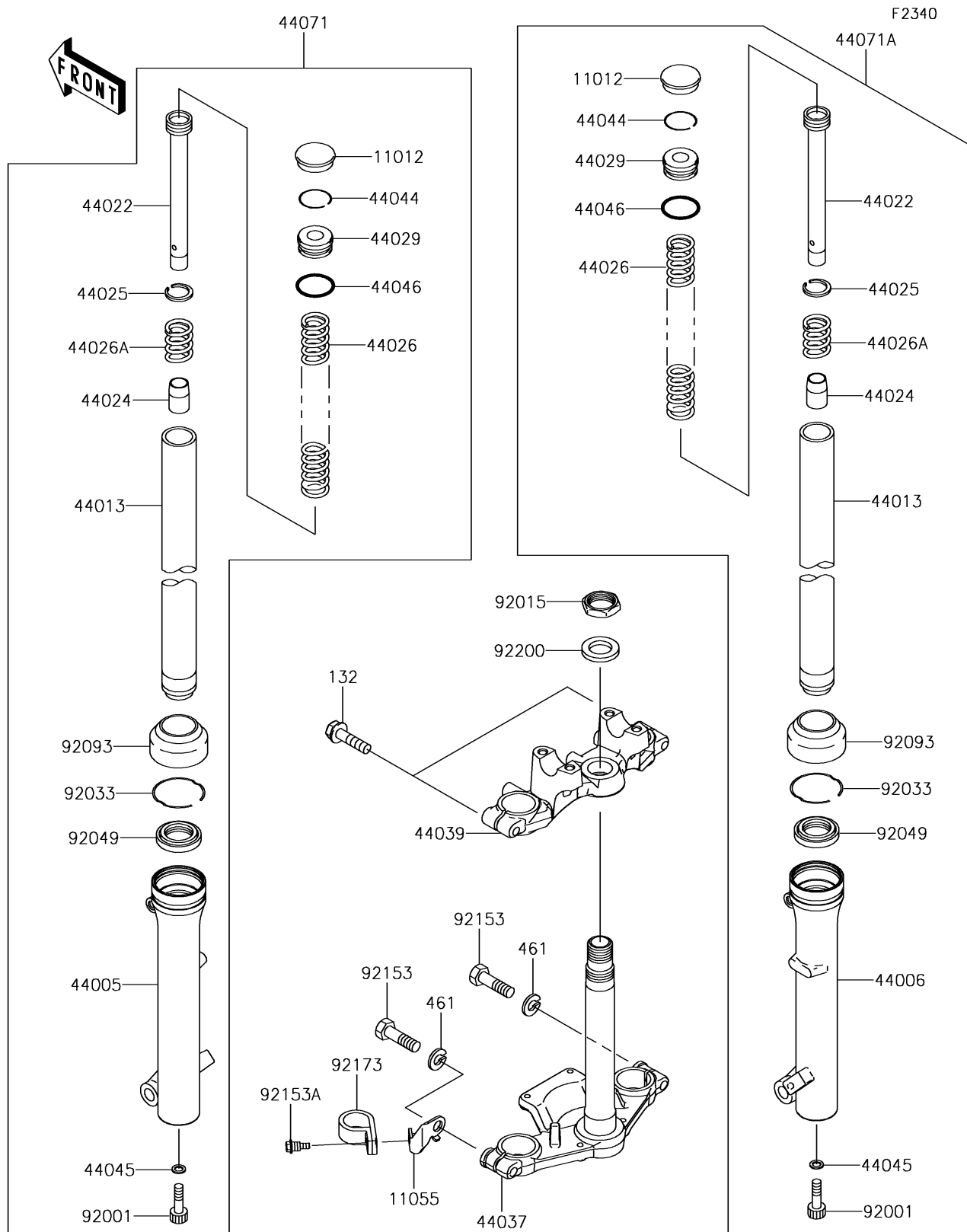

2019 KLX[®]110

PARTS LIST

Front Fork

ITEM NAME	PART NUMBER	QUANTITY
CAP,RUBBER,FORK TOP (Ref # 11012)	11012-1067	2
BRACKET (Ref # 11055)	11055-1631	1
BOLT-FLANGED-SMALL,8X35 (Ref # 132)	132BA0835	2
PIPE-LEFT FORK OUTER,P.SILVER (Ref # 44005)	44005-0039-458	1
PIPE-RIGHT FORK OUTER,P.SILVER (Ref # 44006)	44006-0038-458	1
PIPE-FORK INNER (Ref # 44013)	44013-0018	2
CYLINDER-FORK (Ref # 44022)	44022-1346	2
CAP-OIL-LOCK (Ref # 44024)	44024-1071	2
RING-FORK PISTON (Ref # 44025)	44025-1061	2
SPRING-FRONT FORK (Ref # 44026)	44026-0147	2
SPRING-FRONT FORK,REBOUND (Ref # 44026A)	44026-060	2
SEAT-FORK SPRING (Ref # 44029)	44029-022	2
HOLDER-FORK UNDER,P.SILVER (Ref # 44037)	44037-0105-458	1
HOLDER-FORK UPPER (Ref # 44039)	44039-0093	1
RING-SNAP (Ref # 44044)	44044-023	2
GASKET,FORK CYLINDER BOLT (Ref # 44045)	44045-051	2
RING-O (Ref # 44046)	44046-025	2
DAMPER-ASSY,FORK,LH,P.SILVER (Ref # 44071)	44071-0639-458	1
DAMPER-ASSY,FORK,RH,P.SILVER (Ref # 44071A)	44071-0640-458	1
WASHER-SPRING,10MM (Ref # 461)	461DA1000	2
BOLT,FORK CYLINDER (Ref # 92001)	92001-1464	2
NUT,STEERING STEM,22MM (Ref # 92015)	92015-1653	1
RING-SNAP,FORK OUTER TUBE (Ref # 92033)	92033-1028	2
SEAL-OIL,FORK OUTER TUBE (Ref # 92049)	92049-1069	2
DUST SHIELD,FORK (Ref # 92093)	92093-1054	2
BOLT,10X35 (Ref # 92153)	92153-1199	2
BOLT,FLANGED (Ref # 92153A)	92153-1397	1
CLAMP (Ref # 92173)	92173-0166	1
WASHER,STEERING STEM (Ref # 92200)	92200-0517	1