

1970 Sidewinder

PARTS DIAGRAM

OPTIONAL PARTS

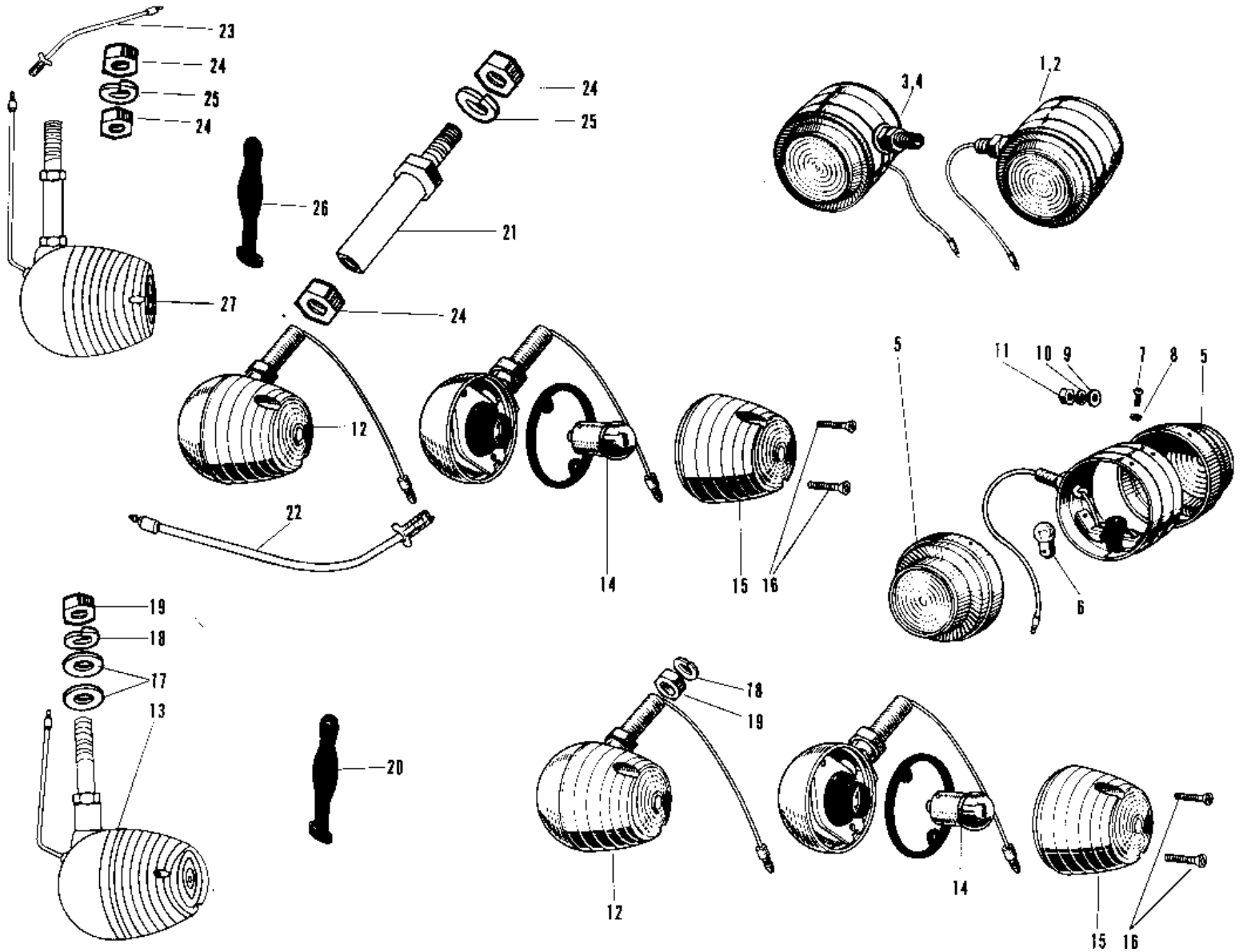

1970 Sidewinder

PARTS LIST

OPTIONAL PARTS

ITEM NAME	PART NUMBER	QUANTITY
LAMP FRNT TURN SIG RH (Ref # 1)	23040-013	
LAMP FRNT TURN SIG LH (Ref # 2)	23042-012	
LAMP REAR TURN SIG RH (Ref # 3)	23043-014	
LAMP REAR TURN SIG LH (Ref # 4)	23044-012	
LENS TURN SIGNAL LAMP (Ref # 5)	23048-004	
BULB 12V 8W (Ref # 6)	92069-019	
SCREW PAN HEAD 3X8 (Ref # 7)	220E0308	
WASHER SPRING 3MM (Ref # 8)	461F0300	
WASHER PLAIN 10MM (Ref # 9)	411B1000	
WASHER SPRING 10MM (Ref # 10)	461F1000	
NUT,10MM (Ref # 11)	314B1000	
LAMP FRNT TURN SIGNAL (Ref # 12)	23040-020	
UNAVAILABLE IN PRICE BOOK (Ref # 13)	23043-021	
BULB 12V 8W (Ref # 14)	92069-043	
LENS TURN SIGNAL LAMP (Ref # 15)	23048-011	
SCREW OVL CNTSNK 3X15 (Ref # 16)	222B0315A	
WASHER PLAIN 10MM (Ref # 17)	410B1000	
WASHER SPRING 10MM (Ref # 18)	461F1000	
NUT 10MM (Ref # 19)	315B1000	
BAND RUBBER (Ref # 20)	92072-013	
HOLDER (Ref # 21)	23051-002	
WIRING HARN EXTENSION (Ref # 22)	26011-040	
WIRING HARNESS,EXTNSN (Ref # 23)	26011-006	
NUT 10MM (Ref # 24)	315B1000	
WASHER SPRING 10MM (Ref # 25)	461F1000	
BAND RUBBER (Ref # 26)	92072-013	
UNAVAILABLE IN PRICE BOOK (Ref # 27)	23043-022	