

1968 Bushwhacker

PARTS DIAGRAM FRAME/FRAME FITTINGS

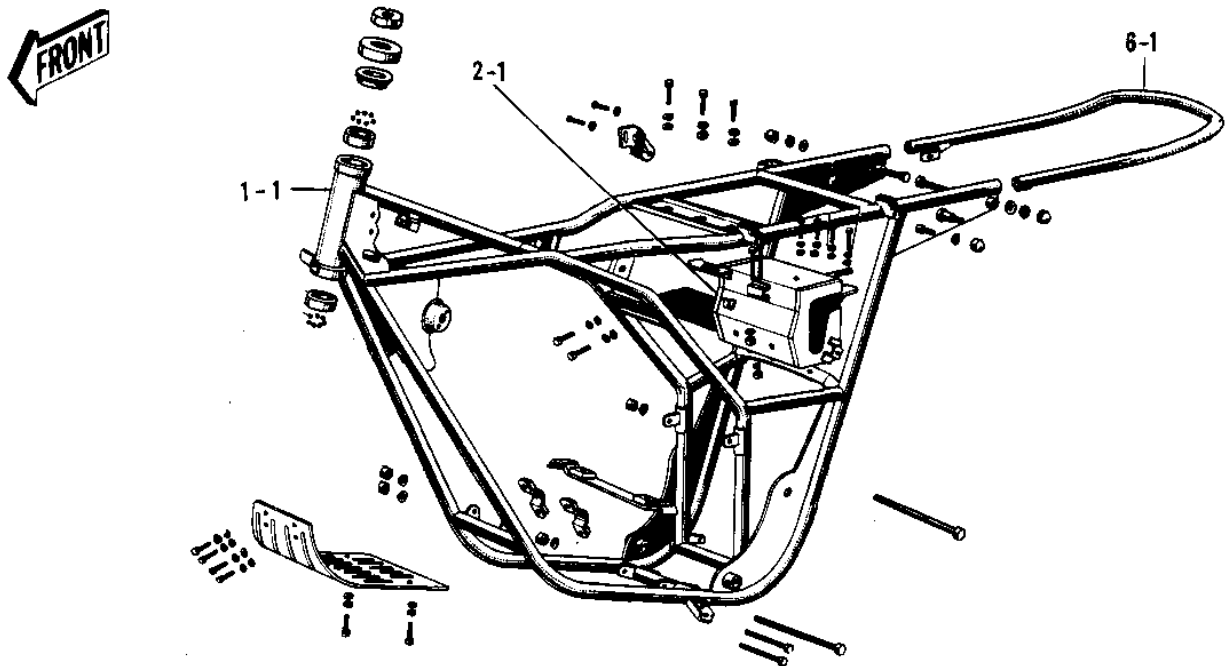
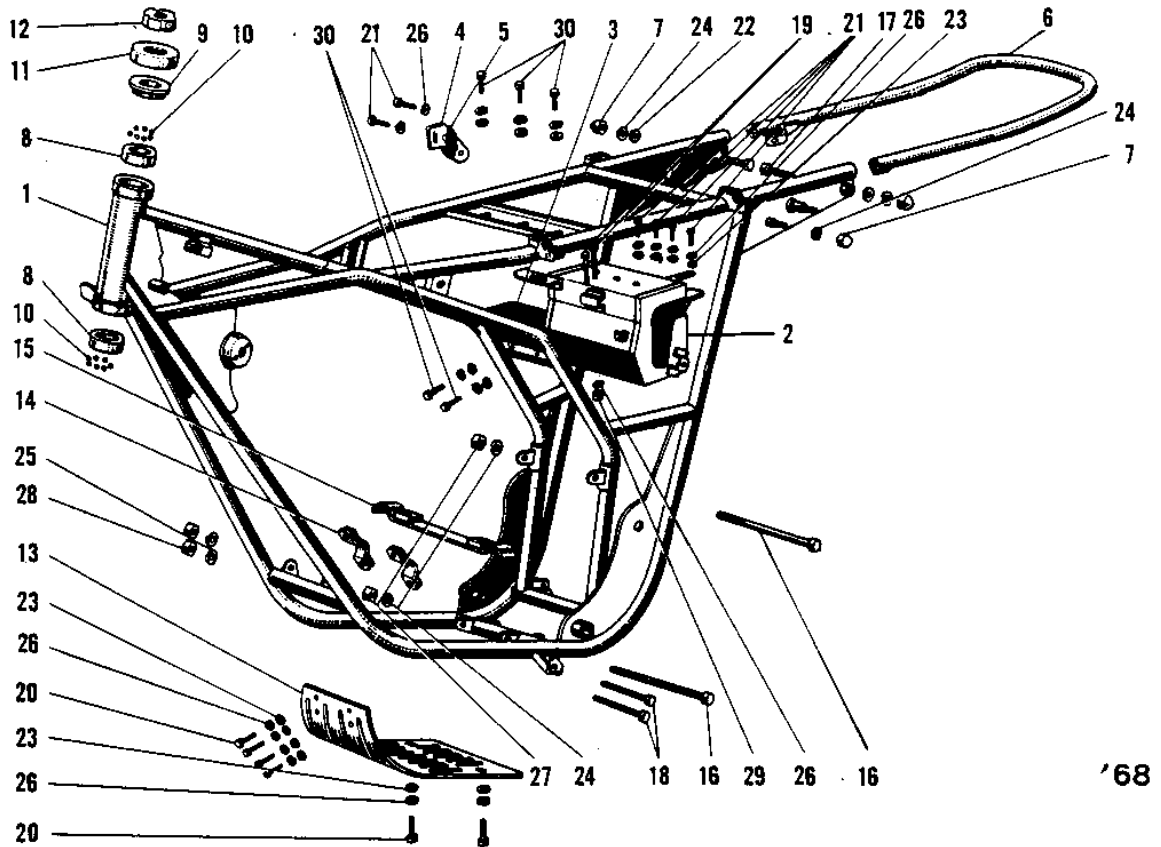

(All parts not referenced here are common to '68 F3 above.)

'69 -'70

1968 Bushwhacker

PARTS LIST

FRAME/FRAME FITTINGS

ITEM NAME	PART NUMBER	QUANTITY
FRAME (Ref # 1)	32002-029	
FRAME COMPLETE (Ref # 1-1)	32002-024	
CASE BATTERY (Ref # 2)	32097-005	
CASE BATTERY (Ref # 2-1)	32097-012	
MAT BATTERY (Ref # 3)	32103-005	
PROTECTOR BATTERY (Ref # 4)	31082-002	
BAND BATTERY (Ref # 5)	32100-005	
STAY REAR FENDER (Ref # 6)	35032-004	
STAY REAR FENDER (Ref # 6-1)	35032-013	
NUT SHOCK ABSORBER (Ref # 7)	92020-003	
RACE STEERING BEARING (Ref # 8)	92048-005	
CONE STERNG BERG UPP (Ref # 9)	92047-003	
BALL STEEL 1/4' (Ref # 10)	600A0800	
UNAVAILABLE IN PRICE BOOK (Ref # 11)	46098-002	
CAP STEERING STEM (Ref # 11)	46098-005	
NUT STEERING STEM LCK (Ref # 12)	92090-006	
GUARD ENGINE (Ref # 13)	55011-006	
BRACKET ENG GUARD FRT (Ref # 14)	55016-001	
BRACKET ENG GUARD RR (Ref # 15)	55016-002	
BOLT,HEX HEAD,10X125 (Ref # 16)	92001-1248	
BOLT,HEX HEAD,10X125 (Ref # 16)	92001-1248	
BOLT-SMALL-FINE,10X45 (Ref # 17)	113G1045	
BOLT FLANGED 8X55 (Ref # 18)	92001-1398	
BOLT FLANGED 8X55 (Ref # 18)	92001-1398	
BOLT 6X35 (Ref # 19)	110R0635	
BOLT-UPSET,6X16 (Ref # 20)	112G0616	
SCREW PAN HEAD 6X16 (Ref # 21)	220B0616	
WASHER PLAIN 10MM (Ref # 22)	410B1000	
WASHER PLAIN 6MM (Ref # 23)	410B0600	

1968 Bushwhacker

PARTS LIST

FRAME/FRAME FITTINGS

ITEM NAME	PART NUMBER	QUANTITY
WASHER SPRING 10MM (Ref # 24)	461F1000	
WASHER SPRING 8MM (Ref # 25)	461F0800	
WASHER SPRING 6MM (Ref # 26)	461F0600	
NUT,10MM (Ref # 27)	314B1000	
NUT,8MM (Ref # 28)	311B0800	
NUT 6MM (Ref # 29)	311B0600	
BOLT,6X10 (Ref # 30)	112G0610	