

1969 Bushwhacker

PARTS DIAGRAM

CARBURETOR

Kawasaki

Let the Good Times Roll®

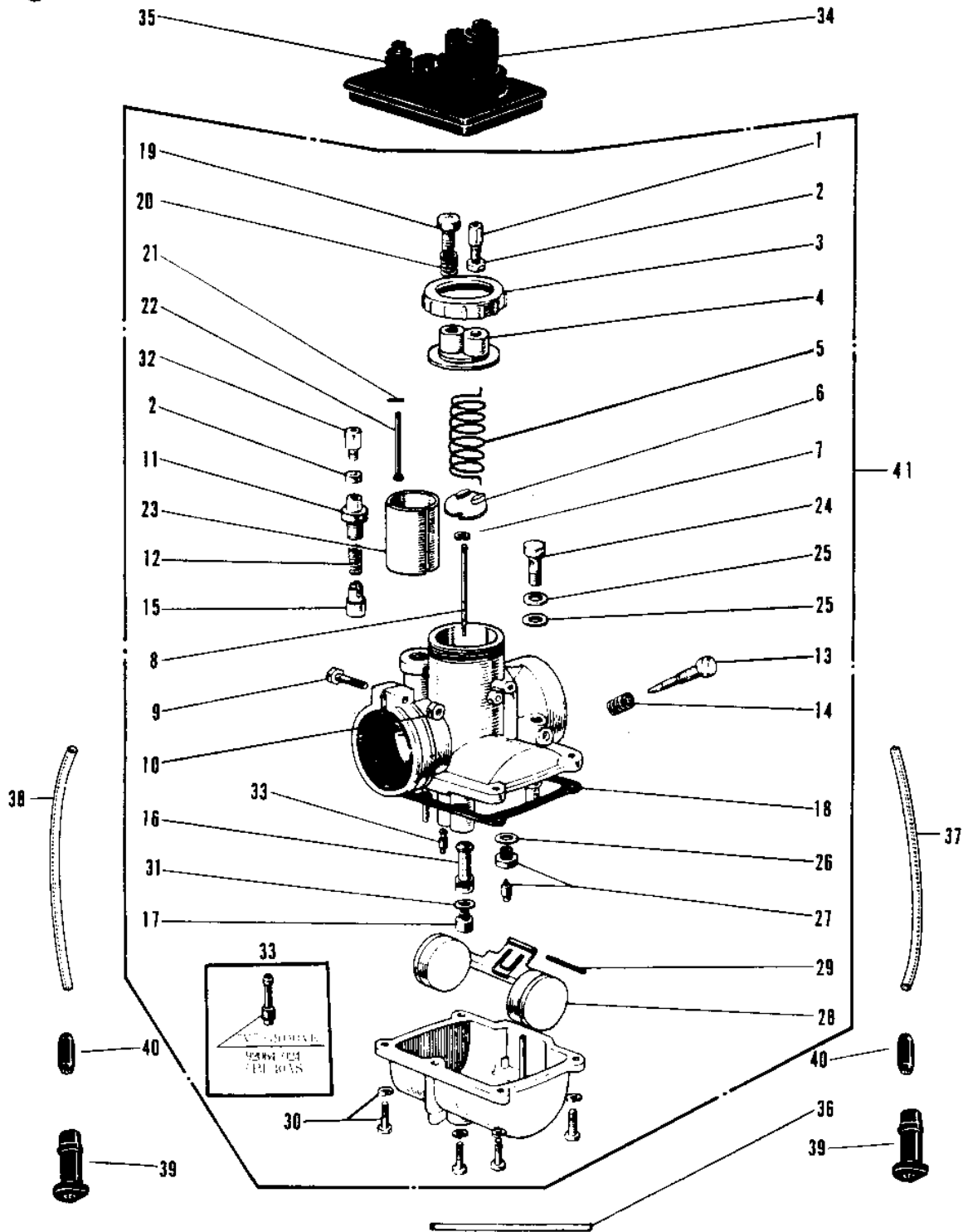
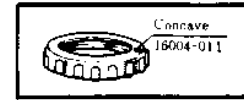

1969 Bushwhacker

PARTS LIST CARBURETOR

| ITEM NAME | PART NUMBER | QUANTITY |
|--------------------------------------|-------------|----------|
| CABLE ADJUSTER (Ref # 1) | 16002-002 | |
| NUT CABLE ADJUST LOCK (Ref # 2) | 16003-004 | |
| CAP MIXING CHAMBER (Ref # 3) | 16004-008 | |
| CAP MIXING CHAMBER (Ref # 3) | 16004-011 | |
| TOP MIXING CHAMBER (Ref # 4) | 16005-013 | |
| SPRING THROTTLE VALVE (Ref # 5) | 16006-010 | |
| SPRING SEAT THRTL VLV (Ref # 6) | 16007-011 | |
| CIRCLIP (Ref # 7) | 16008-010 | |
| JET NEEDLE 4J13 (Ref # 8) | 16009-012 | |
| SCREW CLAMP (Ref # 9) | 16010-004 | |
| NUT 6MM (Ref # 10) | 311B0600 | |
| NUT 6MM (Ref # 10) | 311B0600 | |
| CAP STARTER PLUNGER (Ref # 11) | 16012-006 | |
| SPRING STARTER PLUNG (Ref # 12) | 16013-005 | |
| SCREW PILOT AIR ADJST (Ref # 13) | 16014-003 | |
| SPRING,THROTTLE ADJST (Ref # 14) | 16022-010 | |
| PLUNGER-ENRICHNER (Ref # 15) | 16016-002 | |
| NEEDLE JET N-6 (Ref # 16) | 16017-019 | |
| JET-MAIN NO 190A (Ref # 17) | 92063-021 | |
| JET-MAIN NO 170A (Ref # 17) | 92063-019 | |
| JET-MAIN NO 180A (Ref # 17) | 92063-020 | |
| JET-MAIN NO 200A (Ref # 17) | 92063-022 | |
| JET-MAIN NO 210A (Ref # 17) | 92063-023 | |
| GASKET FLOAT CHAMBER (Ref # 18) | 16019-010 | |
| SCREW,THROTTLE STOP (Ref # 19) | 16021-002 | |
| SPRING THR STOP SCREW (Ref # 20) | 16022-005 | |
| UNAVAILABLE IN PRICE BOOK (Ref # 21) | 16023-001 | |
| ROD THROTTLE VLV STOP (Ref # 22) | 16024-004 | |
| VALVE THROTTLE CA2.0 (Ref # 23) | 16025-015 | |

1969 Bushwhacker

PARTS LIST CARBURETOR

| ITEM NAME | PART NUMBER | QUANTITY |
|-----------------------------------|-------------|----------|
| BOLT BANJO (Ref # 24) | 92001-014 | |
| GASKET 8MM (Ref # 25) | 751P0800 | |
| WASHER FLOAT VLV SEAT (Ref # 26) | 16029-004 | |
| FLOAT VALVE ASSY (Ref # 27) | 16030-005 | |
| FLOAT (Ref # 28) | 16031-010 | |
| FLOAT PIN (Ref # 29) | 16032-003 | |
| SCREW FLOAT CHAMBER (Ref # 30) | 16033-008 | |
| SCREW FLOAT CHAMBER (Ref # 30) | 16033-009 | |
| WASHER MAIN JET (Ref # 31) | 16034-001 | |
| CABLE ADJUSTER (Ref # 32) | 16002-005 | |
| PILOT JET #40 (Ref # 33) | 92064-005 | |
| JET-PILOT NO 40 (Ref # 33) | 92064-024 | |
| GROMMET CARBURETOR CAP (Ref # 34) | 14038-011 | |
| CAP CARBURETOR (Ref # 35) | 14038-014 | |
| PIPE FUEL OVERFLOW (Ref # 36) | 92059-023 | |
| PIPE FUEL OVERFLOW (Ref # 36) | 92059-031 | |
| PIPE AIR VENT A (Ref # 37) | 92059-038 | |
| PIPE AIR VENT A (Ref # 38) | 92059-038 | |
| GUIDE FUEL OVERFLOW (Ref # 39) | 16136-002 | |
| PIPE (Ref # 40) | 92098-001 | |
| CARBURETOR ASSY (Ref # 41) | 16001-054 | |