

# 1999 1100 STX

## PARTS DIAGRAM

### Cables

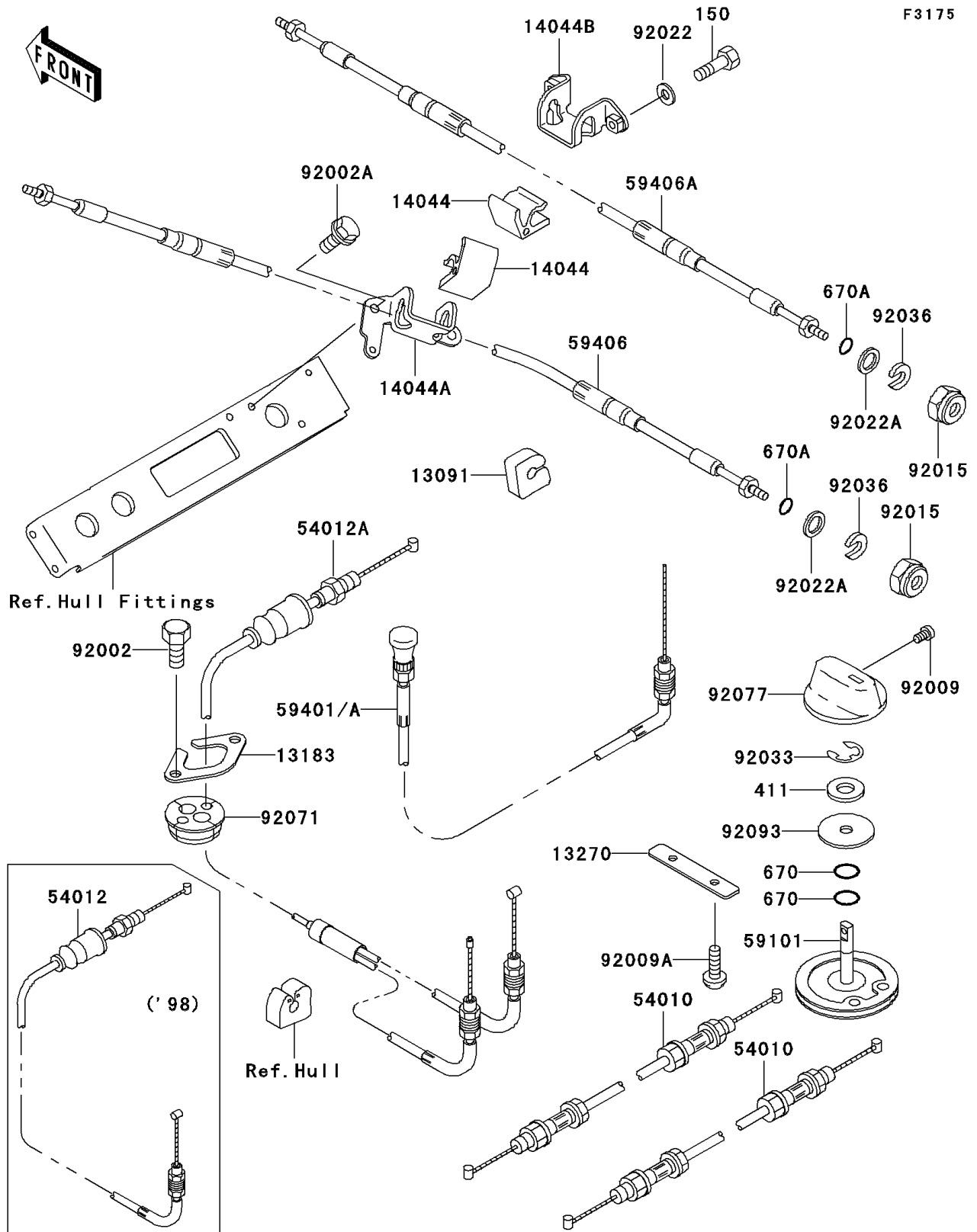

# 1999 1100 STX

## PARTS LIST

### Cables

ITEM NAME	PART NUMBER	QUANTITY
BOLT-WS,6X18 (Ref # 150)	150R0618	2
WASHER-PLAIN,8MM (Ref # 411)	411S0800	1
O RING,8MM (Ref # 670)	670B1508	2
O RING,11MM (Ref # 670A)	670B2011	2
HOLDER (Ref # 13091)	13091-3712	3
PLATE (Ref # 13183)	13183-3810	1
PLATE,FUEL TAP (Ref # 13270)	13270-3798	1
HOLDER-CABLE,STEERING (Ref # 14044)	14044-3714	2
HOLDER-CABLE,STEERING (Ref # 14044A)	14044-3717	1
HOLDER-CABLE,STEERING (Ref # 14044B)	14044-3731	1
CABLE,FUEL TAP (Ref # 54010)	54010-3710	2
CABLE-THROTTLE (Ref # 54012A)	54012-3760	1
REEL,SHIFT CABLE (Ref # 59101)	59101-3712	1
CABLE-CHOKE (Ref # 59401A)	59401-3722	1
CABLE-STRG (Ref # 59406)	59406-3748	1
CABLE-STRG,REVERSE (Ref # 59406A)	59406-3749	1
BOLT,6X16 (Ref # 92002)	92002-3728	2
BOLT,6X20 (Ref # 92002A)	92002-3755	2
SCREW,4X8 (Ref # 92009)	92009-3729	1
SCREW,5X16 (Ref # 92009A)	92009-3789	2
NUT,20MM (Ref # 92015)	92015-526	2
WASHER,6.5X20X1.5 (Ref # 92022)	92022-3710	2
WASHER (Ref # 92022A)	92022-535	2
RING-SNAP,7MM (Ref # 92033)	92033-3704	1
RING-SNAP (Ref # 92036)	92036-501	2
GROMMET,HARNESS (Ref # 92071)	92071-3790	1
KNOB,FUEL TAP (Ref # 92077)	92077-3727	1
SEAL (Ref # 92093)	92093-3757	1