

# 1976 KH500-A8

## PARTS DIAGRAM

### CRANKSHAFT/PISTONS ('73-'75 D/E/F & '76

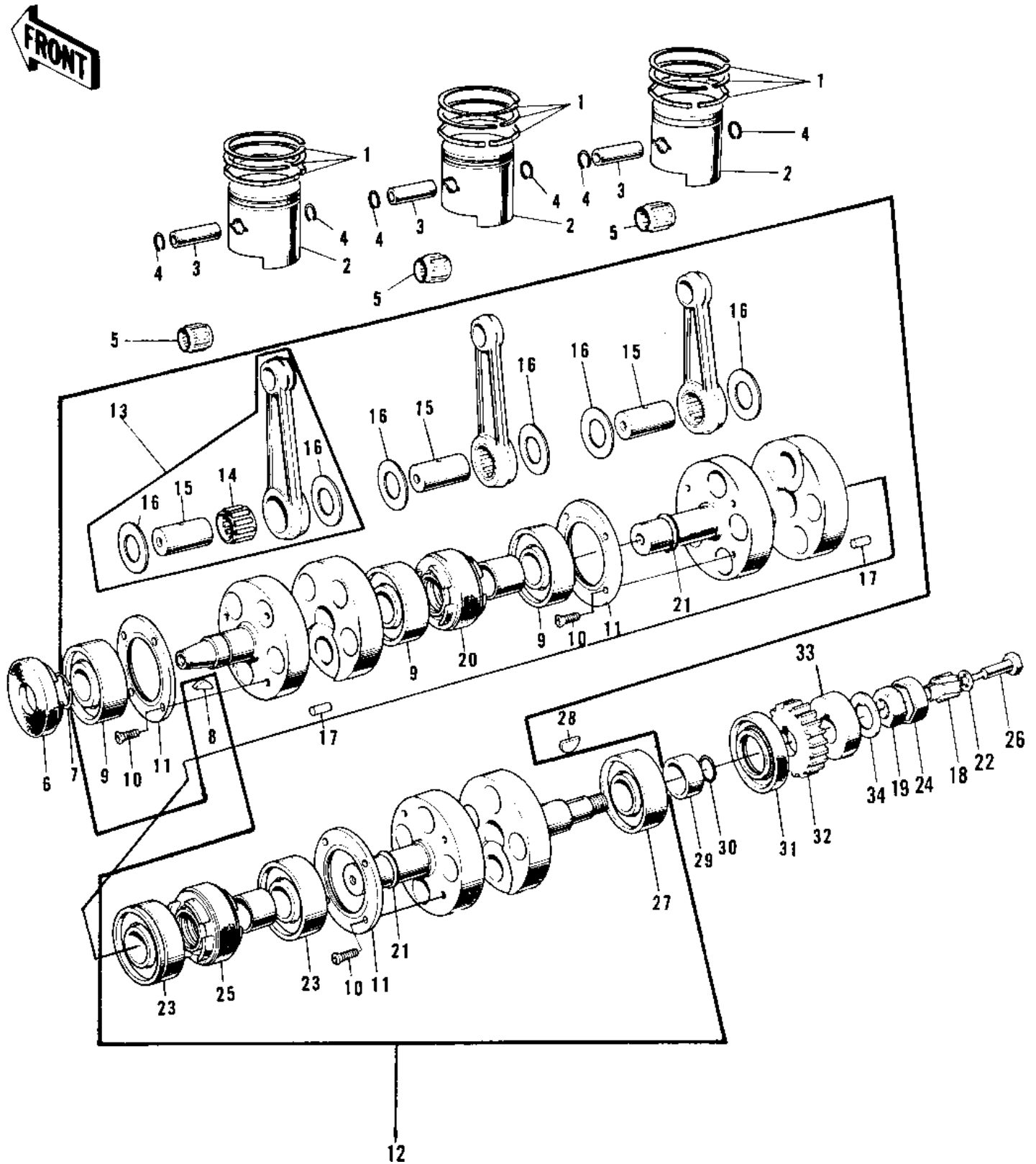

# 1976 KH500-A8

## PARTS LIST

### CRANKSHAFT/PISTONS ('73-'75 D/E/F & '76

ITEM NAME	PART NUMBER	QUANTITY
RING SET,STD (Ref # 1)	13008-041	3
RING SET,0.020" O.S (Ref # 1)	13025-044	(3
RING SET,0.040" O.S (Ref # 1)	13024-048	(3
PISTON STD (Ref # 2)	13001-031	3
PISTON 0.020' O.S (Ref # 2)	13029-031	(3
PISTON 0.040' O.S (Ref # 2)	13027-031	(3
PIN-PISTON (Ref # 3)	13002-010	3
CIRCLIP PISTON PIN (Ref # 4)	92036-004	6
BEARING-NEEDLE (Ref # 5)	92046-1038	3
OIL SEAL,TC255210 (Ref # 6)	92050-051	1
CIRCLIP (Ref # 7)	92036-013	1
WOODRUFF KEY (Ref # 8)	92038-001	1
BEARING BALL #6205 (Ref # 9)	601B6205	3
SCREW CNTRSNK HD 5X10 (Ref # 10)	92012-001	12
OIL RECEIVER,CRANKSFT (Ref # 11)	13045-010	3
CRANK&CONROD ASSY (Ref # 12)	13031-049	1
CONNECTING ROD SET (Ref # 13)	13044-034	3
NEEDLE BEARING BG END (Ref # 14)	13034-010	3
CRANK PIN (Ref # 15)	13035-017	3
WASHER SIDE (Ref # 16)	92026-024	6
PIN DOWEL 5X12 (Ref # 17)	610A0512	2
PINION OIL PUMP (Ref # 18)	16084-010	1
NUT 18MM (Ref # 19)	92015-019	1
OIL SEAL,Y325222.5 (Ref # 20)	92054-017	1
SPACER (Ref # 21)	92026-066	2
WASHER LOCK 6MM (Ref # 22)	463H0600	1
BALL BEARING 6305N (Ref # 23)	92045-020	2
WASHER LOCK (Ref # 24)	92024-021	1
OIL SEAL,Y326219 (Ref # 25)	92054-018	1

# 1976 KH500-A8

## PARTS LIST

### CRANKSHAFT/PISTONS ('73-'75 D/E/F & '76

ITEM NAME	PART NUMBER	QUANTITY
BOLT OIL PUMP PINION (Ref # 26)	92001-060	1
BEARING BALL #6305 (Ref # 27)	601B6305	2
WOODRUFF KEY (Ref # 28)	510A5200	1
COLLAR CRANK OIL SEAL (Ref # 29)	92027-031	1
"0" RING,22MM (Ref # 30)	92055-018	1
OIL SEAL,TC326210 (Ref # 31)	92050-052	1
PINION-PRIMARY (Ref # 32)	13121-013	1
COLLAR (Ref # 33)	92027-091	1
WASHER LOCK 18MM (Ref # 34)	92024-015	1