

1980 KZ1300-A2

PARTS DIAGRAM

FRAME

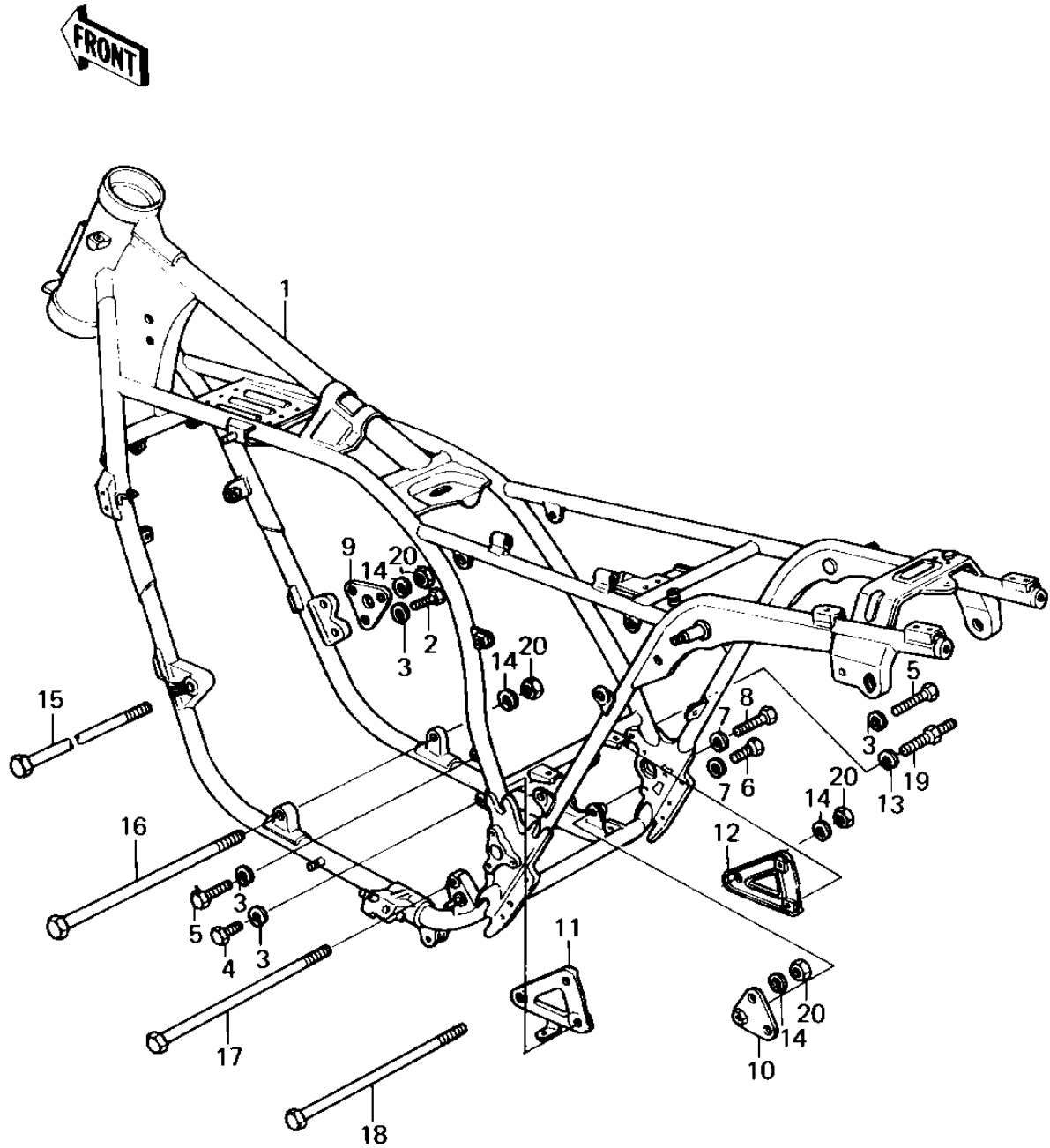

1980 KZ1300-A2

PARTS LIST

FRAME

| ITEM NAME | PART NUMBER | QUANTITY |
|---------------------------------|-------------|----------|
| FRAME (Ref # 1) | 32002-1092 | 1 |
| FRAME-COMP (Ref # 1) | 32002-1371 | 1 |
| BOLT,8X22 (Ref # 2) | 114G0822 | 1 |
| WASHER SPRING 8MM (Ref # 3) | 461F0800 | 1 |
| BOLT-SMALL-UPSET 8X25 (Ref # 4) | 115G0825 | 1 |
| BOLT,8X40 (Ref # 5) | 115G0840 | 1 |
| BOLT,HEX HEAD,10X16 (Ref # 6) | 113G1016 | 1 |
| WASHER SPRING 10MM (Ref # 7) | 461F1000 | 1 |
| BOLT,HEX HEAD 10X40 (Ref # 8) | 92001-1253 | 1 |
| BRACKET,ENGINE,FRONT (Ref # 9) | 32029-1061 | 1 |
| BRACKET,ENGINE,REAR (Ref # 10) | 32029-1062 | 1 |
| BRACKET,ENGINE,REAR (Ref # 11) | 32029-1063 | 1 |
| BRACKET,ENGINE,REAR (Ref # 12) | 32029-1064 | 1 |
| WASHER SPRING 8MM (Ref # 13) | 461F0800 | 1 |
| WASHER SPRING 10MM (Ref # 14) | 461F1000 | 1 |
| BOLT,HEX HEAD,10X369 (Ref # 15) | 92001-1126 | 1 |
| BOLT,HEX HEAD,10X3/3 (Ref # 16) | 92001-1127 | 1 |
| BOLT,HEX HEAD,10X305 (Ref # 17) | 92001-1128 | 1 |
| BOLT,HEX HEAD,10X287 (Ref # 18) | 92001-1129 | 1 |
| BOLT,ENGINE BRACKET (Ref # 19) | 92001-1400 | 1 |
| BOLT,ENGINE BRACKET (Ref # 19) | 92001-1400 | 1 |
| NUT,10MM (Ref # 20) | 92015-1429 | 1 |