

# 1980 Classic

## PARTS DIAGRAM

### MUFFLERS

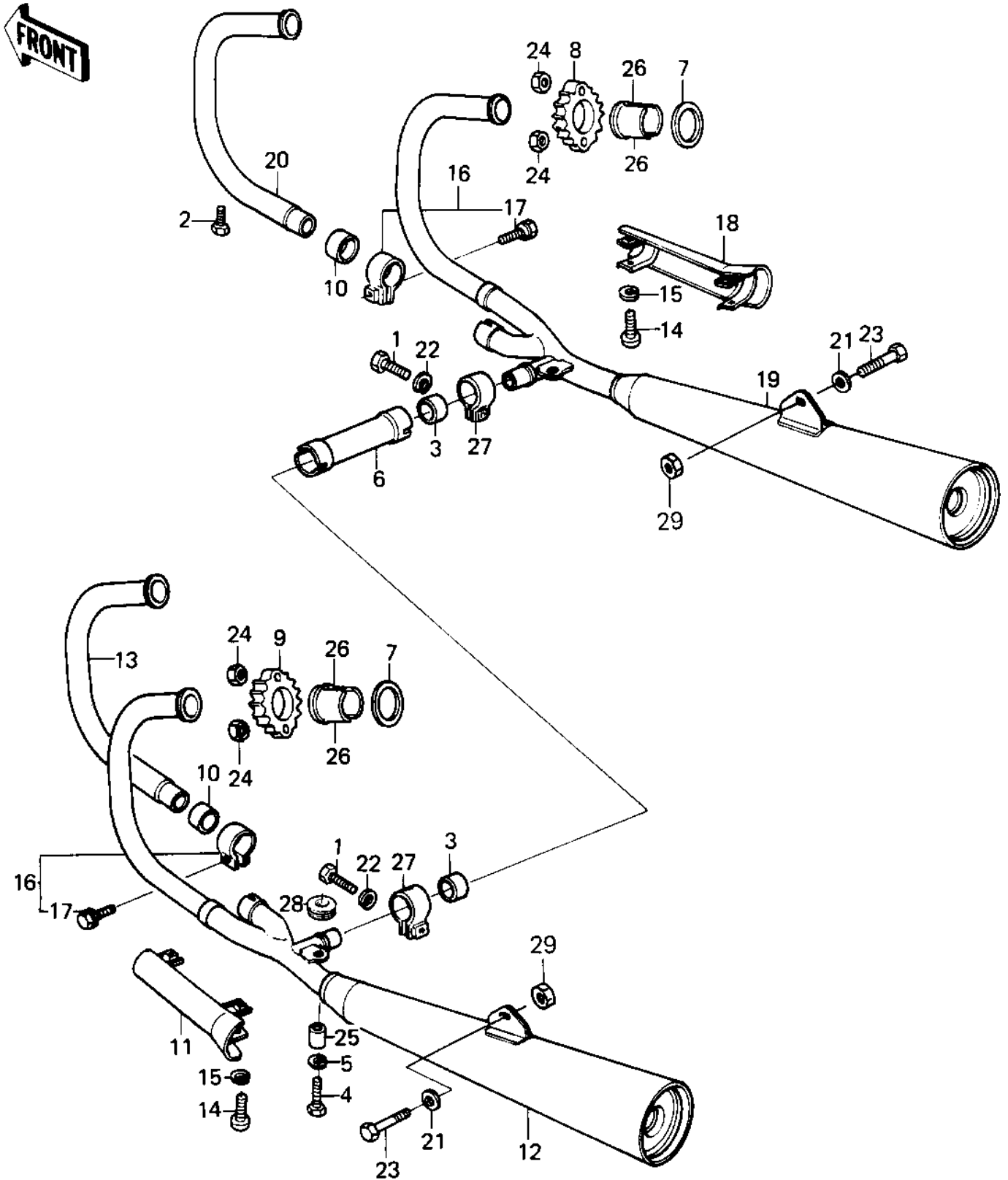

# 1980 Classic

## PARTS LIST

### MUFFLERS

ITEM NAME	PART NUMBER	QUANTITY
BOLT-SMALL-UPSET 8X25 (Ref # 1)	115G0825	2
BOLT (6X10) (Ref # 2)	110R0610	4
GASKET,EXHAUST PIPE C (Ref # 3)	11009-1718	2
BOLT-SMALL-UPSET,8X30 (Ref # 4)	115G0830	2
WASHER SPRING 8MM (Ref # 5)	461F0800	2
PIPE,MUFFLER CONNECTN (Ref # 6)	18039-025	1
GASKET,EXHAUST PIPE H (Ref # 7)	11009-1906	4
HOLDER,EXHAUST PIPE, (Ref # 8)	18069-1004	2
HOLDER,EXHAUST PIPE, (Ref # 9)	18069-1005	2
GASKET,MANIFOLD EXHAU (Ref # 10)	11060-1068	2
COVER,MUFFLER,L.H (Ref # 11)	14025-1205	1
MUFFLER,LH (Ref # 12)	18001-1121	1
PIPE,EXHAUST,L.H INN (Ref # 13)	18049-1018	1
SCREW PAN HEAD 6X40 (Ref # 14)	220B0640	4
WASHER SPRING 6MM (Ref # 15)	461F0600	4
CLAMP,MUFFLER (Ref # 16)	92037-1258	2
BOLT,8X30 (Ref # 17)	92001-1379	2
COVER,MUFFLER,R.H (Ref # 18)	14025-1206	1
MUFFLER,RH (Ref # 19)	18001-1122	1
PIPE,EXHAUST,R.H INN (Ref # 20)	18049-1019	1
WASHER,PLAIN,10MM (Canada) (Ref # 21)	410D1000	2
WASHER SPRING 8MM (Ref # 22)	461F0800	2
BOLT-HEX HEAD,10X60 (Ref # 23)	113N1060	2
NUT,LOCK,8MM (Ref # 24)	92017-013	8
COLLAR,MUFFLER FITT (Ref # 25)	92027-1271	2
INSERT,EXHAUST PIPE (Ref # 26)	92027-170	8
CLAMP,CONNECTING PIPE (Ref # 27)	92037-1221	2
DAMPER RUBBER (Ref # 28)	92075-1042	4
NUT,LOCK,10MM (Ref # 29)	92019-021	2