

1969 A1SS

PARTS DIAGRAM

FUEL TANK (1)

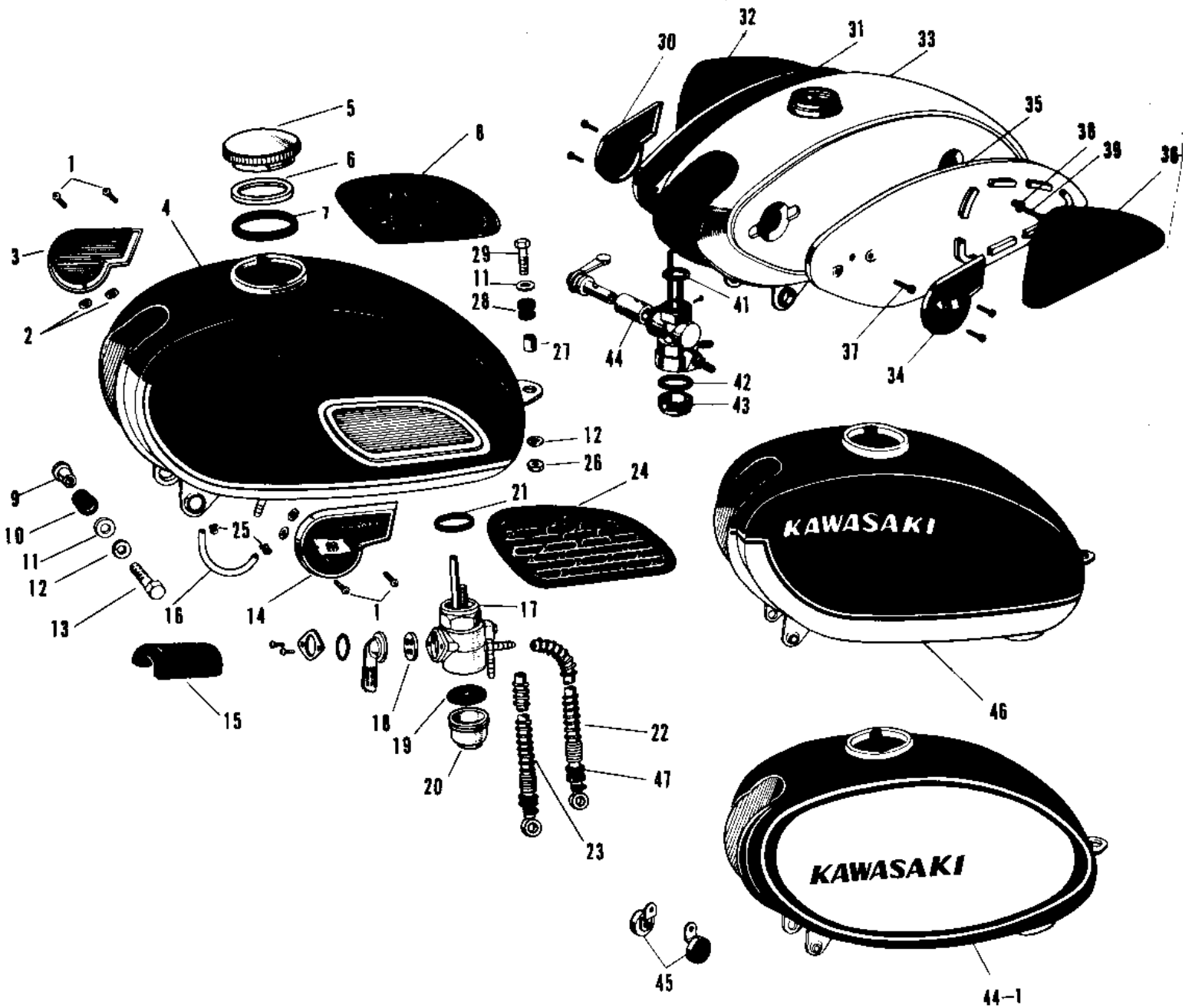

1969 A1SS

PARTS LIST

FUEL TANK (1)

Kawasaki

Let the Good Times Roll®

| ITEM NAME | PART NUMBER | QUANTITY |
|----------------------------------|--------------|----------|
| SCREW PAN HEAD 4X8 (Ref # 1) | 220E0408 | 4 |
| SCREW PAN HEAD 4X8 (Ref # 1) | 220E0408 | 4 |
| SPACER FL TANK EMBLEM (Ref # 2) | 56025-002 | 4 |
| EMBLEM FUEL TANK R.H (Ref # 3) | 56014-007 | 1 |
| TANK FUEL C.RED (Ref # 4) | 51001-015-24 | 1 |
| FUEL TANK (Ref # 4) | 51001-015-27 | NA |
| CAP FUEL TANK (Ref # 5,6) | 51049-008 | 1 |
| GASKET-FUEL TANK CAP (Ref # 7) | 51059-007 | 1 |
| GRIP KNEE R.H (Ref # 8) | 51062-008 | 1 |
| COLLAR,FUEL TANK FITT (Ref # 9) | 92027-1134 | 2 |
| DAMPER RUBB TANK FRNT (Ref # 10) | 92075-013 | 2 |
| WASHER,8X26X2.3 (Ref # 11) | 92022-1564 | 3 |
| WASHER SPRING 8MM (Ref # 12) | 461F0800 | 3 |
| BOLT 8X38 (Ref # 13) | 92001-1405 | 2 |
| EMBLEM FUEL TANK L.H (Ref # 14) | 56013-006 | 1 |
| MAT FUEL TANK (Ref # 15) | 51067-002 | 1 |
| PIPE FUEL TANK CONECT (Ref # 16) | 51047-002 | 1 |
| COCK ASSY,FUEL (Ref # 17~21) | 51023-043 | 1 |
| GASKET FUEL COCK LEV (Ref # 18) | 92065-019 | 1 |
| GASKET FUEL COCK CUP (Ref # 19) | 51037-007 | 1 |
| CUP FUEL COCK (Ref # 20) | 51036-003 | 1 |
| GASKET FUEL COCK JONT (Ref # 21) | 51032-001 | 1 |
| PIPE-FUEL (Ref # 22) | 51044-041 | 1 |
| PIPE-FUEL (Ref # 23) | 51044-040 | 1 |
| GRIP KNEE L.H (Ref # 24) | 51061-009 | 1 |
| CLAMP FUEL PIPE (Ref # 25) | 92037-010 | 2 |
| NUT,8MM (Ref # 26) | 311B0800 | 1 |
| SPACER FUEL TANK REAR (Ref # 27) | 92027-034 | 1 |
| DAMPER RUBB TANK REAR (Ref # 28) | 92075-030 | 1 |