

1968 Samurai

PARTS DIAGRAM

FUEL TANK (1)

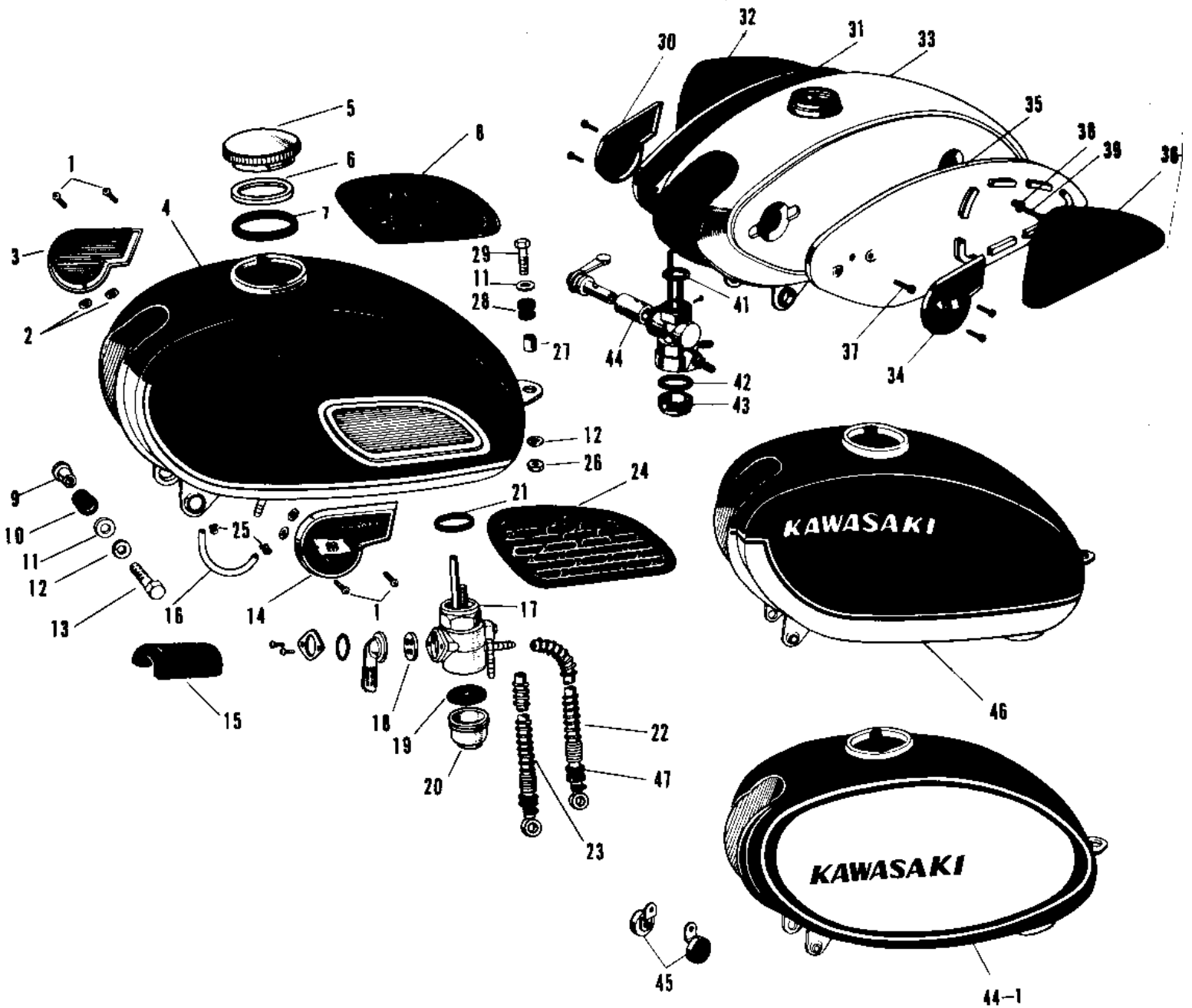

1968 Samurai

PARTS LIST

FUEL TANK (1)

ITEM NAME	PART NUMBER	QUANTITY
SCREW PAN HEAD 4X8 (Ref # 1)	220E0408	4
SCREW PAN HEAD 4X8 (Ref # 1)	220E0408	4
SPACER FL TANK EMBLEM (Ref # 2)	56025-002	4
EMBLEM FUEL TANK R.H (Ref # 3)	56014-007	1
TANK FUEL C.RED (Ref # 4)	51001-015-24	1
FUEL TANK (Ref # 4)	51001-015-27	NA
CAP FUEL TANK (Ref # 5,6)	51049-008	1
GASKET-FUEL TANK CAP (Ref # 7)	51059-007	1
GRIP KNEE R.H (Ref # 8)	51062-008	1
COLLAR,FUEL TANK FITT (Ref # 9)	92027-1134	2
DAMPER RUBB TANK FRNT (Ref # 10)	92075-013	2
WASHER,8X26X2.3 (Ref # 11)	92022-1564	3
WASHER SPRING 8MM (Ref # 12)	461F0800	3
BOLT 8X38 (Ref # 13)	92001-1405	2
EMBLEM FUEL TANK L.H (Ref # 14)	56013-006	1
MAT FUEL TANK (Ref # 15)	51067-002	1
PIPE FUEL TANK CONECT (Ref # 16)	51047-002	1
COCK ASSY,FUEL (Ref # 17~21)	51023-043	1
GASKET FUEL COCK LEV (Ref # 18)	92065-019	1
GASKET FUEL COCK CUP (Ref # 19)	51037-007	1
CUP FUEL COCK (Ref # 20)	51036-003	1
GASKET FUEL COCK JONT (Ref # 21)	51032-001	1
PIPE-FUEL (Ref # 22)	51044-041	1
PIPE-FUEL (Ref # 23)	51044-040	1
GRIP KNEE L.H (Ref # 24)	51061-009	1
CLAMP FUEL PIPE (Ref # 25)	92037-010	2
NUT,8MM (Ref # 26)	311B0800	1
SPACER FUEL TANK REAR (Ref # 27)	92027-034	1
DAMPER RUBB TANK REAR (Ref # 28)	92075-030	1