

# 1987 KX250

## PARTS DIAGRAM

### FRONT FORK

F2340-0285

F  
I

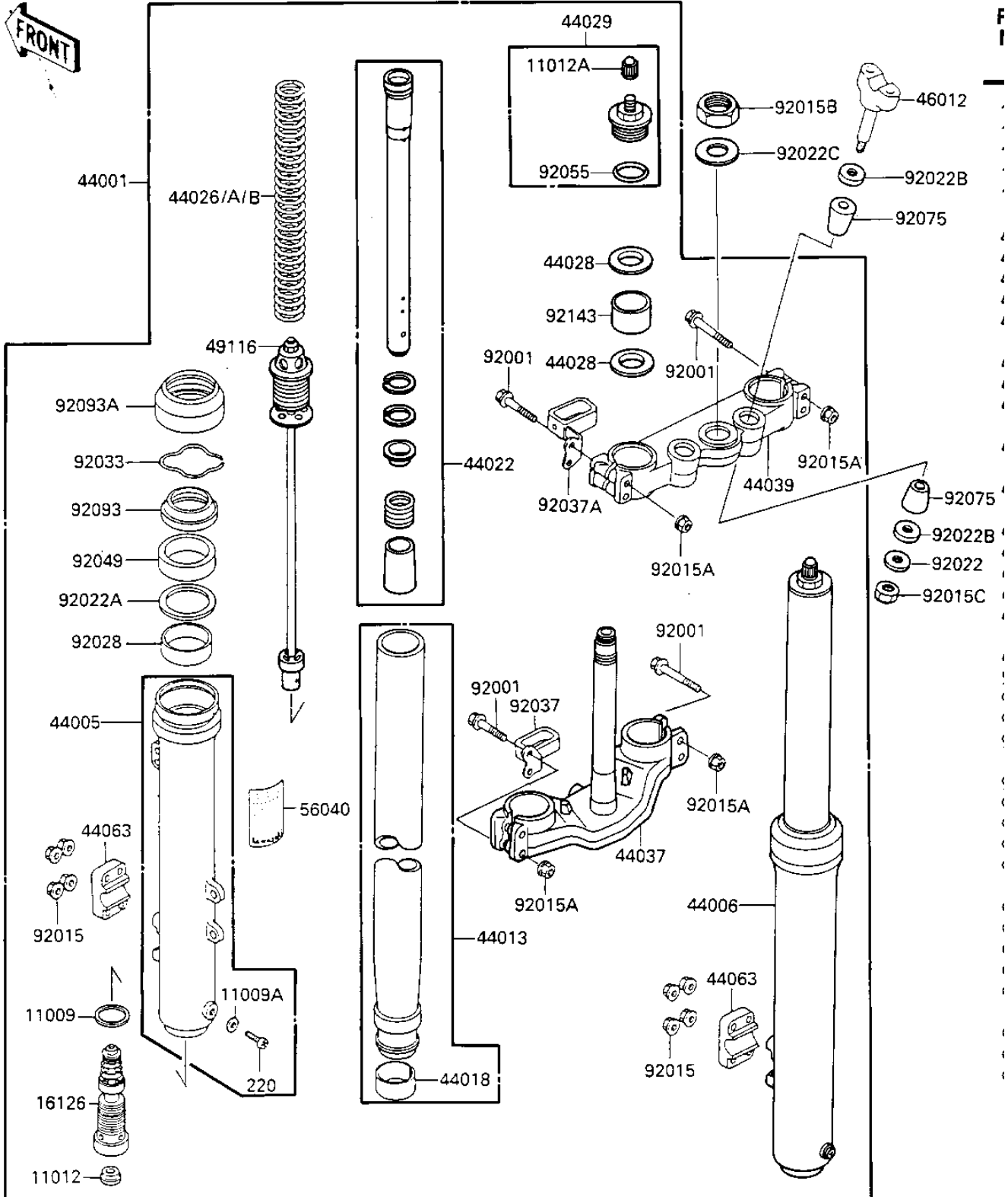

# 1987 KX250

## PARTS LIST FRONT FORK

ITEM NAME	PART NUMBER	QUANTITY
GASKET,FORK CYLINDER (Ref # 11009)	11009-1592	2
GASKET FORK DRAIN PLG (Ref # 11009A)	44045-002	2
CAP,FORK CYLINDER (Ref # 11012)	11012-1381	2
CAP,VALVE AIR (Ref # 11012A)	11012-1391	2
VALVE,FORK CYLINDER (Ref # 16126)	16126-1185	2
FORK-FRONT (Ref # 44001)	44001-1645	1
PIPE-LEFT FORK OUTER (Ref # 44005)	44005-1253	1
PIPE-RIGHT FORK OUTER (Ref # 44006)	44006-1243	1
PIPE-FORK INNER (Ref # 44013)	44013-1256	2
PISTON-FORK (Ref # 44018)	44018-1005	2
CYLINDER-FORK (Ref # 44022)	44022-1205	2
SPRING-FRONT FORK,K=0 (Ref # 44026)	44026-1314	2
SPRING-FRONT FORK,K=0 (Ref # 44026A)	44026-1324	2
SPRING-FRONT FORK,K=0 (Ref # 44026B)	44026-1325	2
GUIDE-FORK SPRING (Ref # 44028)	44028-1010	4
SEAT-FORK SPRING (Ref # 44029)	44029-1107	2
HOLDER-FORK UNDER (Ref # 44037)	44037-1208	1
HOLDER-FORK UPPER (Ref # 44039)	44039-1147	1
HOLDER-FRONT AXLE (Ref # 44063)	44063-1008	2
HOLDER-HANDLE,LOWER (Ref # 46012)	46012-1167	2
VALVE-ASSY,FORK (Ref # 49116)	49116-1068	2
LABEL,FRONT FORK (Ref # 56040)	56040-1120	1
BOLT (Ref # 92001)	92001-1639	8
NUT-6MM (Ref # 92015)	92015-1078	8
NUT,FLANGED,8MM (Ref # 92015A)	92015-1485	8
NUT (Ref # 92015B)	92015-1653	1
NUT,LOCK,10MM (Ref # 92015C)	92019-021	2
WASHER,10.2X28X2 (Ref # 92022)	92022-1088	2
WASHER (Ref # 92022A)	92022-1299	2

# 1987 KX250

## PARTS LIST

### FRONT FORK

ITEM NAME	PART NUMBER	QUANTITY
WASHER (Ref # 92022B)	92022-1737	4
WASHER (Ref # 92022C)	92022-1873	1
BUSHING (Ref # 92028)	92028-1145	2
RING-SNAP (Ref # 92033)	92033-1077	2
CLAMP (Ref # 92037)	92037-1627	1
CLAMP (Ref # 92037A)	92037-1628	1
SEAL-OIL,FORK OUTER T (Ref # 92049)	92049-1295	2
RING-O (Ref # 92055)	92055-1123	2
DAMPER (Ref # 92075)	92075-1776	4
SEAL,FORK DUST (Ref # 92093)	92093-1086	2
SEAL,FORK (Ref # 92093A)	92093-1184	2
COLLAR,L=55.5 (Ref # 92143)	92143-1065	2
SCREW PAN HEAD 4X8 (Ref # 220)	220B0408	2