

1985 GPz 750 Turbo

PARTS DIAGRAM TRANSMISSION

111001 0120

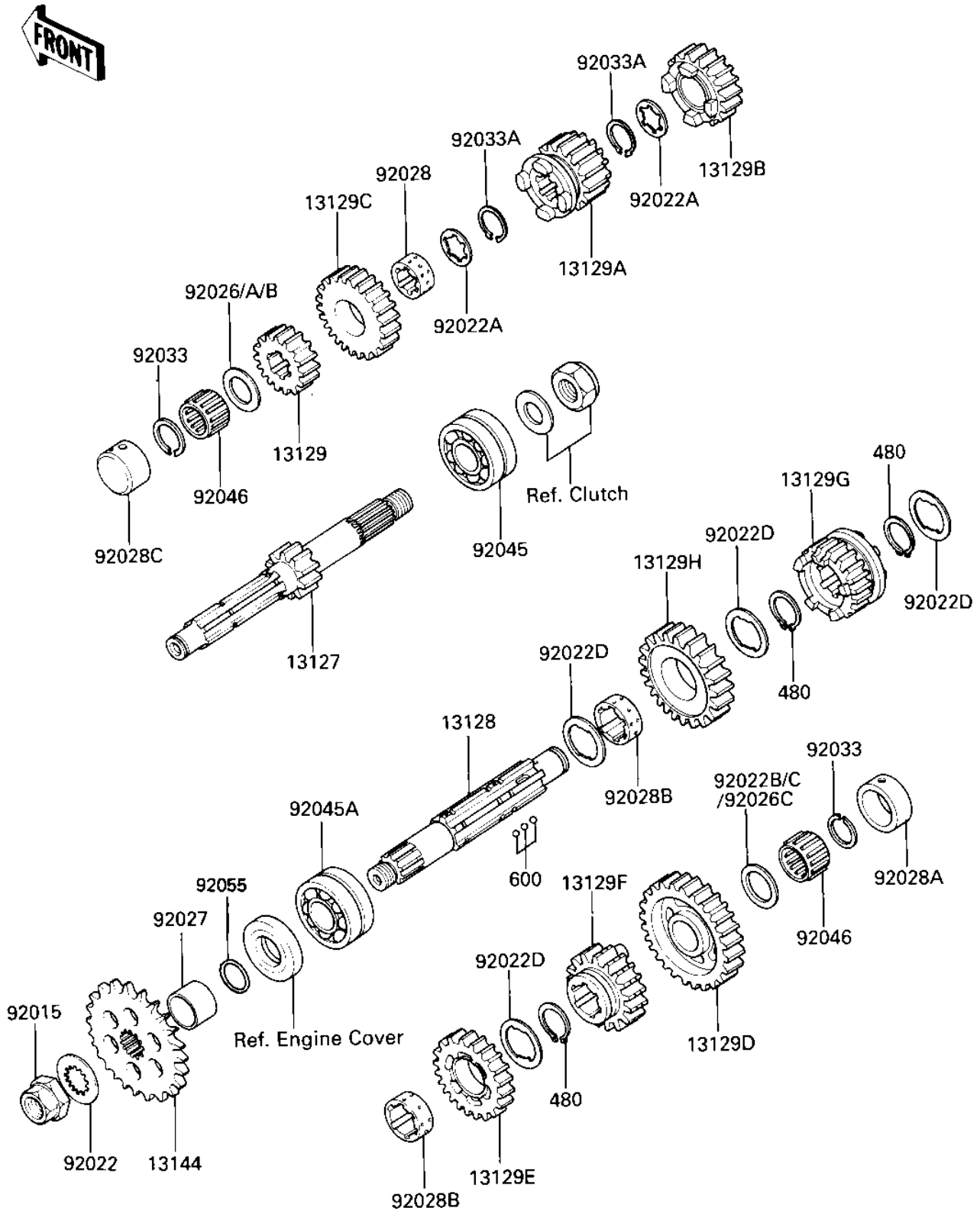

1985 GPz 750 Turbo

PARTS LIST TRANSMISSION

ITEM NAME	PART NUMBER	QUANTITY
SHAFT-TRANSMISSION IN (Ref # 13127)	13127-1103	1
SHAFT-TRANSMISSION OU (Ref # 13128)	13128-1102	1
GEAR,INPUT 2ND,17T (Ref # 13129)	13129-1506	1
GEAR,INPUT 3RD,22T (Ref # 13129A)	13129-1507	1
GEAR,INPUT 4TH,22T (Ref # 13129B)	13129-1508	1
GEAR,INPUT TOP,24T (Ref # 13129C)	13129-1509	1
GEAR,OUTPUT LOW,32T (Ref # 13129D)	13129-1510	1
GEAR,OUTPUT 3RD,28T (Ref # 13129E)	13129-1512	1
GEAR,OUTPUT 4TH,23T (Ref # 13129F)	13129-1513	1
GEAR,OUTPUT TOP,20T (Ref # 13129G)	13129-1514	1
GEAR-OUTPUT 2ND,28T (Ref # 13129H)	13129-1574	1
SPROCKET-OUTPUT,15T (Ref # 13144)	13144-1102	1
NUT,20MM (Ref # 92015)	92015-1254	1
WASHER (Ref # 92022)	92200-1065	1
WASHER,LOCK,1.0T (Ref # 92022A)	92022-1139	2
WASHER,PLAIN,22MM (Ref # 92022B)	92022-212	AR
WASHER,PLAIN,22MM (Ref # 92022C)	92022-213	AR
WASHER,LOCK (Ref # 92022D)	92024-069	4
SPACER,22X35.5X2.1 (Ref # 92026)	92026-1224	AR
SPACER,22X35.5X2.4 (Ref # 92026A)	92026-1225	1
SPACER,22X35.5X1.8 (Ref # 92026B)	92026-1226	AR
SPACER,22X35.5X1.8 (Ref # 92026C)	92026-1226	1
COLLAR,25X32X29.5 (Ref # 92027)	92027-1665	1
BUSHING,INPUT TOP GEA (Ref # 92028)	92028-1255	1
BUSHING,30X38X16.6 (Ref # 92028A)	92028-1256	1
BUSHING,OUTPUT GEAR (Ref # 92028B)	92028-1257	2
BUSHING,30X38X16.6 (Ref # 92028C)	92028-1256	1
CIRCLIP,25MM (Ref # 92033)	92033-025	2
SNAP RING,25.9X1.2T (Ref # 92033A)	92033-1037	2

1985 GPz 750 Turbo

PARTS LIST TRANSMISSION

ITEM NAME	PART NUMBER	QUANTITY
BEARING-BALL,N4-25BGS (Ref # 92045)	92045-1101	1
BEARING-BALL,V2-25BGS (Ref # 92045A)	92045-1102	1
BEARING,PK223013.8 (Ref # 92046)	92046-031	2
"O" RING (Ref # 92055)	92055-035	1
CIRCLIP,30MM (Ref # 480)	480J3000	3
BALL STEEL 5/32' (Ref # 600)	600A0500	3