

# 1981 LTD Belt

## PARTS DIAGRAM

### FRONT MASTER CYLINDER ('81-'83 D2/D3/D4/

F2291-0081

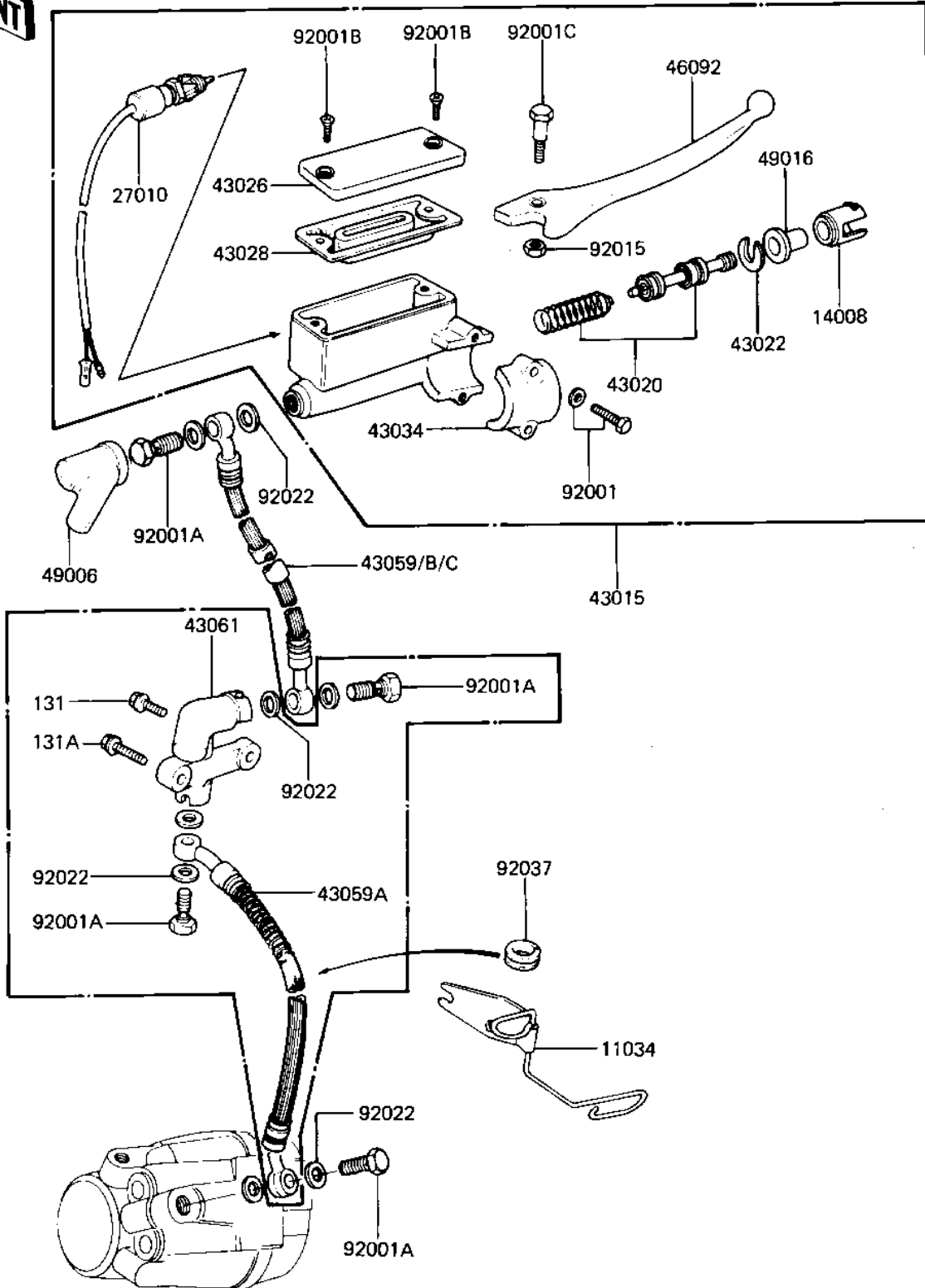

# 1981 LTD Belt

## PARTS LIST

### FRONT MASTER CYLINDER ('81-'83 D2/D3/D4/

ITEM NAME	PART NUMBER	QUANTITY
BRACKET,FRONT FENDER (Ref # 11034)	11034-1573	1
LINER,PISTON (Ref # 14008)	14008-1007	1
SWITCH,BRAKE (Ref # 27010)	27010-1028	1
CYLINDER ASSY,MASTER (Ref # 43015)	43015-1044	1
PISTON-COMP-BRAKE (Ref # 43020)	43020-1026	1
STOPER,PISTON (Ref # 43022)	43022-1001	1
CAP,OIL CUP (Ref # 43026)	43026-1006	1
DIAPHRAGM (Ref # 43028)	43028-1008	1
HOLDER,MASTER CYLINDR (Ref # 43034)	43034-1001	1
HOSE,BRAKE,M/C,L=390 (Ref # 43059)	43059-1037	1
HOSE,BRAKE,CALIPER (Ref # 43059A)	43059-1043	1
JOINT,BRAKE,TWO WAY (Ref # 43061)	43061-1003	1
LEVER,FRONT BRAKE (Ref # 46092)	46092-1009	1
BOOT,DUST (Ref # 49006)	49006-1041	1
DUST COVER (Ref # 49016)	49016-1010	1
BOLT,HEX HEAD,6X25 (Ref # 92001)	43033-003	2
BOLT,OIL,L=23 (Ref # 92001A)	92002-1888	4
SCREW,COUNTERSUNK HED (Ref # 92001B)	92001-1055	2
BOLT,CLUTCH LEV FITT (Ref # 92001C)	92001-1056	1
NUT 6MM (Ref # 92015)	312B0600	1
WASHER-OIL BOLT (Ref # 92022)	43067-001	8
DAMPER RUBBER,CYL HSE (Ref # 92037)	43064-006	1
BOLT,FLANGED,6X20 (Ref # 131)	130B0620	1
BOLT,FLANGED,6X30 (Ref # 131A)	131B0630	1