

1981 KZ750-E2

PARTS DIAGRAM

VALVES ('81 -'82 KZ750-E2/E3)

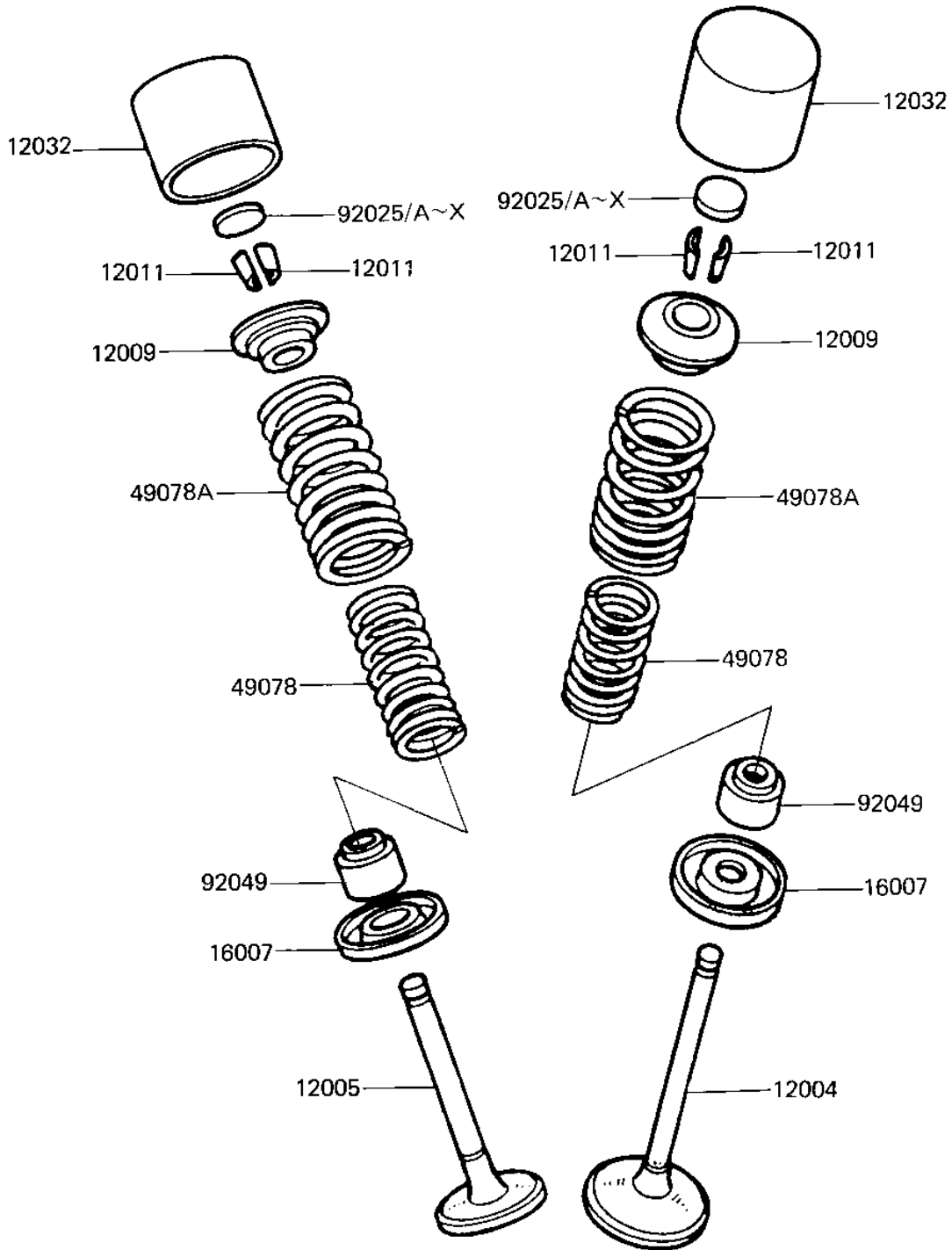

1981 KZ750-E2

PARTS LIST

VALVES ('81 -'82 KZ750-E2/E3)

ITEM NAME	PART NUMBER	QUANTITY
VALVE-INTAKE (Ref # 12004)	12004-1058	4
VALVE,EXHAUST (Ref # 12005)	12005-1006	4
RETAINER,VALVE SPRING (Ref # 12009)	12009-008	8
SPLIT KEEPER (Ref # 12011)	12011-004	16
TAPPET (Ref # 12032)	12032-1001	8
SEAT-SPRING,VALVE (Ref # 16007)	16007-1024	8
SPRING,VALVE,INNER (Ref # 49078)	49078-1001	8
SPRING,VALVE,OUTER (Ref # 49078A)	49078-1002	8
SHIM,2.007 (Ref # 92025)	92025-1090	AR
SHIM,2.05T (Ref # 92025A)	92025-1091	AR
SHIM,2.10T (Ref # 92025B)	92025-1092	AR
SHIM,2.15T (Ref # 92025C)	92025-1093	AR
SHIM,2.20T (Ref # 92025D)	92025-1094	AR
SHIM,2.25T (Ref # 92025E)	92025-1095	AR
SHIM,2.30T (Ref # 92025F)	92025-1096	AR
SHIM,2.35T (Ref # 92025G)	92025-1097	AR
SHIM,2.40T (Ref # 92025H)	92025-1098	AR
SHIM,2.45T (Ref # 92025I)	92025-1099	AR
SHIM,2.50T (Ref # 92025J)	92025-1100	AR
SHIM T2.55 (Ref # 92025K)	92025-1101	AR
SHIM,2.60T (Ref # 92025L)	92025-1102	AR
SHIM,2.65T (Ref # 92025M)	92025-1103	AR
SHIM,2.70T (Ref # 92025N)	92025-1104	AR
SHIM,2.75T (Ref # 92025O)	92025-1105	AR
SHIM,2.80T (Ref # 92025P)	92025-1106	AR
SHIM,2.85T (Ref # 92025Q)	92025-1107	AR
SHIM,2.90T (Ref # 92025R)	92025-1108	AR
SHIM,2.95 (Ref # 92025S)	92025-1109	AR
SHIM,3.00T (Ref # 92025T)	92025-1110	AR

1981 KZ750-E2

PARTS LIST

VALVES ('81 -'82 KZ750-E2/E3)

ITEM NAME	PART NUMBER	QUANTITY
SHIM,3.05T (Ref # 92025U)	92025-1111	AR
SHIM,3.10T (Ref # 92025V)	92025-1112	AR
SHIM,3.15T (Ref # 92025W)	92025-1113	AR
SHIM,3.20T (Ref # 92025X)	92025-1114	AR
OIL SEAL,RV37129.5 (Ref # 92049)	92049-016	8