

2012 KX™ 450F PARTS DIAGRAM

Crankcase

E1411

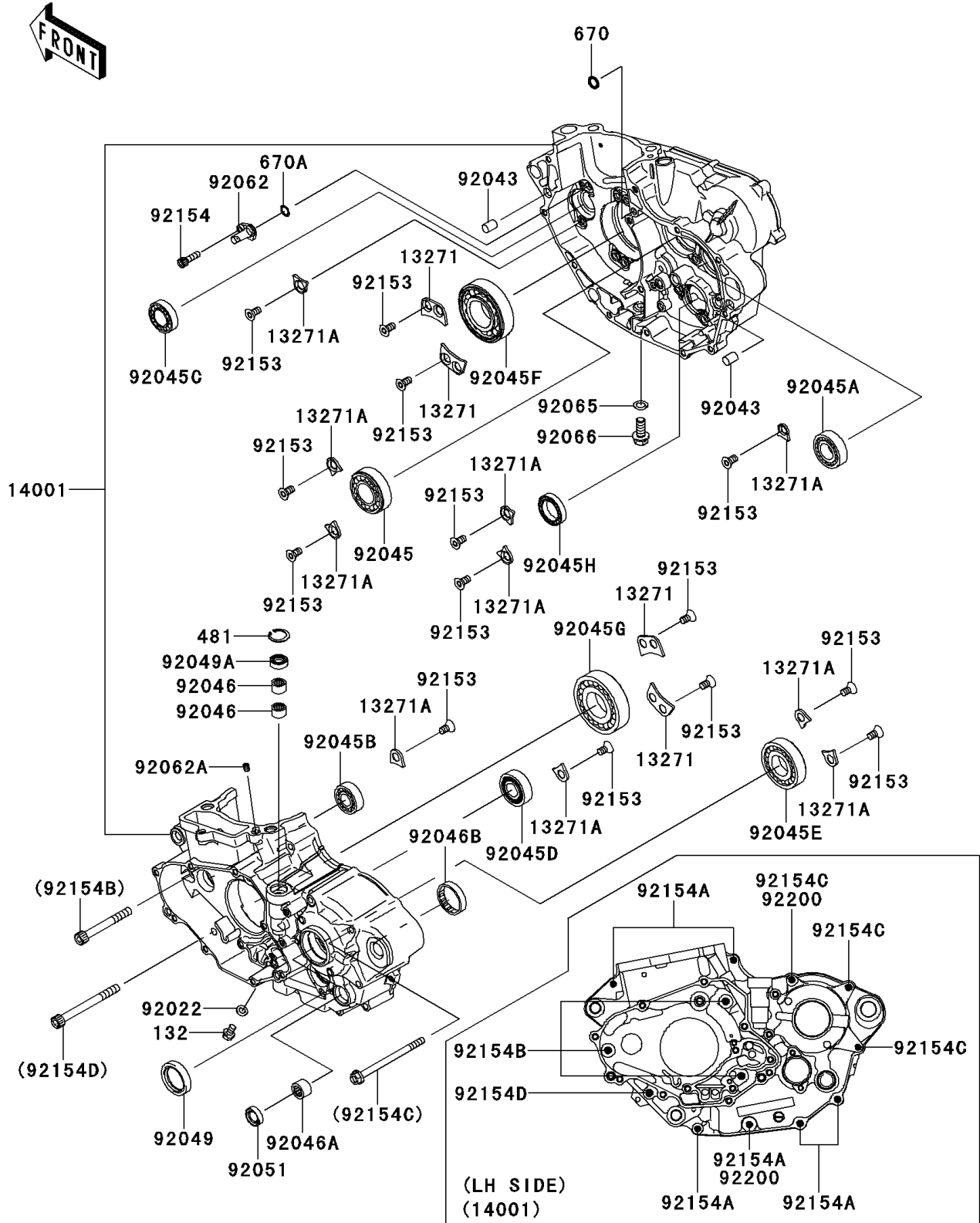

2012 KX™ 450F PARTS LIST

Crankcase

ITEM NAME	PART NUMBER	QUANTITY
BOLT-FLANGED-SMALL,6X8 (Ref # 132)	132BA0608	1
CIRCLIP (Ref # 481)	481J2100	1
O RING,7MM (Ref # 670)	670D1507	1
O RING,8MM (Ref # 670A)	670D1508	1
PLATE (Ref # 13271)	13271-0334	4
PLATE (Ref # 13271A)	13271-0345	10
SET-CRANKCASE (Ref # 14001)	14001-0162	1
WASHER,6.2X11X1 (Ref # 92022)	92022-304	1
PIN,10X14 (Ref # 92043)	92043-1506	2
BEARING-BALL,25X52X15 (Ref # 92045)	92045-0035	1
BEARING-BALL,20X42X12 (Ref # 92045A)	92045-0036	1
BEARING-BALL,6202SH2C3 (Ref # 92045B)	92045-0037	1
BEARING-BALL,6904C3UR5 (Ref # 92045C)	92045-0038	1
BEARING-BALL,3TM-5X0391LUC3 (Ref # 92045D)	92045-0057	1
BEARING-BALL (Ref # 92045E)	92045-0062	1
BEARING-BALL,B32-32-A-ZEC4 (Ref # 92045F)	92045-0074	1
BEARING-BALL (Ref # 92045G)	92045-0132	1
BEARING-BALL,6805JRZ (Ref # 92045H)	92045-1432	1
BEARING-NEEDLE,HK1210FM (Ref # 92046)	92046-0034	2
BEARING-NEEDLE,HK1312 (Ref # 92046A)	92046-1148	1
BEARING-NEEDLE,7E-HKS33X38X8 (Ref # 92046B)	92046-1221	1
SEAL-OIL,TC 30 40 7 (Ref # 92049)	92049-0030	1
SEAL-OIL,CLUTCH RELEASE (Ref # 92049A)	92049-1475	1
SEAL-OIL,TB13225.5 (Ref # 92051)	92051-005	1
NOZZLE (Ref # 92062)	92062-0017	1
NOZZLE,6X8,SILVER (Ref # 92062A)	92062-1081	1
GASKET,10.5X16X1 (Ref # 92065)	92065-058	1
PLUG,DRAIN,10X22 (Ref # 92066)	92066-0038	1
BOLT,TORX,6X8.7 (Ref # 92153)	92153-1669	18

2012 KX™ 450F PARTS LIST

Crankcase

ITEM NAME	PART NUMBER	QUANTITY
BOLT,SOCKET,5X18 (Ref # 92154)	92154-0038	1
BOLT,FLANGED,6X50 (Ref # 92154A)	92154-0526	6
BOLT,SOCKET,7X60 (Ref # 92154B)	92154-0527	3
BOLT,FLANGED,6X85 (Ref # 92154C)	92154-0528	3
BOLT,SOCKET,7X75 (Ref # 92154D)	92154-0529	1
WASHER,6.3X13.5X1.0 (Ref # 92200)	92200-0171	2